

AZOL GAS

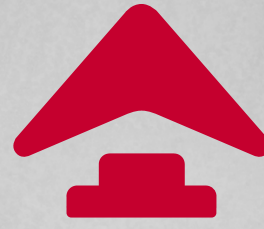

Service in Motion



2020

EASY & READY
MANIFOLD



EASY & READY MANIFOLD

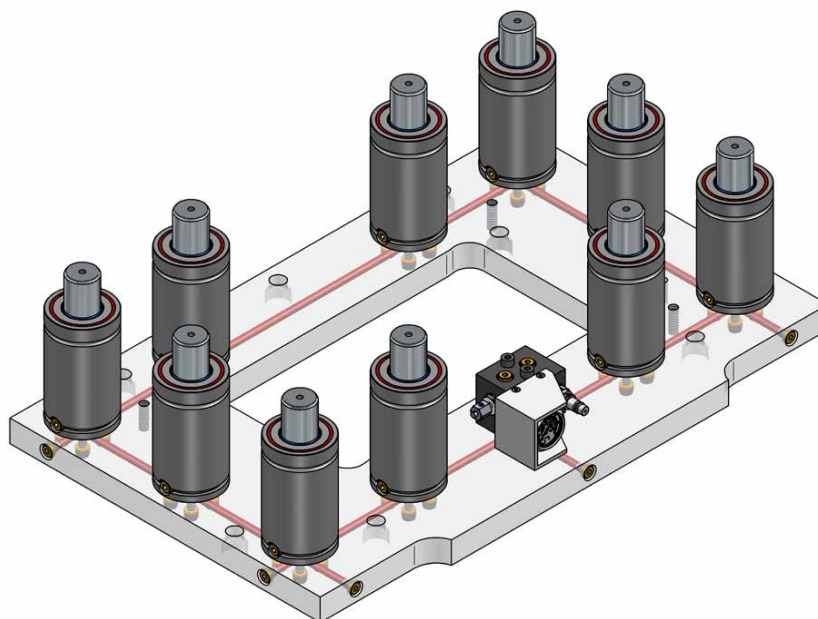

TECHNICAL DATA

- All benefits of self-contained gas springs into a linked system.
- Gas springs mounted to a customer specified plate.
- Valveless gas springs fixed by screws on a low thickness plate.
- Bottom port gas springs attached to the plate with sealing washers.
- Connecting holes are drilled within the plate (uniform pressure).
- Filling, draining and monitoring from control panel.

ADVANTAGES

- Conforms VW 39D 22100 Standards.
- Cost effective alternative to manifold.
- More compact: higher force in less space.
- More simple: hose-free die design.
- Easier installation and maintenance.
- Quicker delivery.
- Possibility to keep consistent force and reduce pressure increase.
- Leak-free tested and ready to be installed.

EASY & READY MANIFOLD



-ER MANIFOLD PLATE TECHNICAL DATA

Pressure Medium:	N2
Min charging pressure:	20 bar / 290 psi
Max charging pressure:	150 bar / 2175 psi
Operating temperature:	0 - 80 °C / 32 - 176 °F
Plate thickness:	Min. 25 mm / 0,98"
Plate wall thickness:	Min. 2,5 mm / 0,098"
Plate fasteners:	Metric High grade bolts
Plate edges:	Burned out
Plate drilled holes:	5 mm / 8 mm

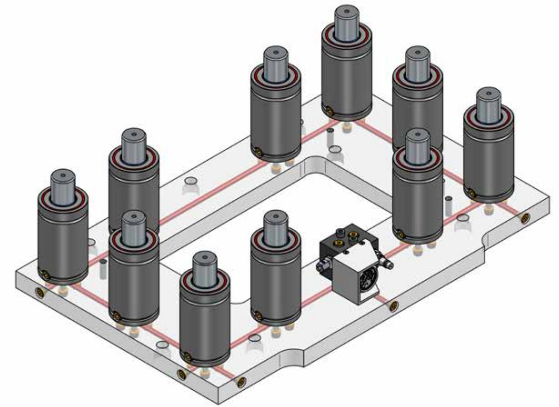

When quoting -ER manifold plate, please provide with CAD files and detailed plate information.

HOLE PATTERN

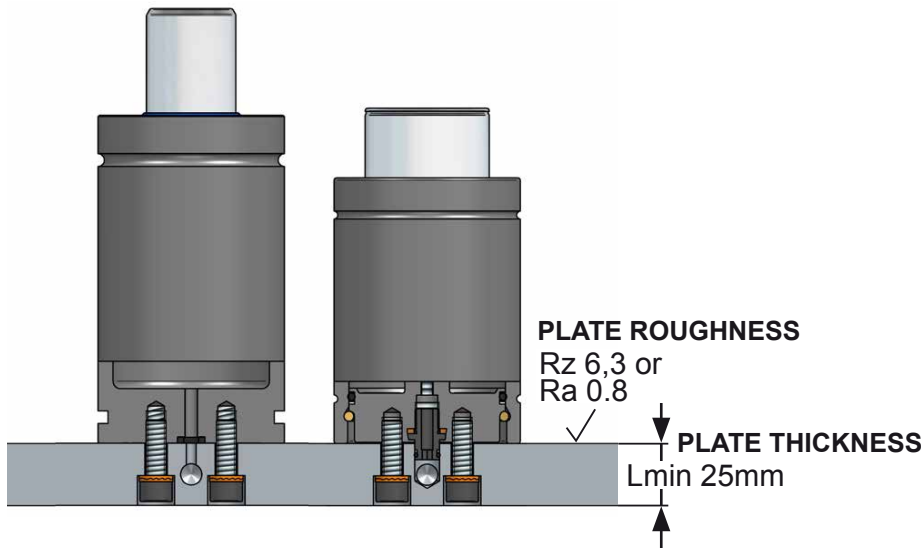
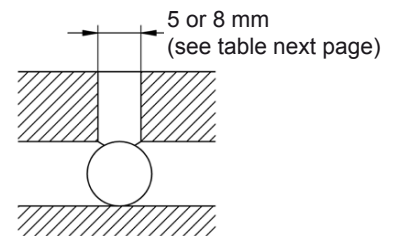
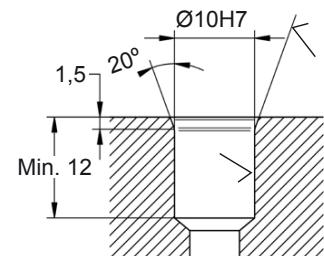

PLATE HOLE PATTERN



ADAPTER HOLE TYPE



SEALING PLUG PATTERN

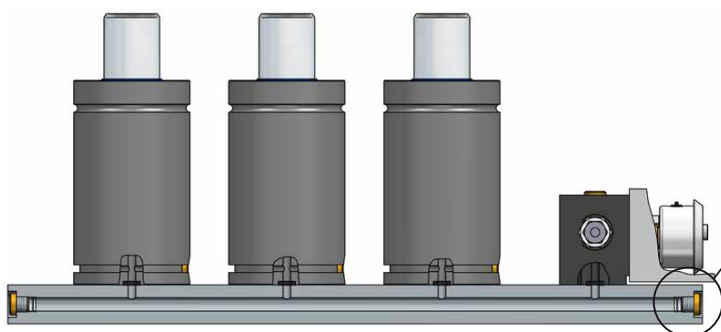

SEALING PLUG

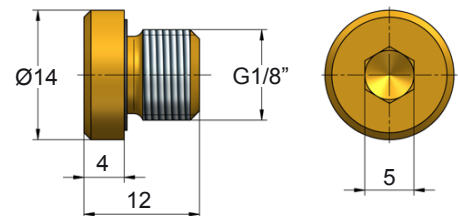

SEALING PLUG HOLE

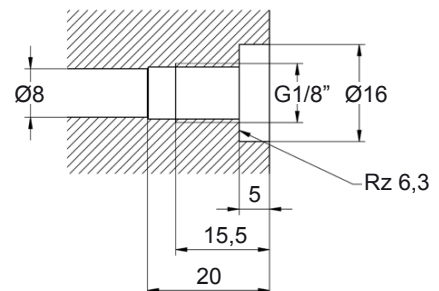



EASY & READY MANIFOLD

-ER GAS SPRINGS

MODEL	THREAD	Ø HOLE	SEAL / ADAPTER	TORQUE (Nm)
AG-ER 1500	M8	8	J-ER-9	38
AG-ER 3000	M8	8	J-ER-9	38
AG-ER 5000	M10	8	J-ER-9	75
AG-ER 7500	M10	8	J-ER-9	75
AG-ER 10000	M12	8	J-ER-9	128
CD-ER 1500 V2	M8	5	J-ER-6	38
CD-ER 2400	M8	8	J-ER-9	38
CD-ER 4200	M8	8	J-ER-9	38
CD-ER 6600	M10	8	J-ER-9	75
CD-ER 9600	M10	8	J-ER-9	75
CD-ER 18500	M12	8	J-ER-9	128
KZ-ER 1500	M8	5	J-ER-6	38
KZ-ER 2400	M8	8	J-ER-9	38
KZ-ER 4200	M8	8	J-ER-9	38
KZ-ER 6600	M10	8	J-ER-9	75

MODEL	THREAD	Ø HOLE	SEAL / ADAPTER	TORQUE (Nm)
CW-ER 1500 V1	M8	5	J-ER-6	38
CW-ER 2400 V1	M8	8	J-ER-9	38
CW-ER 4200 V1	M8	8	J-ER-9	38
CW-ER 6600	M10	8	J-ER-9	75
CW-ER 9500	M10	8	J-ER-9	75
CW-ER 11800	M10	8	J-ER-9	75
CW-ER 20000	M12	8	J-ER-9	128
CS-ER 1800 V2	M6	10	T-ER	15
CS-ER 3000 V3	M8	10	T-ER	38
CS-ER 4700 V1	M8	10	T-ER	38
CS-ER 7500 V1	M8	10	T-ER	38
CS-ER 11800 V1	M10	10	T-ER	75
CS-ER 18300 V1	M10	10	T-ER	75

Recommended gas springs to be used in ER manifold plates, other gas springs under request.
-ER gas springs are supplied with the corresponding seal J-ER / adapter T-ER

-ER GAS SPRINGS SEALING AND MOUNTING

SEAL TYPE

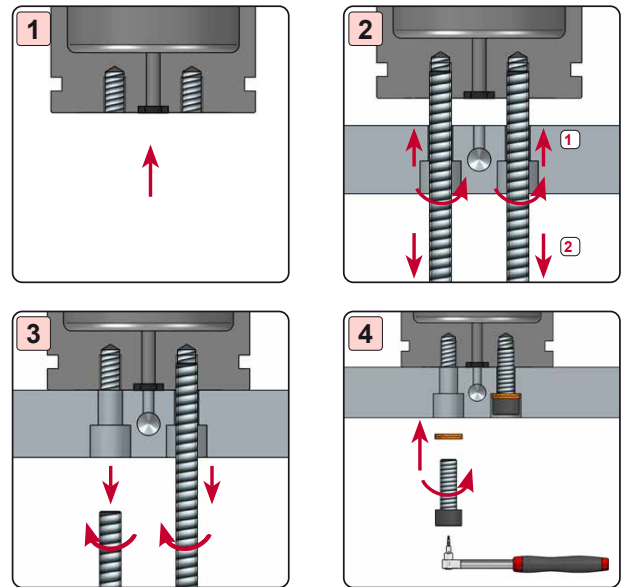
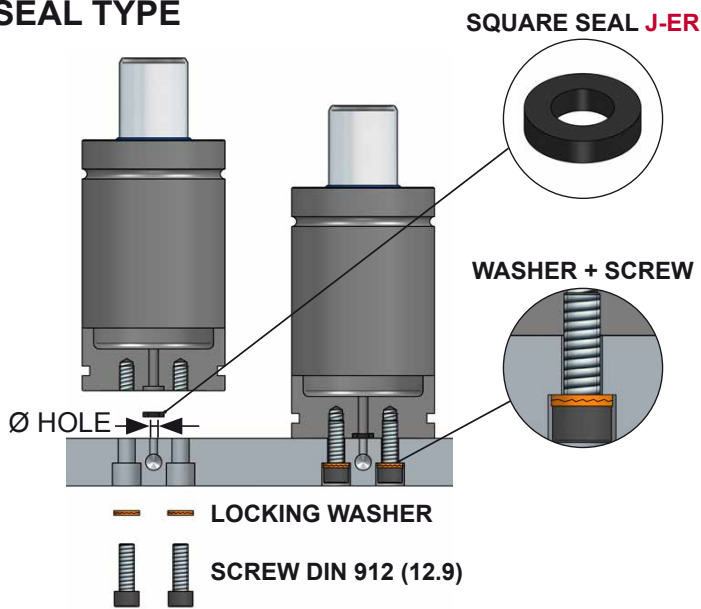

ADAPTER TYPE

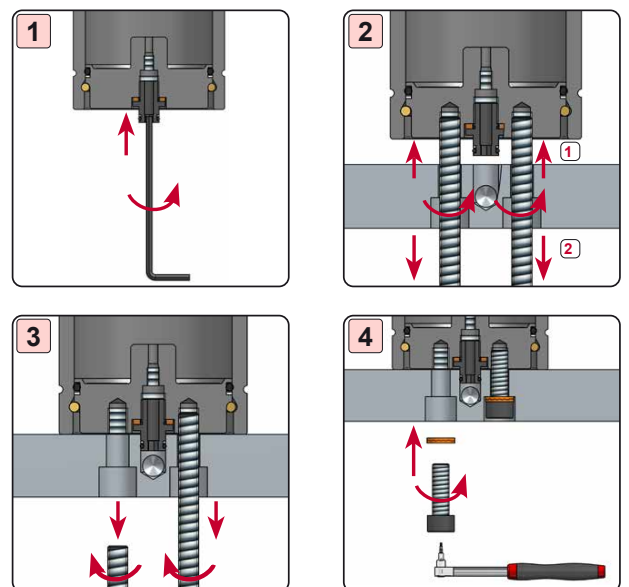
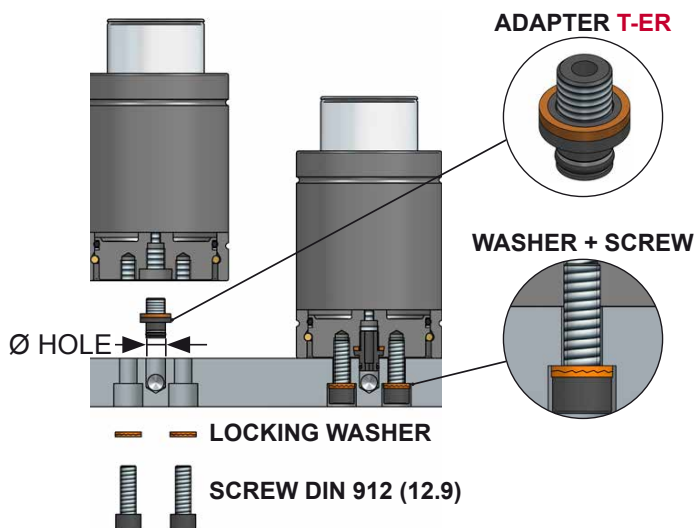

EASY & READY MANIFOLD



• Avoid blind holes

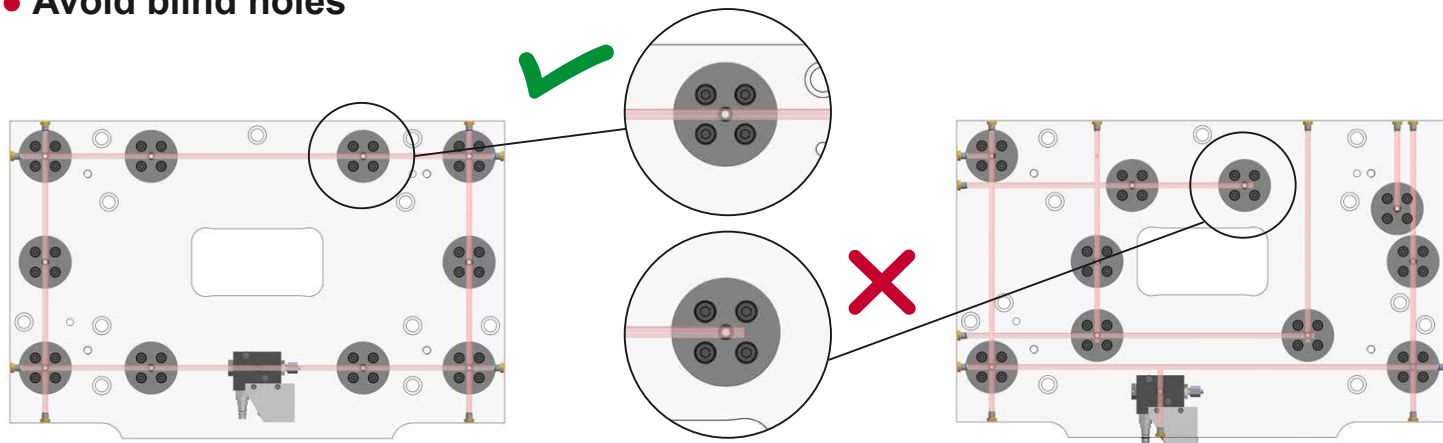

• Align gas springs as much as possible

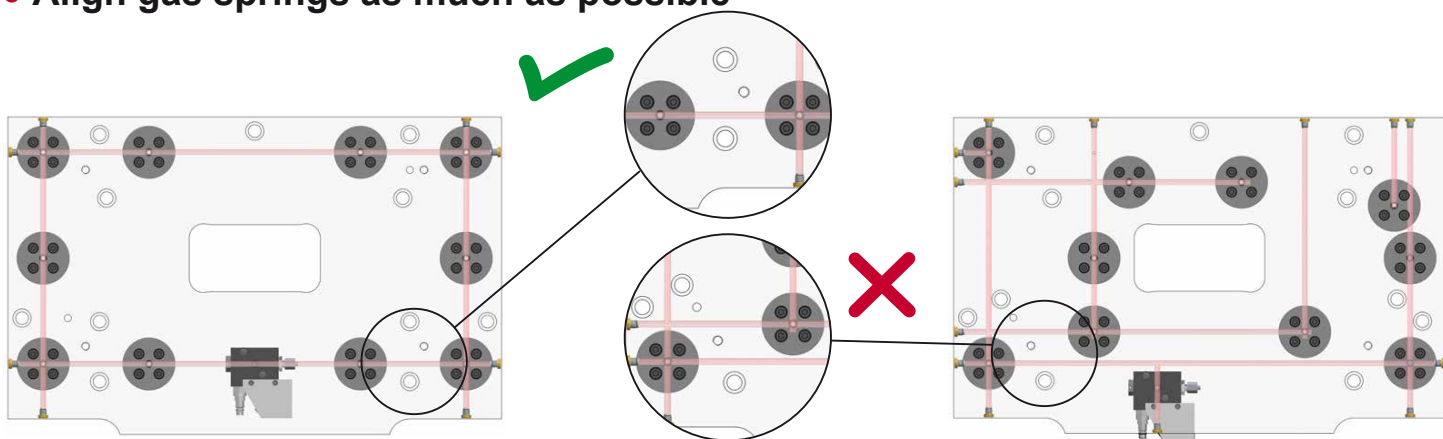

• Use existing port to mount control panel

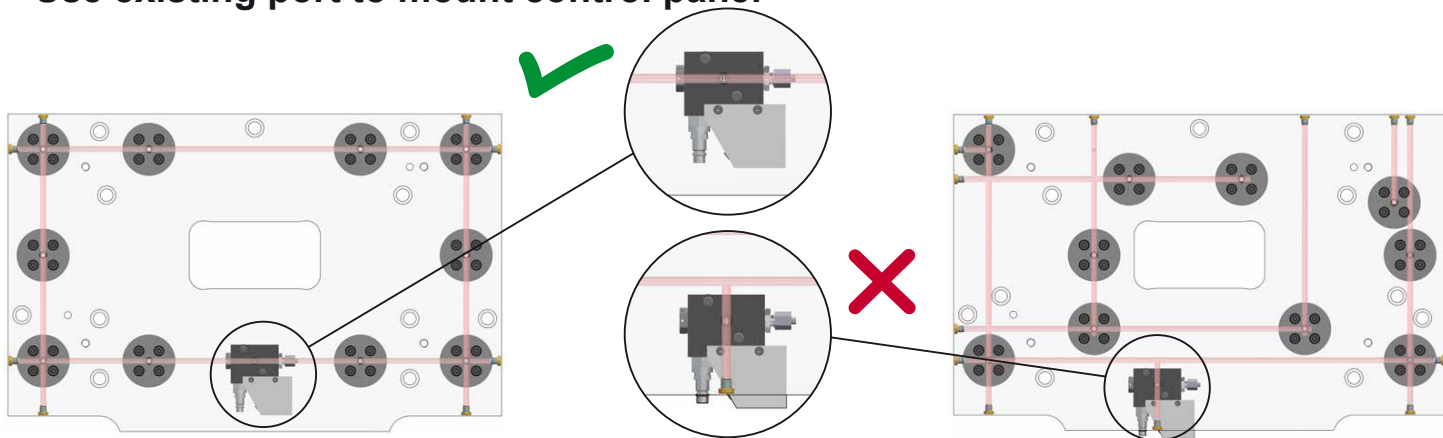

• Avoid interference between cylinder fixing holes and gas ports

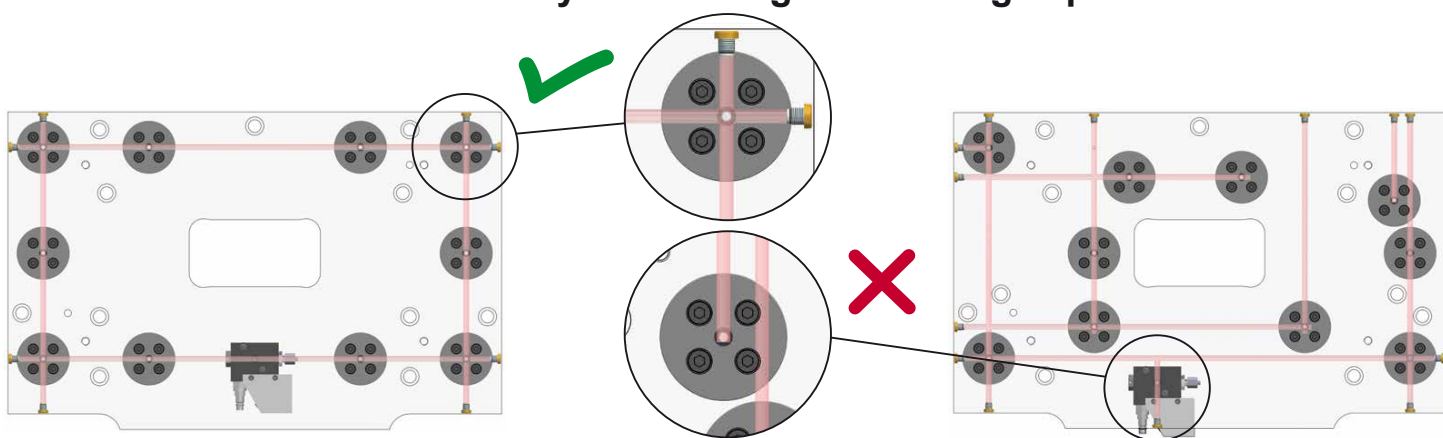



EASY & READY MANIFOLD

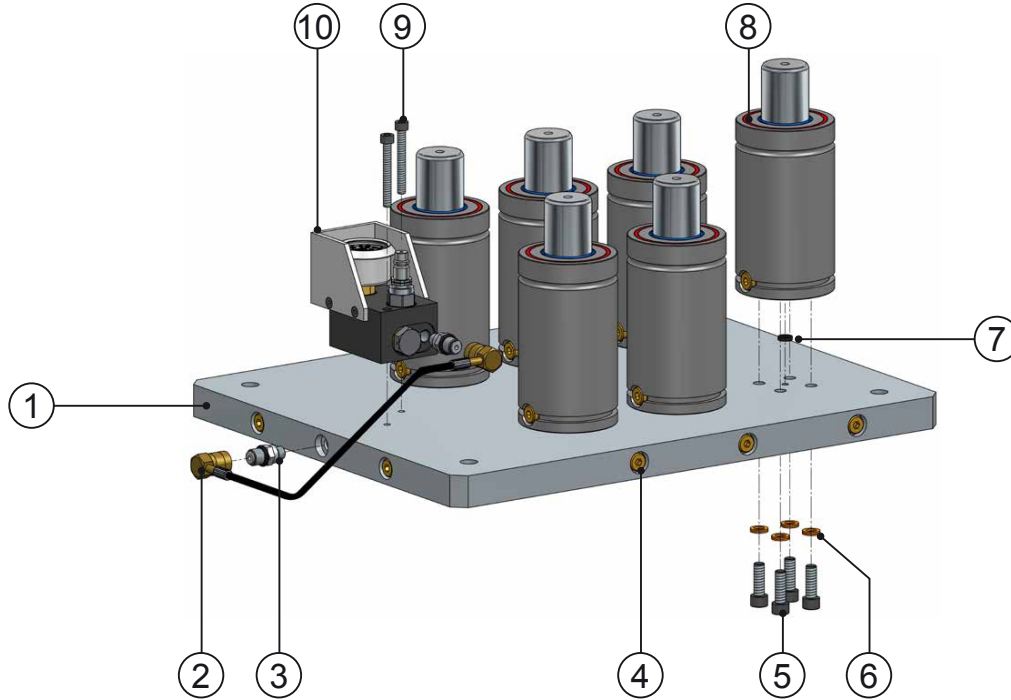

Nº	Description	Code
1	Manifold Plate	-----
2	Hose N ₂	PGP XXXX
3	Hose Adapter	SKK 12R 1/8
4	Sealing Plug	T 1/8
5	Screw DIN 912 (12.9)	-----

Nº	Description	Code
6	Locking Washer	-----
7	Square Seal	J-ER-6 - J-ER-9
8	Gas Spring	AG-ER - CD-ER - KZ-ER - CW-ER
9	Screw DIN 912 (12.9)	-----
10	Control Panel	600-CPGM

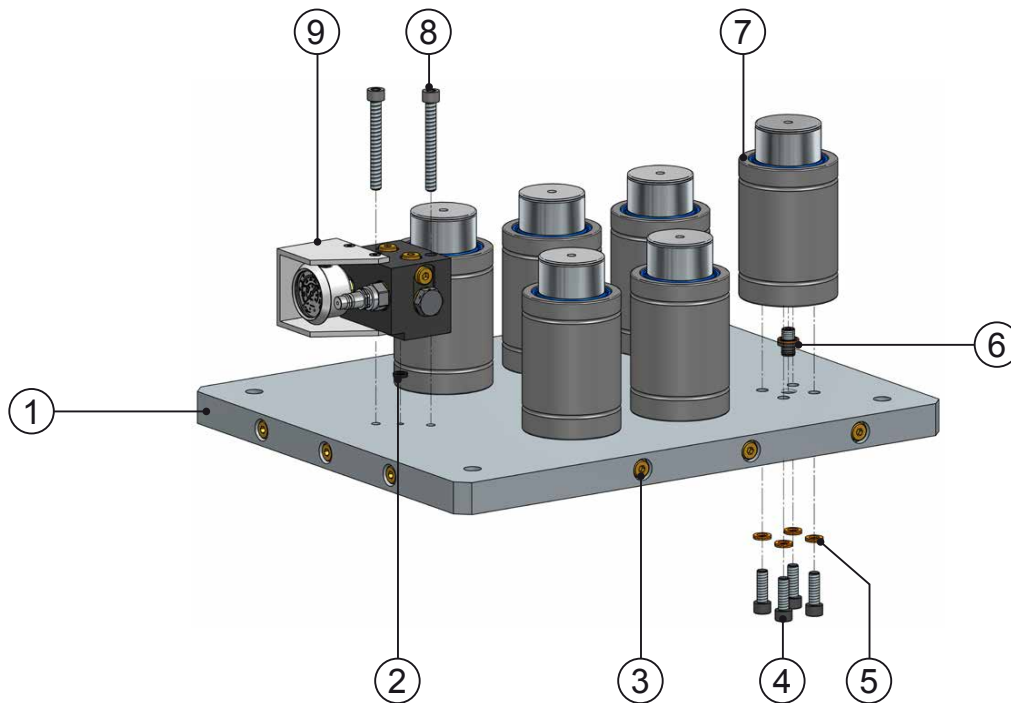

Nº	Description	Code
1	Manifold Plate	-----
2	Square Seal	J-ER-6
3	Sealing Plug	T 1/8
4	Screw DIN 912 (12.9)	-----
5	Locking Washer	-----

Nº	Description	Code
6	Adapter	T-ER
7	Gas Spring	CS-ER
8	Screw DIN 912 (12.9)	-----
9	Control Panel	600-CPGM-ER

AG-ER 1500

150

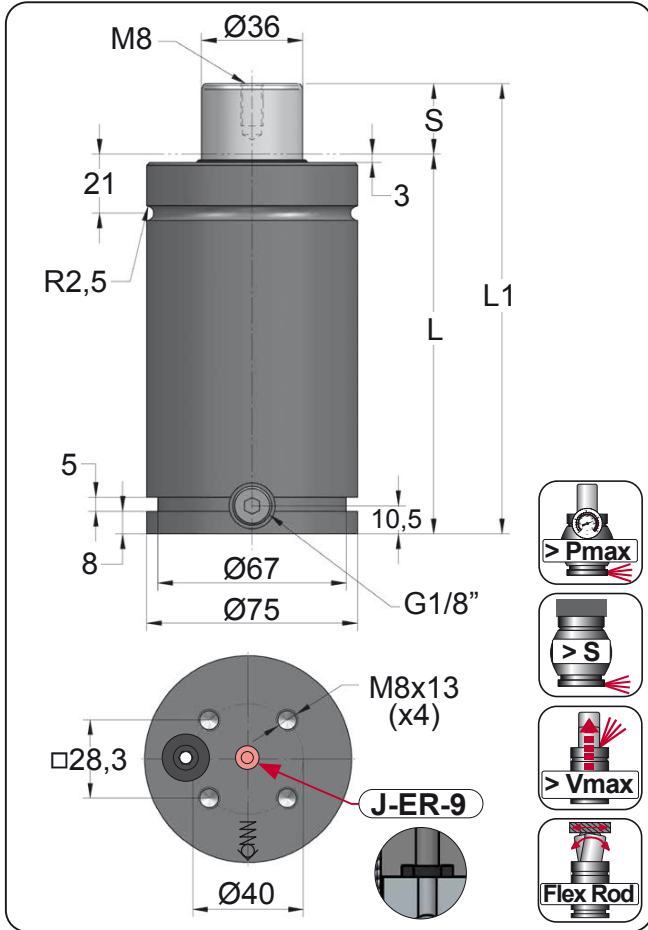

ORDER	S (mm)	L1 ±0.25 (mm)	L (mm)	Kg.
AG-ER 1500 013	13	136	123	2.82
AG-ER 1500 025	25	160	135	2.99
AG-ER 1500 038	38	186	148	3.18
AG-ER 1500 050	50	210	160	3.36
AG-ER 1500 063	63.5	237	173.5	3.56
AG-ER 1500 080	80	270	190	3.80
AG-ER 1500 100	100	310	210	4.09
AG-ER 1500 125	125	360	235	4.46
AG-ER 1500 160	160	430	270	4.97
AG-ER 1500 175	175	460	285	5.19
AG-ER 1500 200	200	510	310	5.56
AG-ER 1500 225	225	560	335	5.92
AG-ER 1500 250	250	610	360	6.29
AG-ER 1500 300	300	710	410	7.02

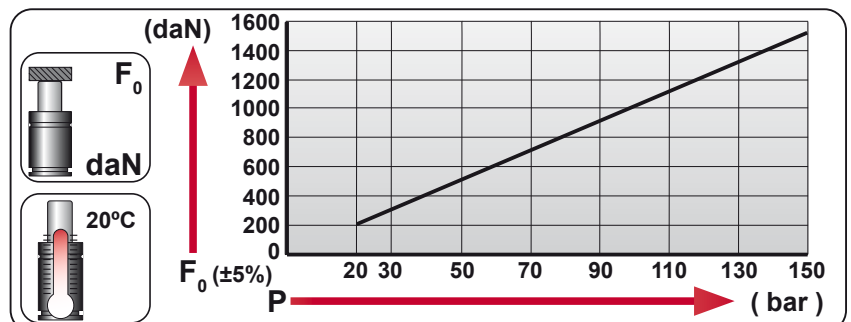

CODE	Pressure Gauge	Pressure	Force F ₀	Force F ₁	
		bar	psi	daN	daN
AG 1500 050		150	2175	1530	1880
AG-ER 1500 050		0	0	---	---

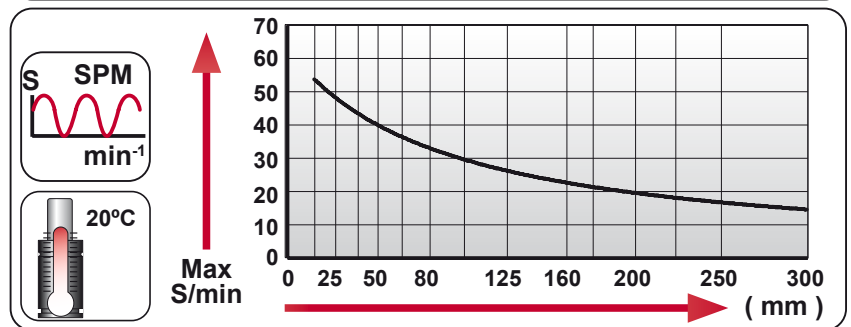
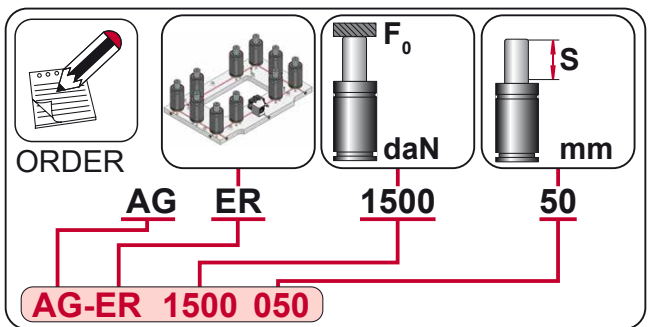
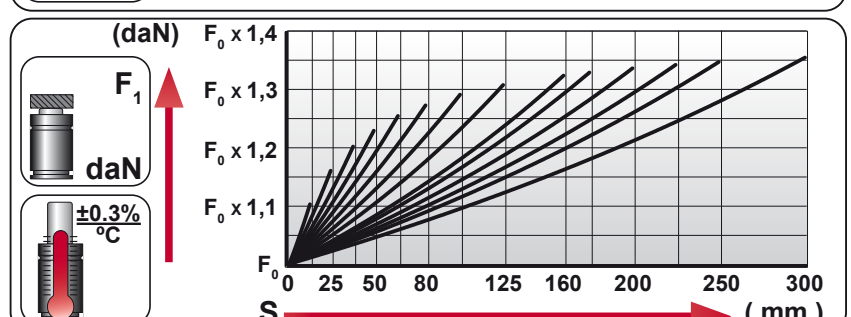

N ₂	S _{max} < 90%	V _{max} 2 m/s	bar psi 20 290	bar psi 150 2175	°C °F 0 32
				°C °F 80 176	600 CP_ _-ER

AZOL GAS AG-ER 3000

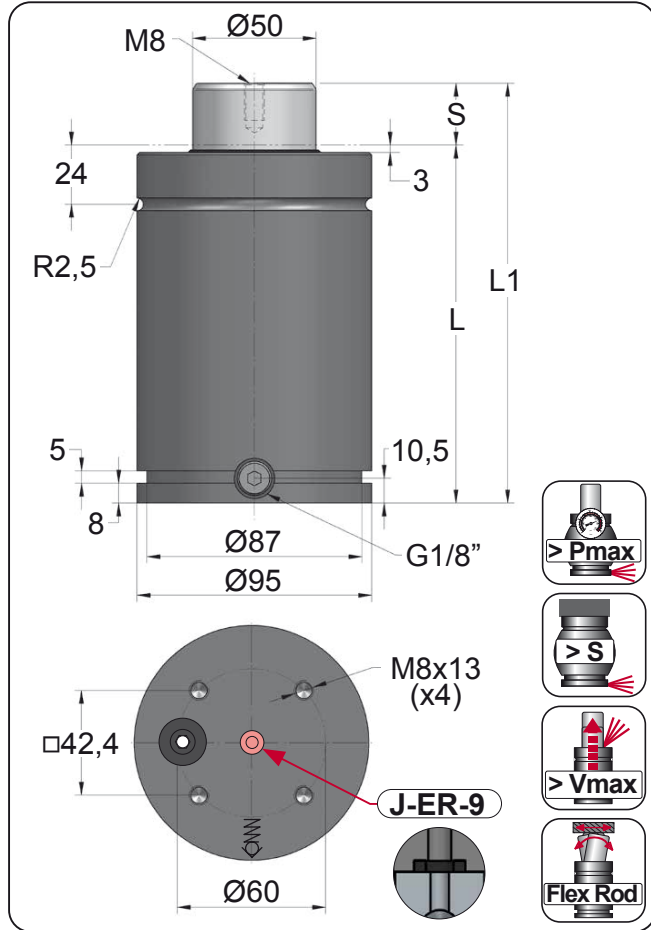

ORDER	S (mm)	L1 ±0.25 (mm)	L (mm)	Kg.
AG-ER 3000 025	25	170	145	5.14
AG-ER 3000 038	38	196	158	5.48
AG-ER 3000 050	50	220	170	5.80
AG-ER 3000 063	63.5	247	183.5	6.15
AG-ER 3000 080	80	280	200	6.58
AG-ER 3000 100	100	320	220	7.10
AG-ER 3000 125	125	370	245	7.75
AG-ER 3000 160	160	440	280	8.66
AG-ER 3000 175	175	470	295	9.05
AG-ER 3000 200	200	520	320	9.70
AG-ER 3000 225	225	570	345	10.35
AG-ER 3000 250	250	620	370	11.00
AG-ER 3000 300	300	720	420	12.31

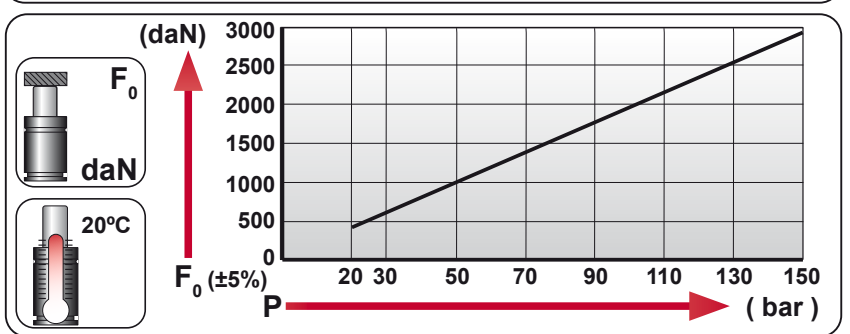

CODE	Pressure Gauge	Pressure	Force (F0)	Force (F1)	
		bar	psi	daN	daN
AG 3000 050		150	2175	2945	3695
AG-ER 3000 050		0	0	---	---

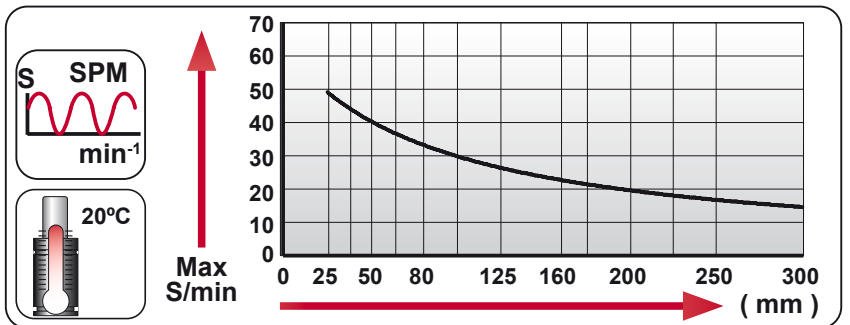
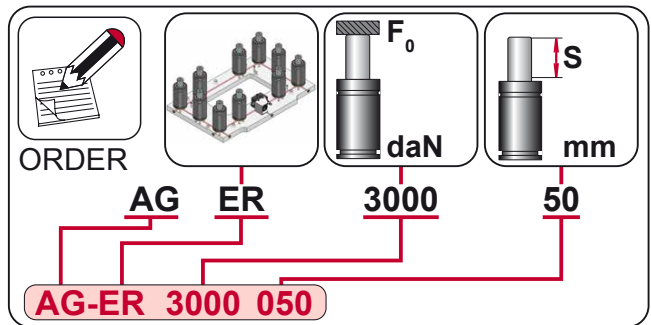
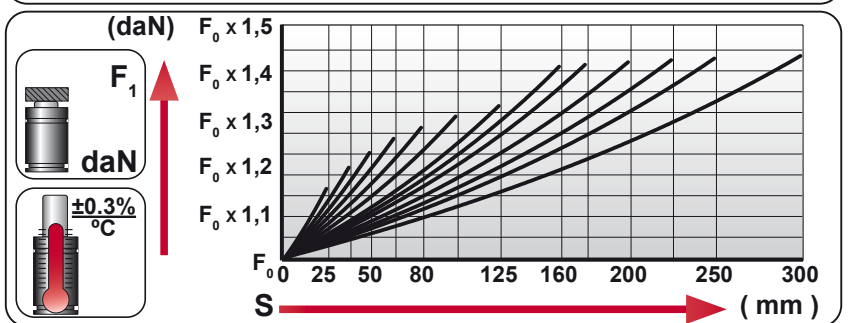

N ₂	Smax < 90%	Vmax 2 m/s	bar psi 20 290	bar psi 150 2175	°C °F 0 32	°C °F 80 176	600 CP_ _-ER

AG-ER 5000

150

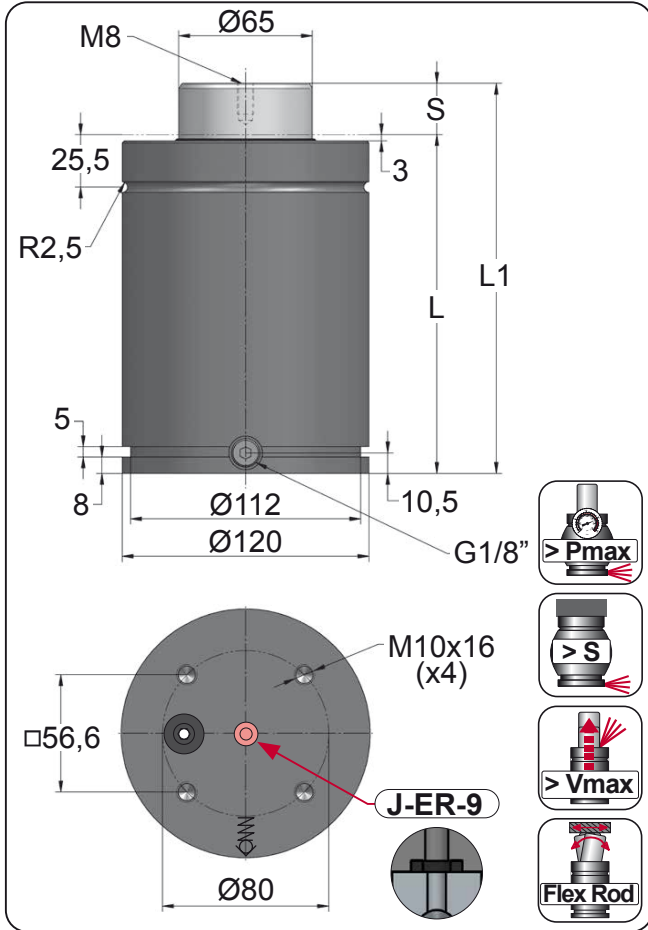

ORDER	S (mm)	L1 ±0.25 (mm)	L (mm)	Kg.
AG-ER 5000 025	25	190	165	9.78
AG-ER 5000 038	38	216	178	10.31
AG-ER 5000 050	50	240	190	10.80
AG-ER 5000 063	63.5	267	203.5	11.35
AG-ER 5000 080	80	300	220	12.02
AG-ER 5000 100	100	340	240	12.83
AG-ER 5000 125	125	390	265	13.85
AG-ER 5000 160	160	460	300	15.27
AG-ER 5000 175	175	490	315	15.88
AG-ER 5000 200	200	540	340	16.90
AG-ER 5000 225	225	590	365	17.92
AG-ER 5000 250	250	640	390	18.93
AG-ER 5000 300	300	740	440	20.97

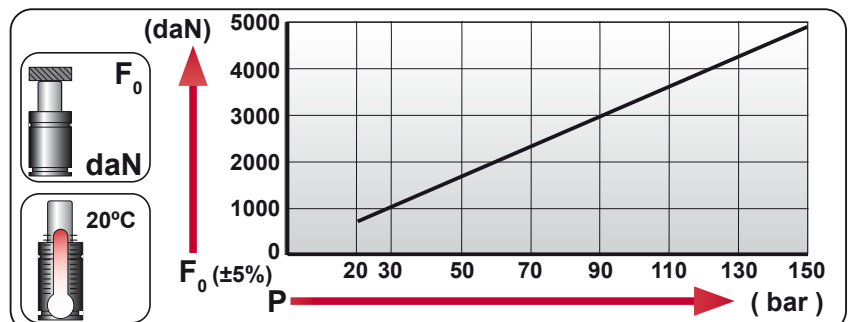

CODE	Pressure	Force (daN)	Force (daN)
AG 5000 050	150 bar / 2175 psi	4980 daN	6260 daN
AG-ER 5000 050	0 bar / 0 psi	---	---

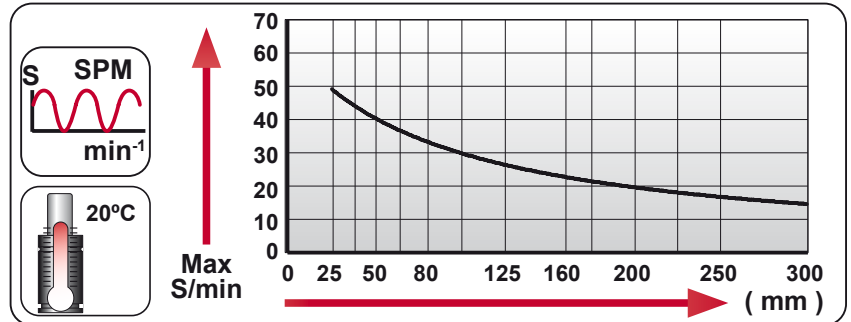
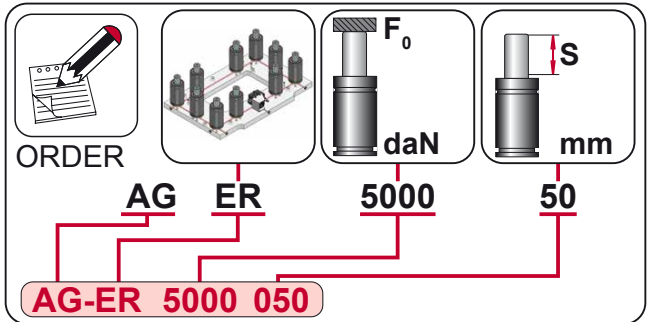
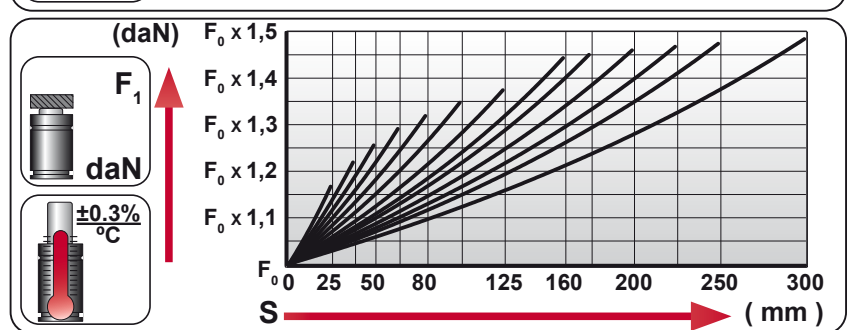

N ₂	Smax < 90%	Vmax 2 m/s	bar psi 20 290	bar psi 150 2175	°C °F 0 32	°C °F 80 176	600 CP_ _-ER

AZOL GAS AG-ER 7500

150

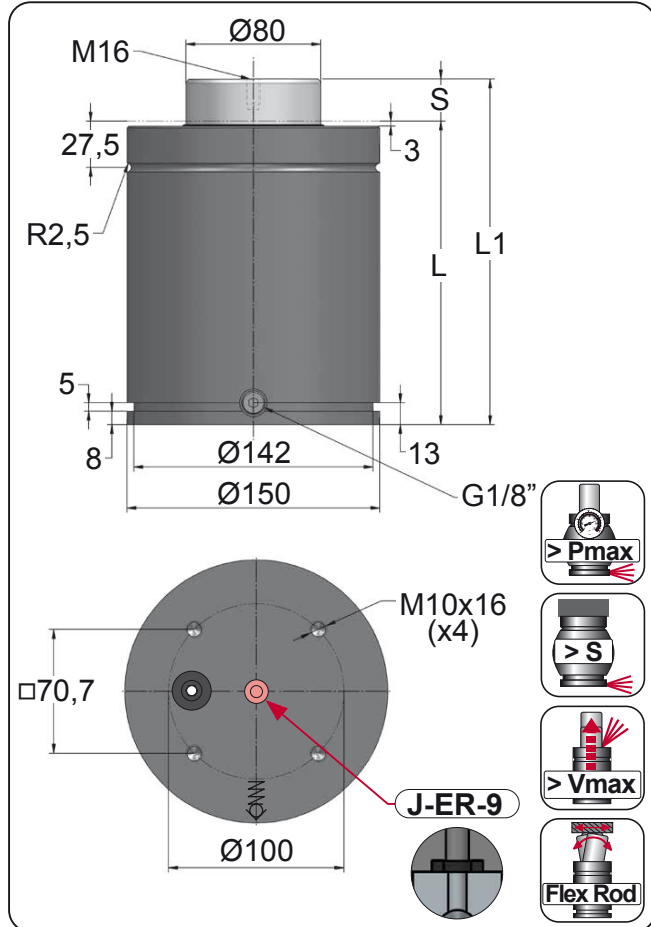

ORDER	S (mm)	L1 ±0.25 (mm)	L (mm)	Kg.
AG-ER 7500 025	25	205	180	16.89
AG-ER 7500 038	38	231	193	17.71
AG-ER 7500 050	50	255	205	18.47
AG-ER 7500 063	63.5	282	218.5	19.33
AG-ER 7500 080	80	315	235	20.37
AG-ER 7500 100	100	355	255	21.63
AG-ER 7500 125	125	405	280	23.21
AG-ER 7500 160	160	475	315	25.42
AG-ER 7500 175	175	505	330	26.37
AG-ER 7500 200	200	555	355	27.95
AG-ER 7500 225	225	605	380	29.53
AG-ER 7500 250	250	655	405	31.11
AG-ER 7500 300	300	755	455	34.27

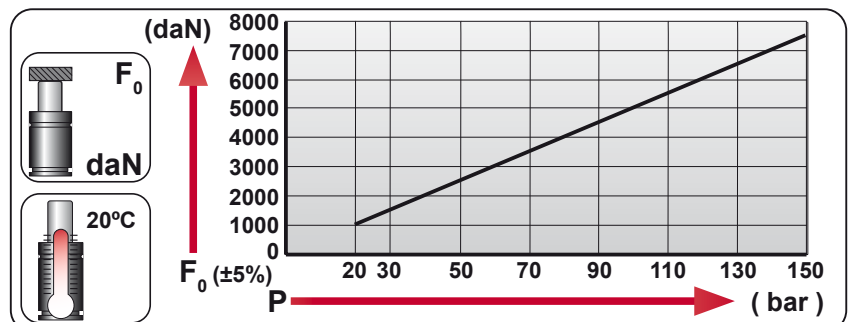

CODE	Pressure (bar)	Pressure (psi)	Force (daN)	Force (daN)
AG 7500 050	150	2175	7540	9370
AG-ER 7500 050	0	0	---	---

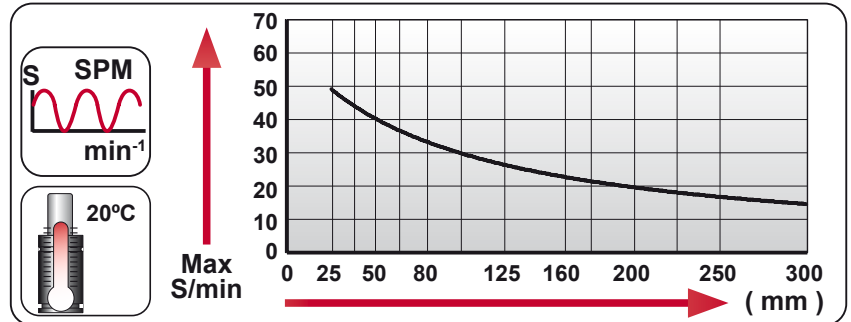
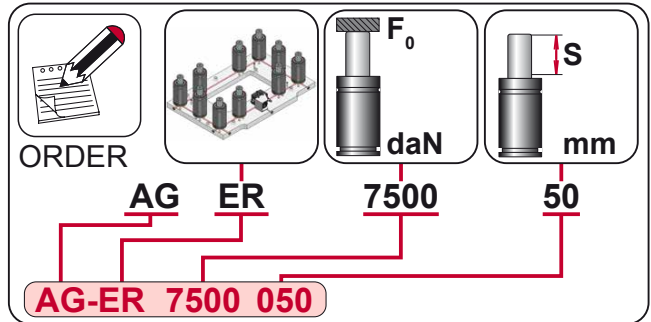
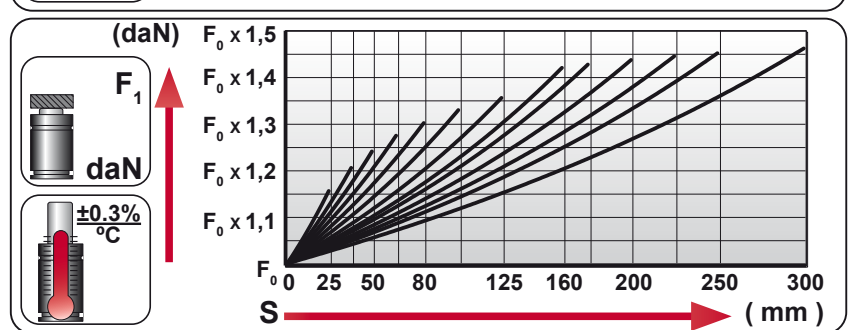

N ₂	Smax < 90%	Vmax 2 m/s	bar psi 20 290	bar psi 150 2175	°C °F 0 32	°C °F 80 176	600 CP_ _-ER

AG-ER 10000

ISO

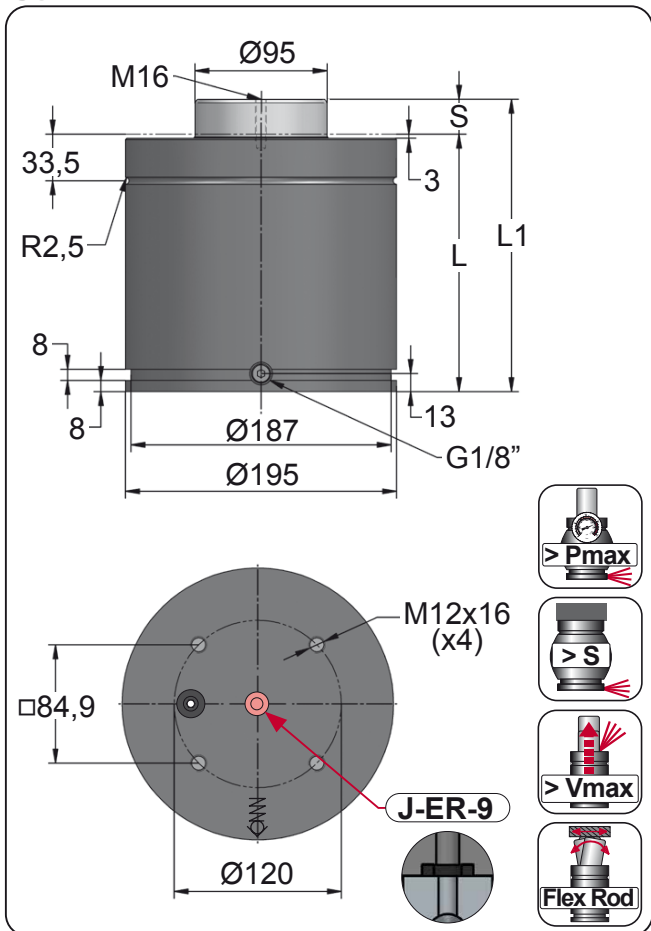

ORDER	S (mm)	L1 ±0.25 (mm)	L (mm)	Kg.
AG-ER 10000 025	25	210	185	31.71
AG-ER 10000 038	38	236	198	33.04
AG-ER 10000 050	50	260	210	34.26
AG-ER 10000 063	63.5	287	223.5	35.64
AG-ER 10000 080	80	320	240	37.32
AG-ER 10000 100	100	360	260	39.36
AG-ER 10000 125	125	410	285	41.91
AG-ER 10000 160	160	480	320	45.48
AG-ER 10000 200	200	560	360	49.57
AG-ER 10000 250	250	660	410	54.67
AG-ER 10000 300	300	760	460	59.77

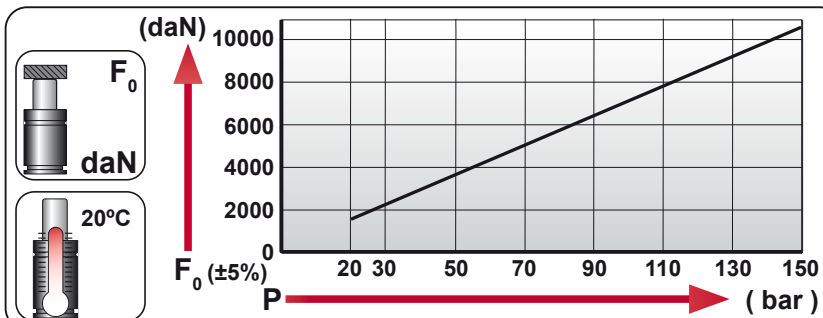

CODE	Pressure Gauge	bar	psi	F ₀ daN	F ₁ daN
AG 10000 050		145	2105	10280	12780
AG-ER 10000 050		0	0	---	---

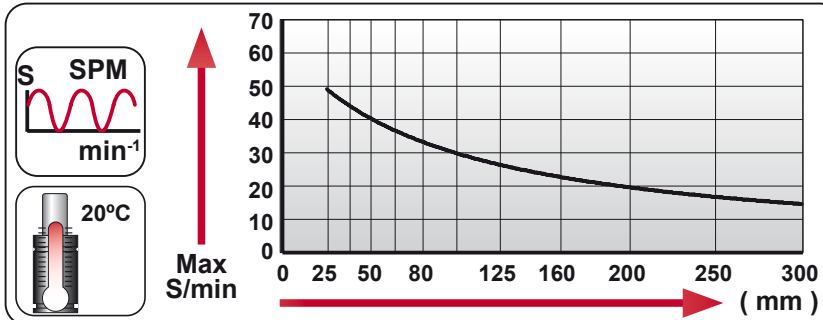
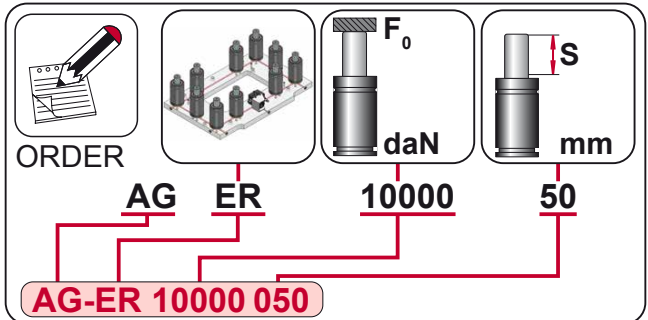
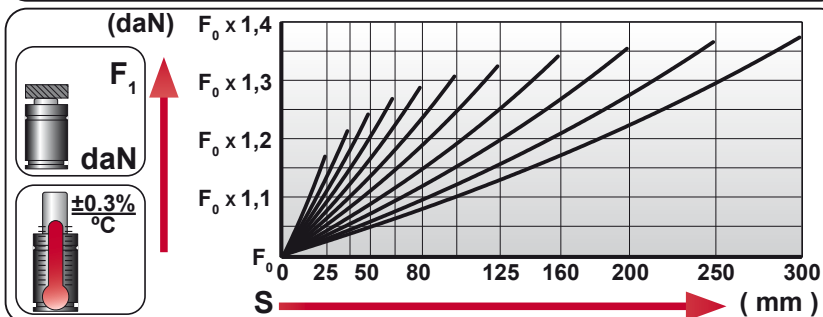

	Smax < 90%	Vmax 2 m/s	Pmin (20°C)	Pmax (20°C)	Tmin	Tmax	
N ₂	Smax < 90%	Vmax 2 m/s	bar psi 20 290	bar psi 150 2175	°C °F 0 32	°C °F 80 176	600 CP_ _-ER



CD-ER 1500 V2

Heavy Duty

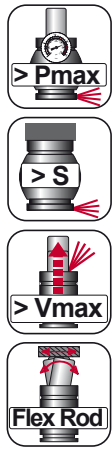
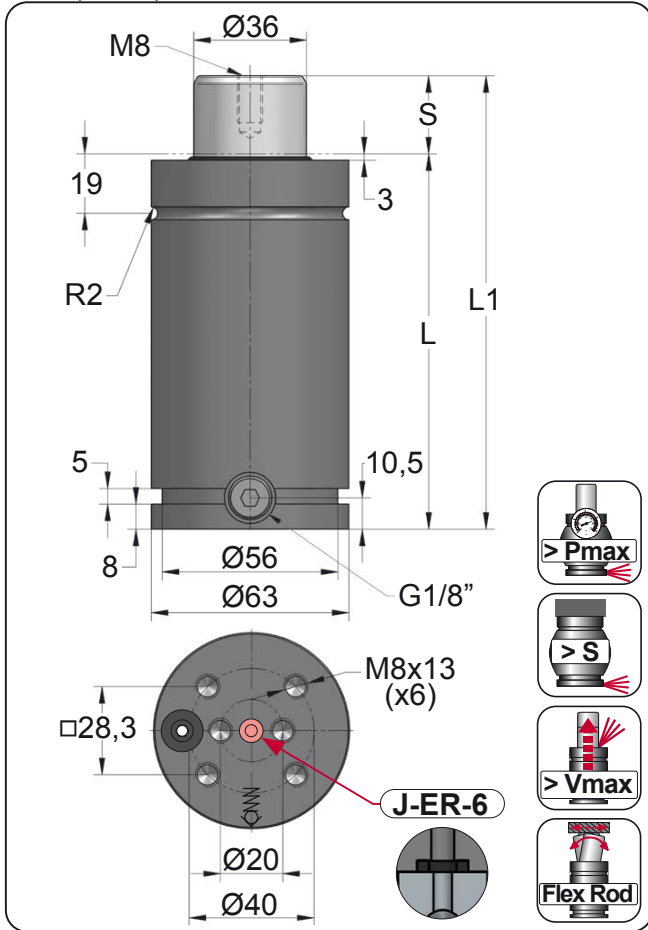

ORDER	S (mm)	L1 ±0.25 (mm)	L (mm)	Kg.
CD-ER 1500 013 V2	13	121	108	2.02
CD-ER 1500 025 V2	25	145	120	2.17
CD-ER 1500 038 V2	38	171	133	2.33
CD-ER 1500 050 V2	50	195	145	2.48
CD-ER 1500 063 V2	63.5	222	158.5	2.64
CD-ER 1500 080 V2	80	255	175	2.84
CD-ER 1500 100 V2	100	295	195	3.09
CD-ER 1500 125 V2	125	345	220	3.39
CD-ER 1500 160 V2	160	415	255	3.82
CD-ER 1500 200 V2	200	495	295	4.31
CD-ER 1500 250 V2	250	595	345	4.92
CD-ER 1500 300 V2	300	695	395	5.54



CODE	Image	Pressure		Force	
		bar	psi	daN	daN
CD 1500 050 V2		150	2175	1530	2300
CD-ER 1500 050 V2		0	0	---	---

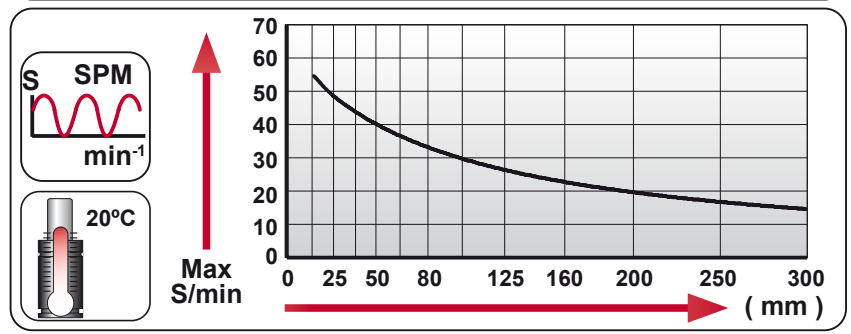
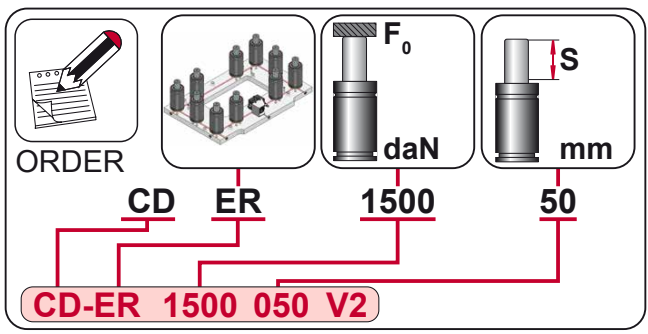
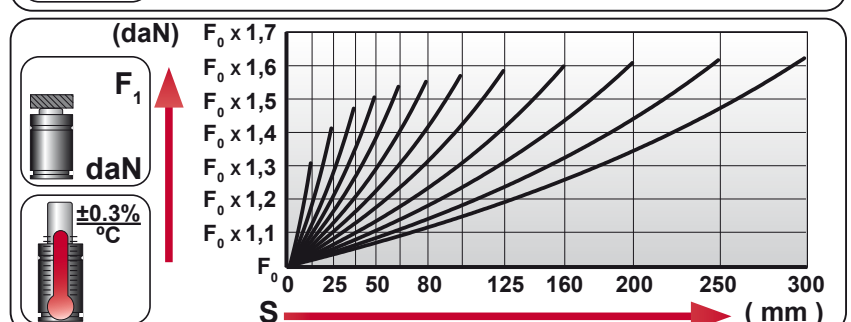
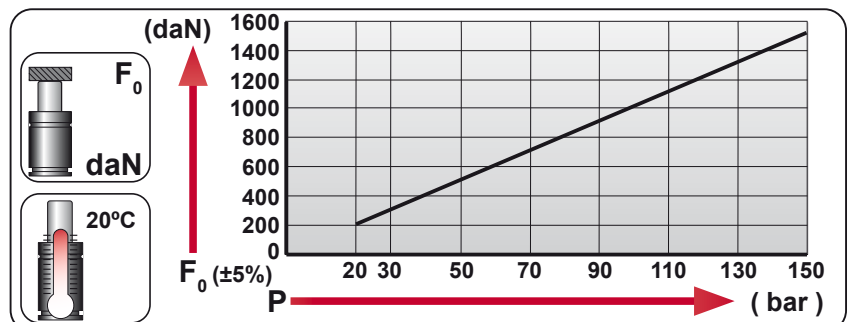

N ₂	Smax < 90%	Vmax 1,6 m/s	bar psi	bar psi	°C °F	°C °F	600 CP_ _-ER
			20 290	150 2175	0 32	80 176	

AZOL GAS **CD-ER 2400**
Heavy Duty

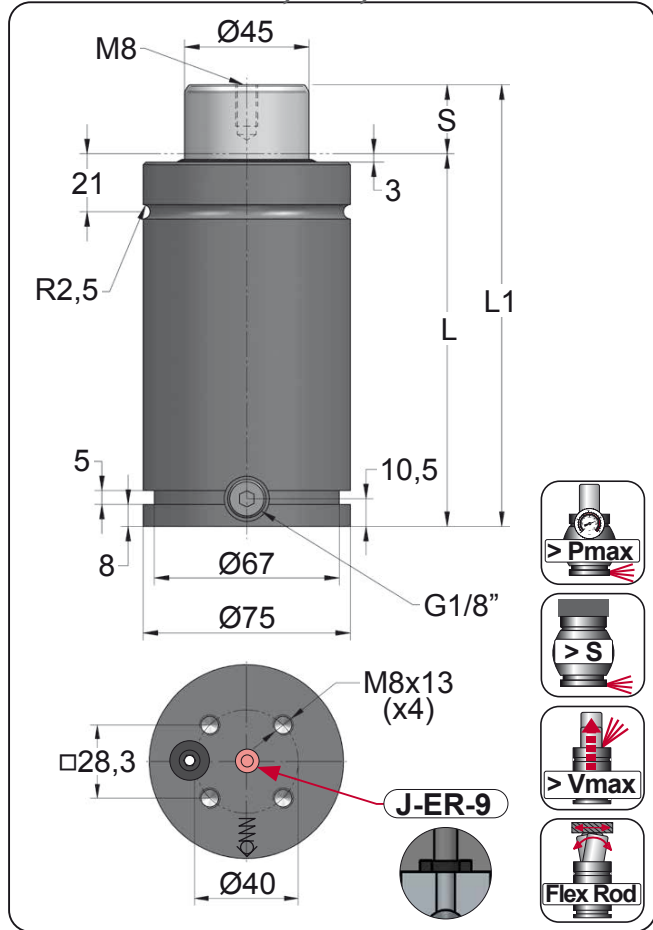

ORDER	S (mm)	L1 ±0.25 (mm)	L (mm)	Kg.
CD-ER 2400 025	25	160	135	3.06
CD-ER 2400 038	38	186	148	3.28
CD-ER 2400 050	50	210	160	3.48
CD-ER 2400 063	63.5	237	173.5	3.72
CD-ER 2400 080	80	270	190	4.00
CD-ER 2400 100	100	310	210	4.34
CD-ER 2400 125	125	360	235	4.77
CD-ER 2400 160	160	430	270	5.37
CD-ER 2400 175	175	460	285	5.63
CD-ER 2400 200	200	510	310	6.06
CD-ER 2400 225	225	560	335	6.48
CD-ER 2400 250	250	610	360	6.91
CD-ER 2400 300	300	710	410	7.77

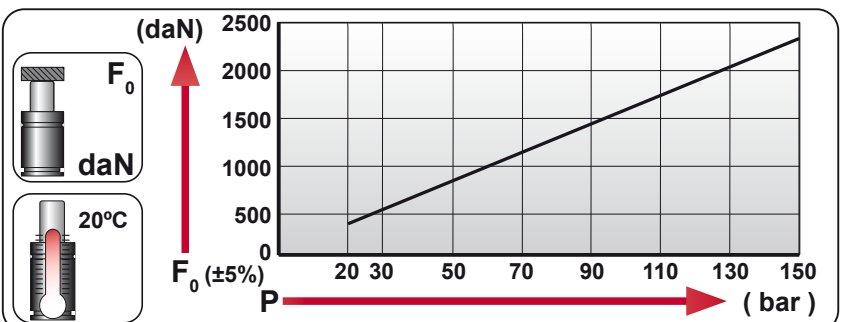

CODE	Pressure	Force (daN)	Force (daN)
CD 2400 050	150 bar / 2175 psi	2385 daN	3565 daN
CD-ER 2400 050	0 bar / 0 psi	---	---

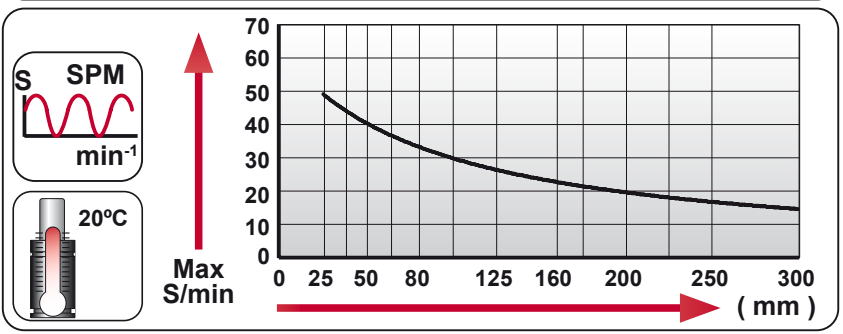
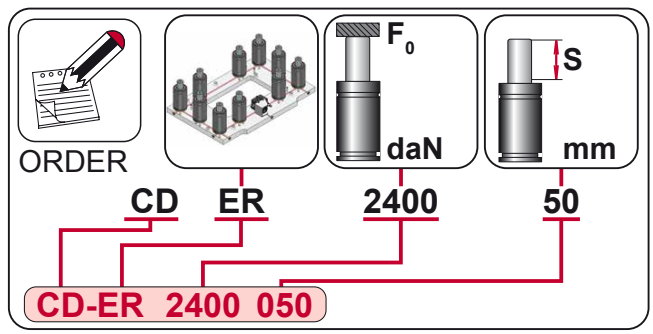
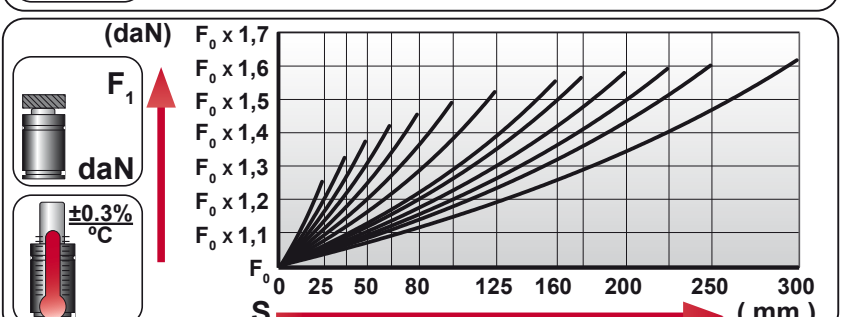

N ₂	Smax < 90%	Vmax 1,6 m/s	bar psi 20 290	bar psi 150 2175	°C °F 0 32	°C °F 80 176	600 CP_ _-ER

CD-ER 4200

Heavy Duty

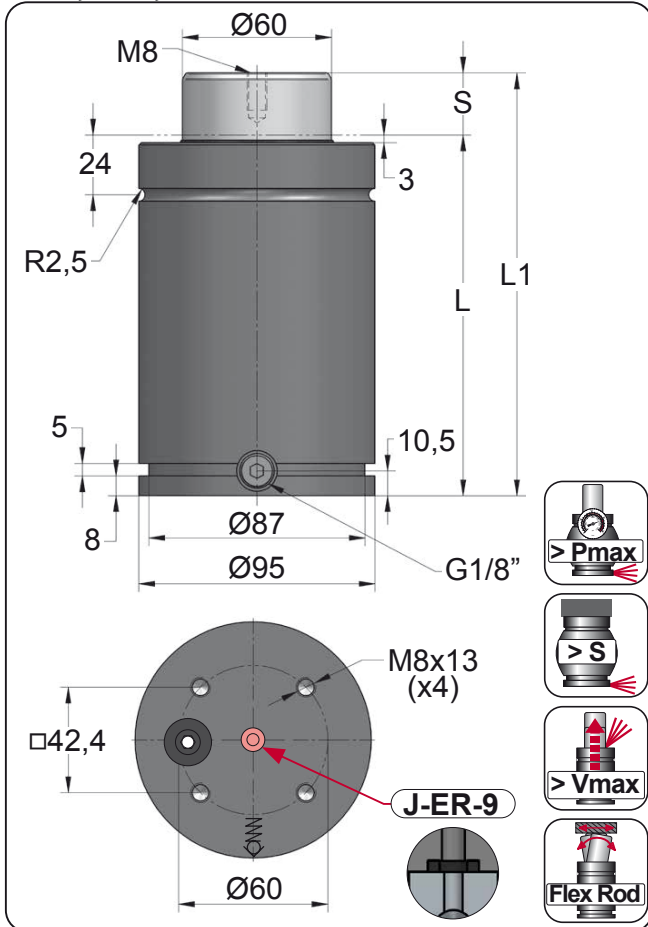

ORDER	S (mm)	L1 ±0.25 (mm)	L (mm)	Kg.
CD-ER 4200 025	25	170	145	5.21
CD-ER 4200 038	38	196	158	5.58
CD-ER 4200 050	50	220	170	5.93
CD-ER 4200 063	63.5	247	183.5	6.31
CD-ER 4200 080	80	280	200	6.78
CD-ER 4200 100	100	320	220	7.35
CD-ER 4200 125	125	370	245	8.06
CD-ER 4200 160	160	440	280	9.06
CD-ER 4200 175	175	470	295	9.49
CD-ER 4200 200	200	520	320	10.20
CD-ER 4200 225	225	570	345	10.92
CD-ER 4200 250	250	620	370	11.63
CD-ER 4200 300	300	720	420	13.05



CODE	Pressure Gauge	bar	psi	F ₀ daN	F ₁ daN
CD 4200 050		150	2175	4240	5805
CD-ER 4200 050		0	0	---	---

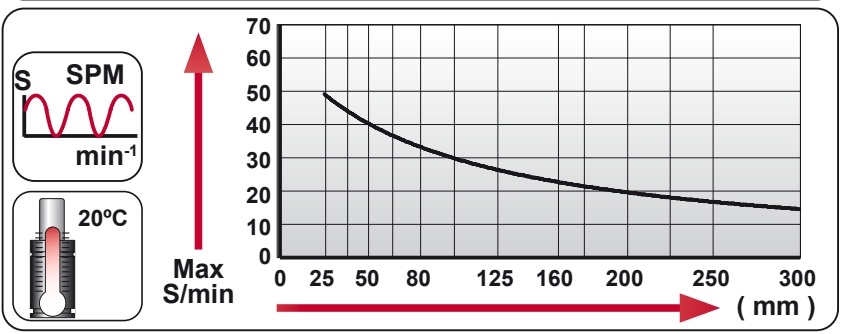
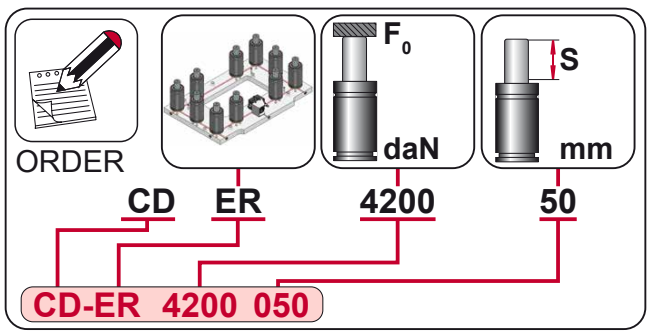
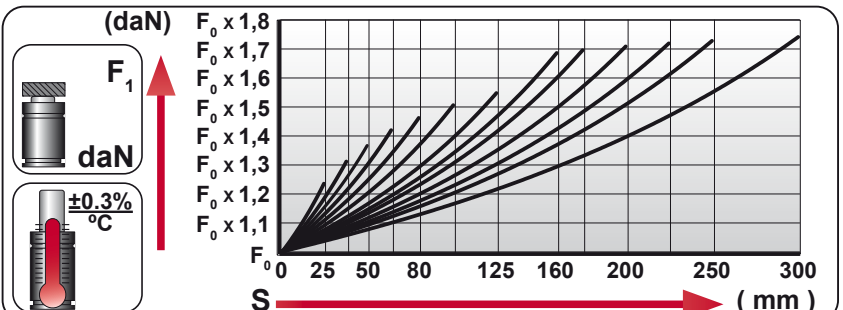
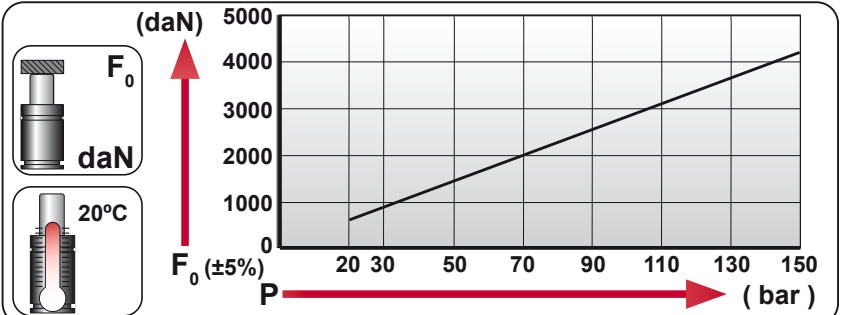

--	--	--	--	--	--	--	--

N ₂	Smax < 90%	Vmax 1,6 m/s	bar psi	bar psi	°C °F	°C °F	600 CP_ _-ER
			20 290	150 2175	0 32	80 176	

AZOL GAS CD-ER 6600

Heavy Duty

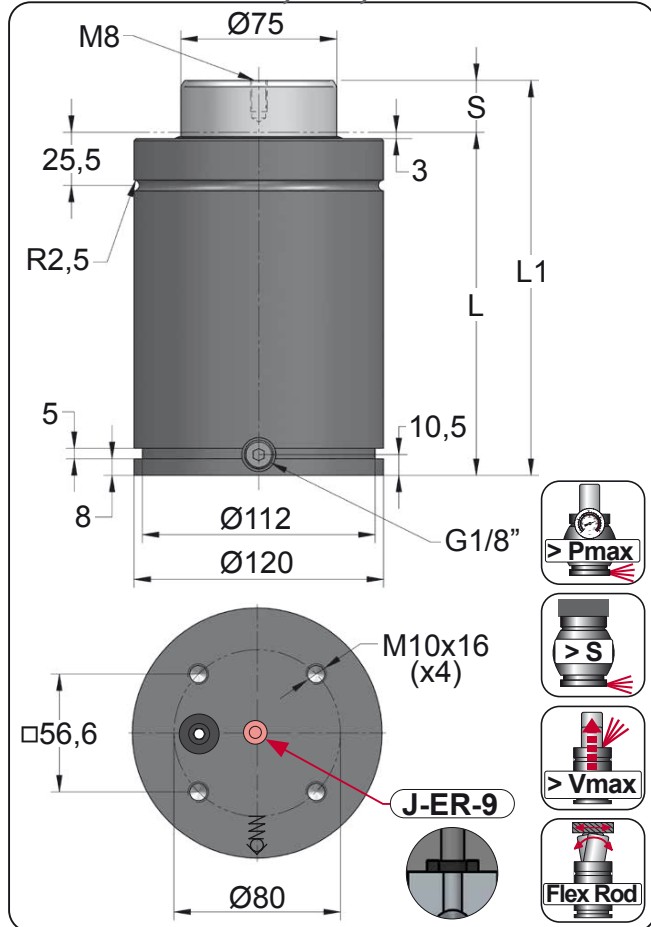

ORDER	S (mm)	L1 ±0.25 (mm)	L (mm)	Kg.
CD-ER 6600 025	25	190	165	9.99
CD-ER 6600 038	38	216	178	10.59
CD-ER 6600 050	50	240	190	11.15
CD-ER 6600 063	63.5	267	203.5	11.78
CD-ER 6600 080	80	300	220	12.54
CD-ER 6600 100	100	340	240	13.47
CD-ER 6600 125	125	390	265	14.63
CD-ER 6600 160	160	460	300	16.25
CD-ER 6600 175	175	490	315	16.95
CD-ER 6600 200	200	540	340	18.11
CD-ER 6600 225	225	590	365	19.27
CD-ER 6600 250	250	640	390	20.43
CD-ER 6600 300	300	740	440	22.75

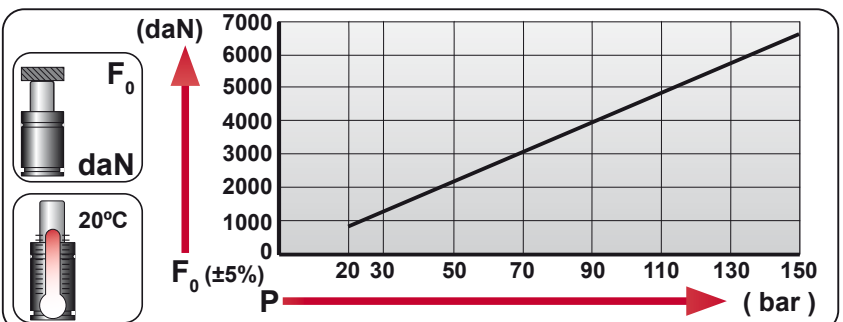

CODE	Pressure Gauge	Pressure	Force	Force	
		bar	psi	daN	daN
CD 6600 050		150	2175	6630	9060
CD-ER 6600 050		0	0	---	---

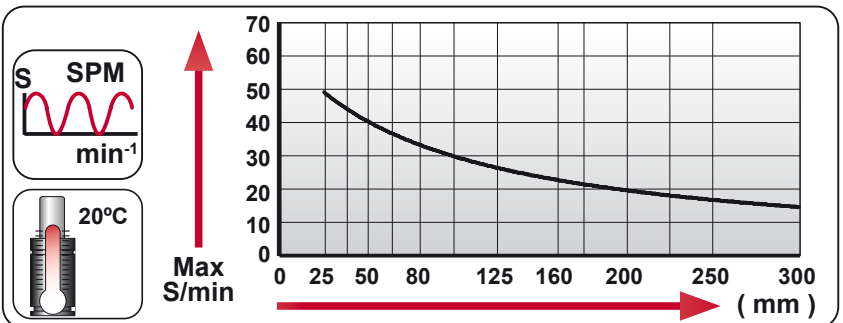
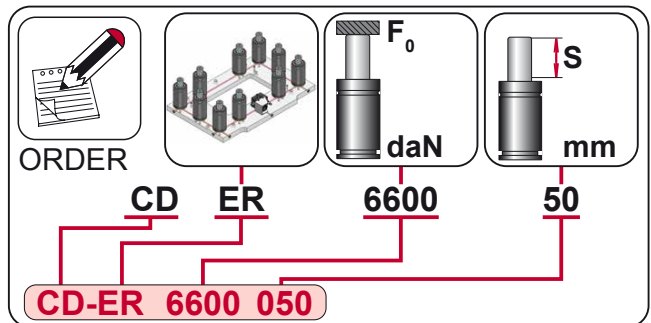
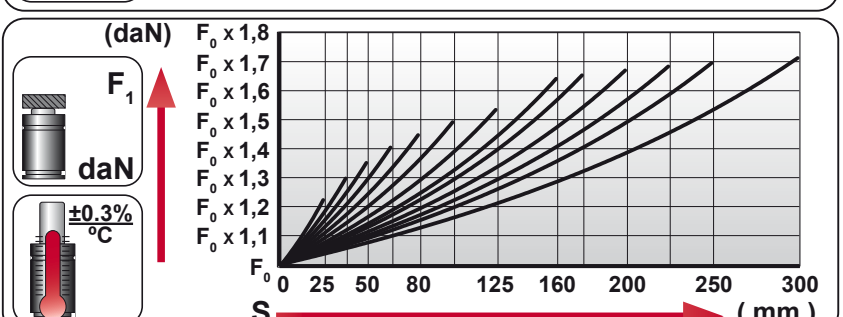

N ₂	S _{max} < 90%	V _{max} 1,6 m/s	bar psi	bar psi	°C °F	°C °F	600 CP_ _-ER
			20 290	150 2175	0 32	80 176	

CD-ER 9600

Heavy Duty

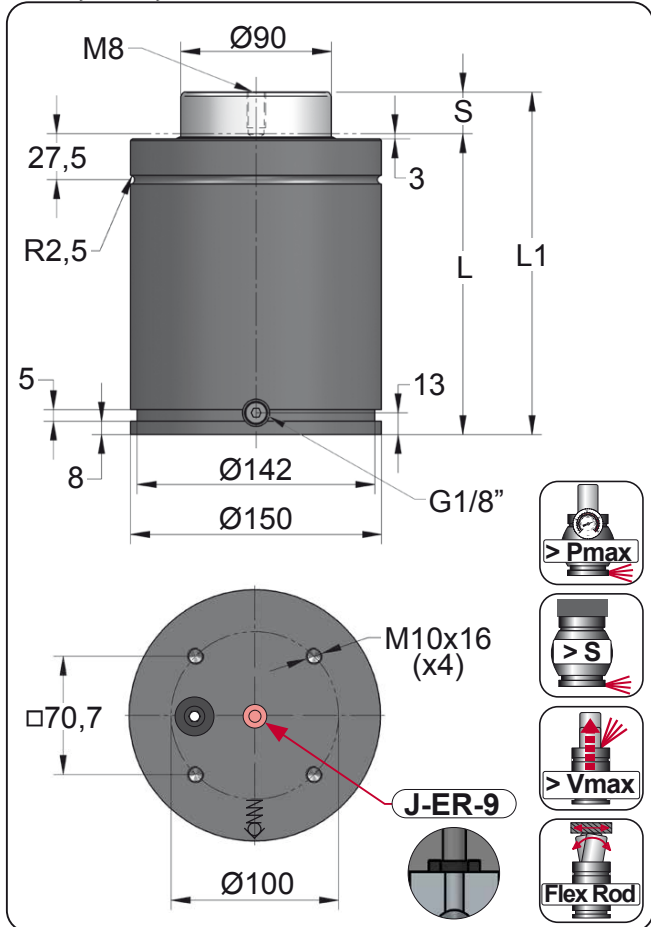

ORDER	S (mm)	L1 ±0.25 (mm)	L (mm)	Kg.
CD-ER 9600 025	25	205	180	17.07
CD-ER 9600 038	38	231	193	17.93
CD-ER 9600 050	50	255	205	18.72
CD-ER 9600 063	63.5	282	218.5	19.62
CD-ER 9600 080	80	315	235	20.71
CD-ER 9600 100	100	355	255	22.04
CD-ER 9600 125	125	405	280	23.70
CD-ER 9600 160	160	475	315	26.02
CD-ER 9600 175	175	505	330	27.01
CD-ER 9600 200	200	555	355	28.67
CD-ER 9600 225	225	605	380	30.32
CD-ER 9600 250	250	655	405	31.98
CD-ER 9600 300	300	755	455	35.29



CODE	Pressure Gauge	Pressure	Force F ₀	Force F ₁
	bar	psi	daN	daN
CD 9600 050	150	2175	9540	12345
CD-ER 9600 050	0	0	---	---

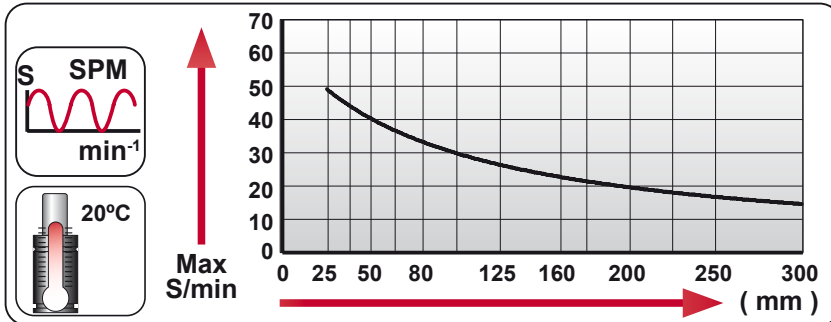
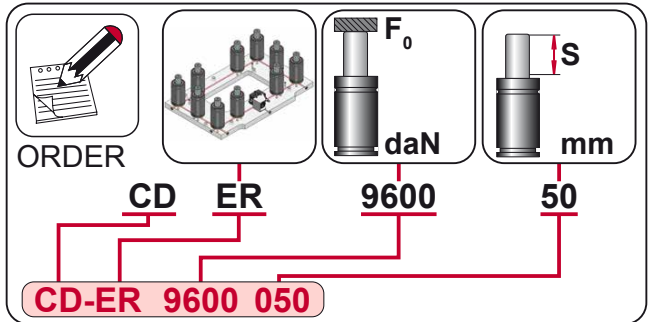
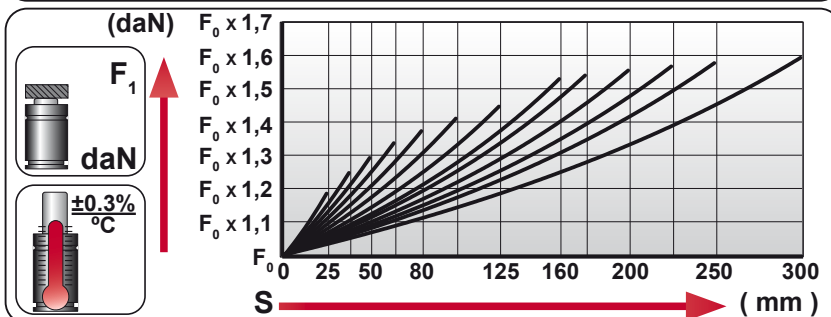
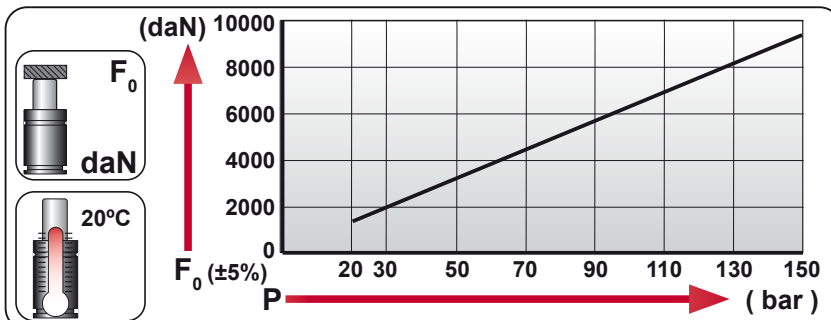

N ₂	Smax < 90%	Vmax 1,6 m/s	bar psi 20 290 150 2175	°C °F 0 32 80 176	600 CP_ _-ER

AZOL GAS CD-ER 18500

Heavy Duty

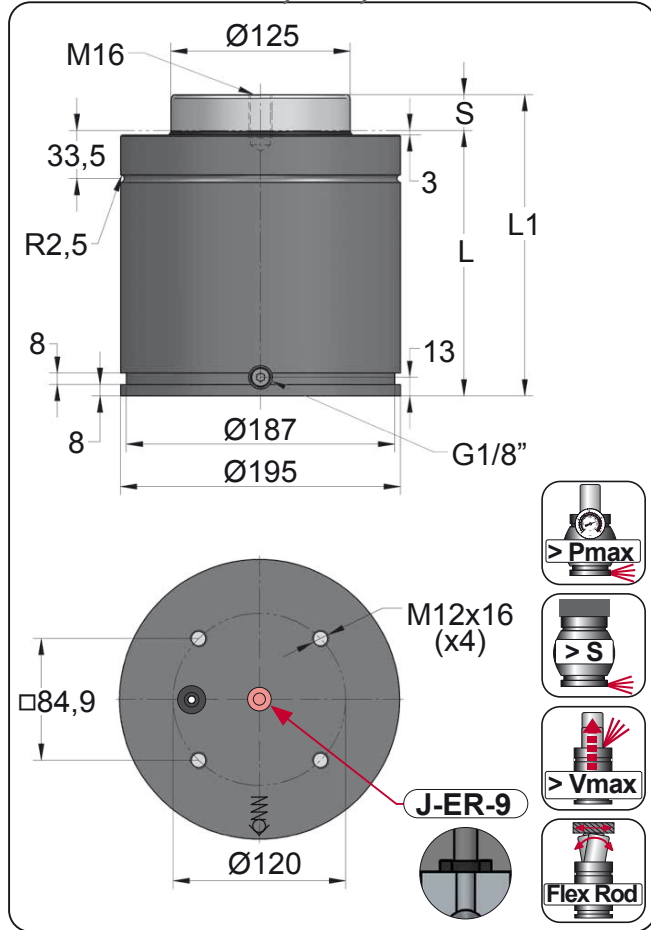

ORDER	S (mm)	L1 ±0.25 (mm)	L (mm)	Kg.
CD-ER 18500 025	25	210	185	33.88
CD-ER 18500 038	38	236	198	35.68
CD-ER 18500 050	50	260	210	37.33
CD-ER 18500 063	63.5	287	223.5	39.20
CD-ER 18500 080	80	320	240	41.48
CD-ER 18500 100	100	360	260	44.25
CD-ER 18500 125	125	410	285	47.70
CD-ER 18500 160	160	480	320	52.54
CD-ER 18500 200	200	560	360	58.07
CD-ER 18500 250	250	660	410	64.99
CD-ER 18500 300	300	760	460	71.90

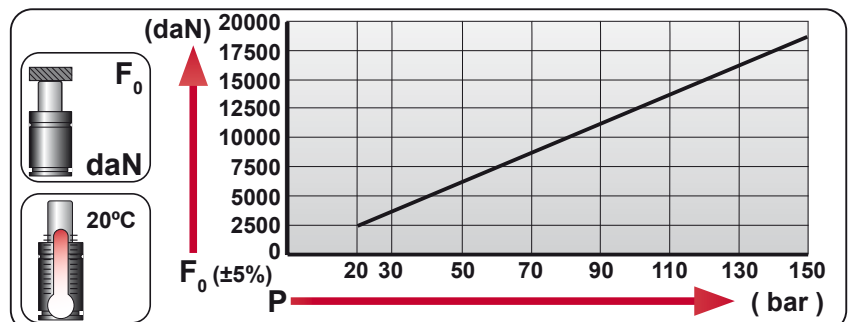

CODE	Pressure Gauge	bar	psi	F ₀ daN	F ₁ daN
CD 18500 050		150	2175	18410	27300
CD-ER 18500 050		0	0	---	---

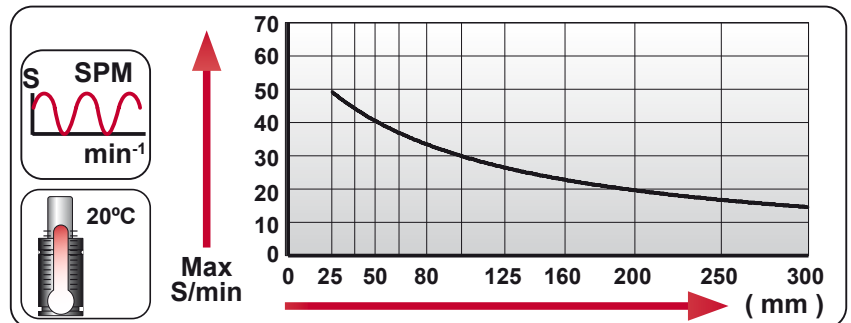
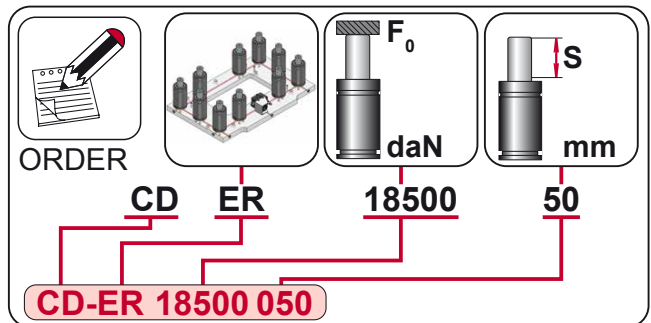
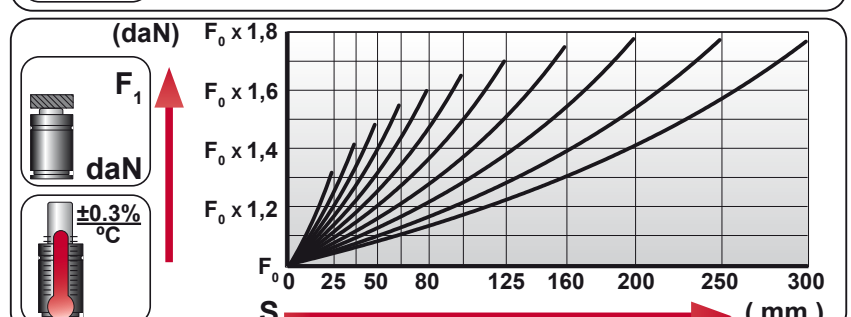

N ₂	S _{max} < 90%	V _{max} 1,6 m/s	bar psi	bar psi	°C °F	°C °F	600 CP_ _-ER

KZ-ER 1500

Compact Height

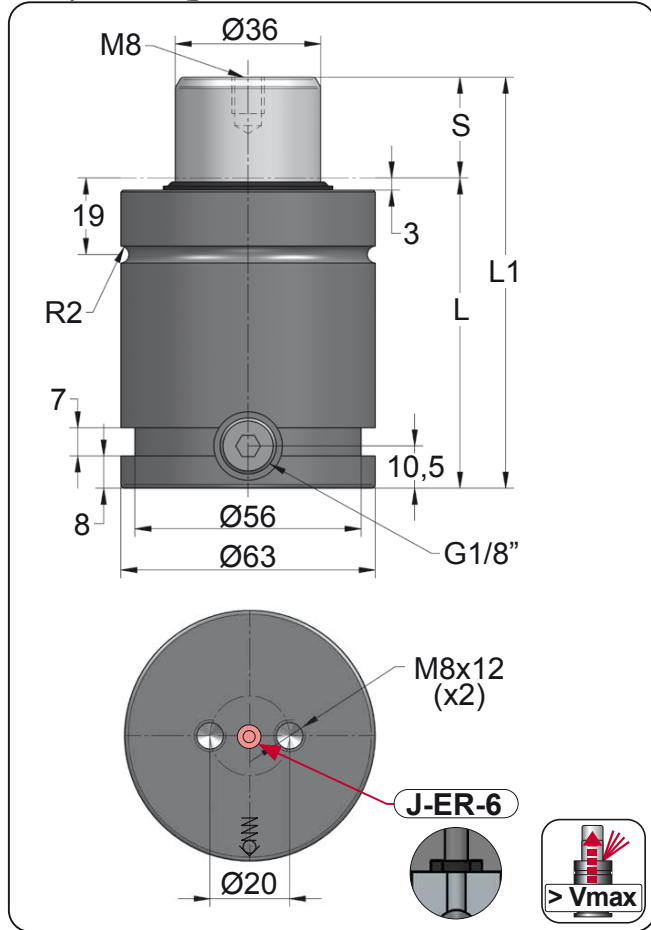

ORDER	S (mm)	L1 ±0.25 (mm)	L (mm)	Kg.
KZ-ER 1500 013	13	78	65	1.17
KZ-ER 1500 016	16	84	68	1.21
KZ-ER 1500 019	19	90	71	1.25
KZ-ER 1500 025	25	102	77	1.32
KZ-ER 1500 032	32	116	84	1.41
KZ-ER 1500 038	38	128	90	1.49
KZ-ER 1500 050	50	152	102	1.65
KZ-ER 1500 063	63	178	115	1.81
KZ-ER 1500 075	75	202	127	1.97
KZ-ER 1500 080	80	212	132	2.03
KZ-ER 1500 100	100	252	152	2.29
KZ-ER 1500 125	125	302	177	2.61

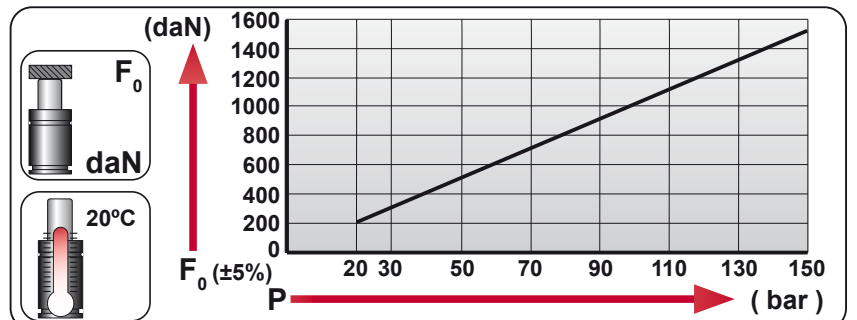

CODE	Image	bar	psi	F ₀ daN	F ₁ daN
KZ 1500 050 V1		150	2175	1530	2475
KZ-ER 1500 050 V1		0	0	---	---

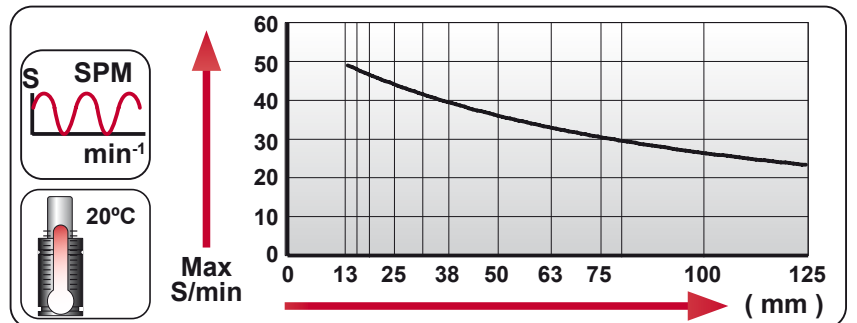
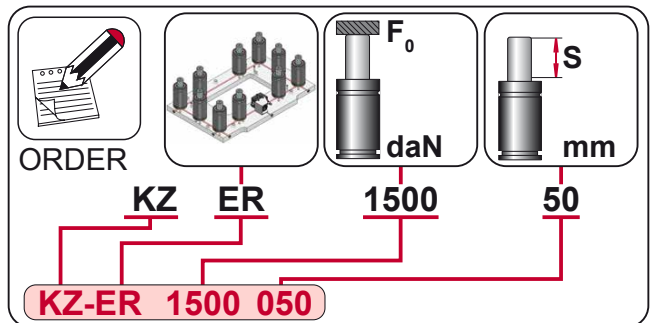
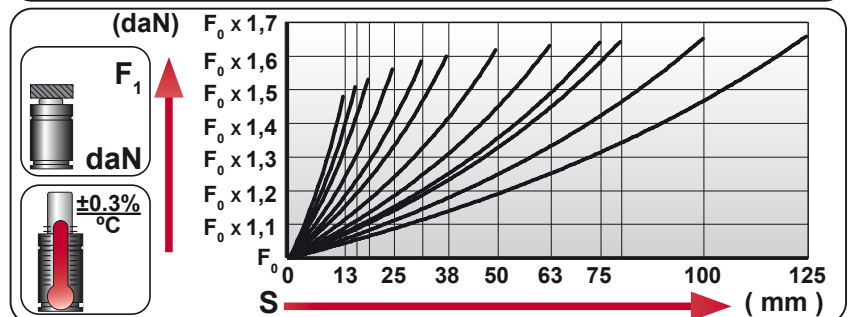

N ₂	Smax < 90%	Vmax 1,6 m/s	bar psi 20 290 150 2175	°C °F 0 32 80 176	600 CP_ _-ER

AZOL GAS KZ-ER 2400

Compact Height

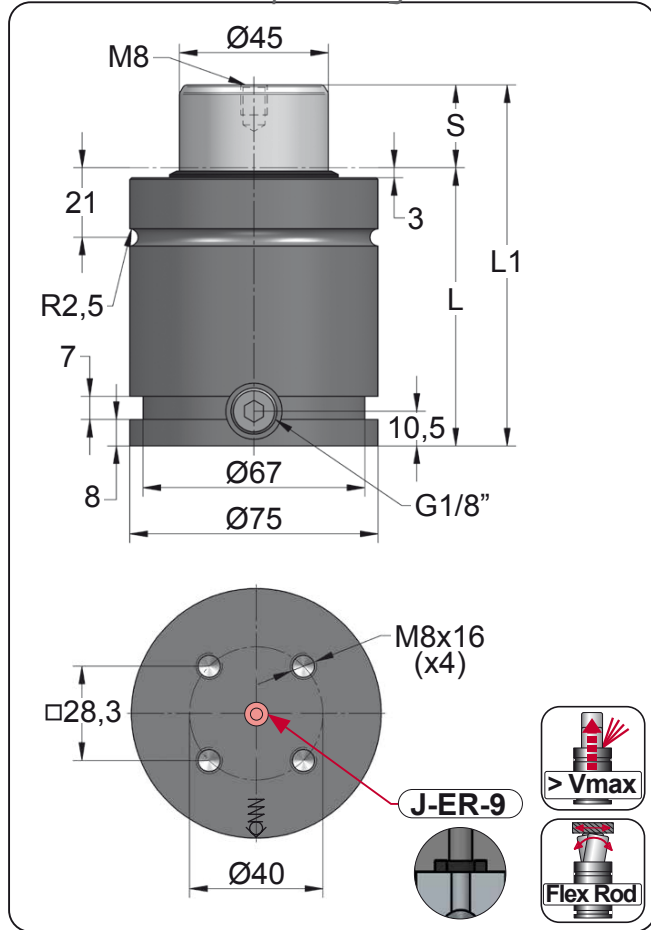

ORDER	S (mm)	L1 ±0.25 (mm)	L (mm)	Kg.
KZ-ER 2400 013	13	85	72	1.86
KZ-ER 2400 016	16	91	75	1.91
KZ-ER 2400 019	19	97	78	1.96
KZ-ER 2400 025	25	109	84	2.06
KZ-ER 2400 032	32	123	91	2.18
KZ-ER 2400 038	38	135	97	2.28
KZ-ER 2400 050	50	159	109	2.49
KZ-ER 2400 063	63	185	122	2.71
KZ-ER 2400 075	75	209	134	2.92
KZ-ER 2400 080	80	219	139	3.01
KZ-ER 2400 100	100	259	159	3.35
KZ-ER 2400 125	125	309	184	3.78



CODE	Image	Pressure		Force	
		bar	psi	daN	daN
KZ 2400 050		150	2175	2385	3890
KZ-ER 2400 050		0	0	---	---

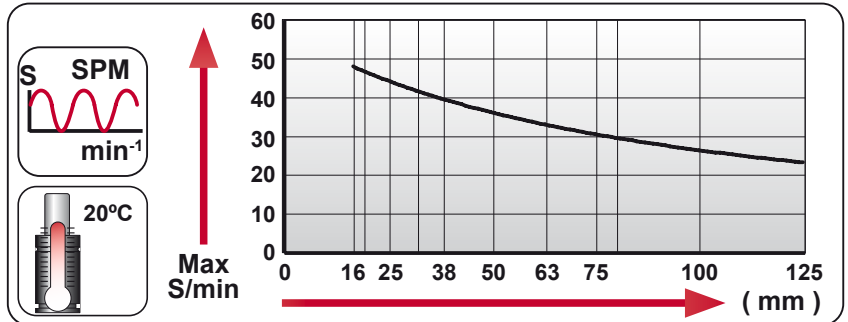
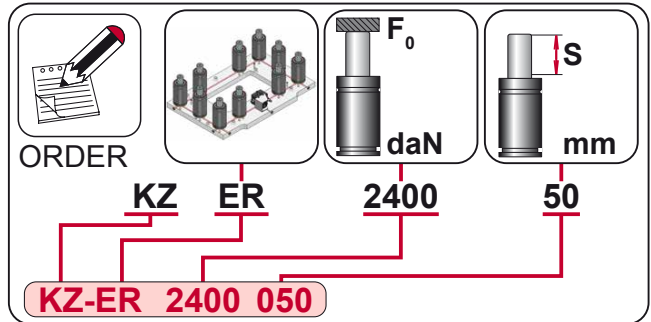
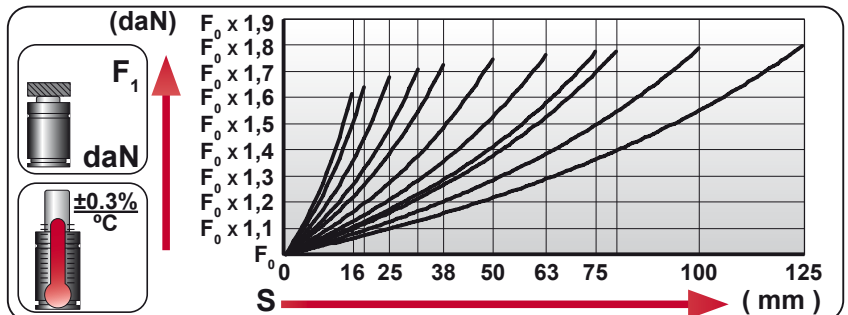
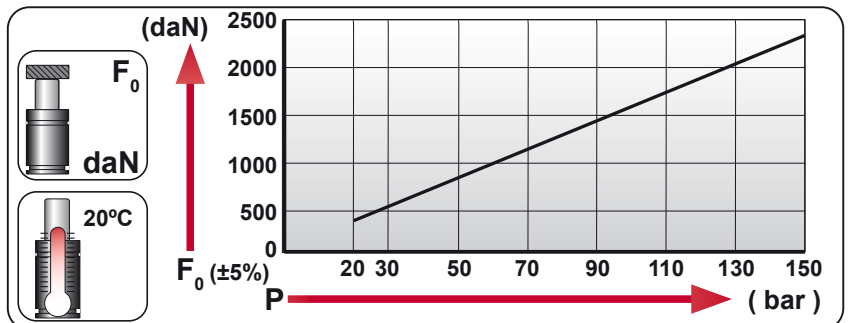

N ₂	Smax < 90%	Vmax 1,6 m/s	bar psi 20 290	bar psi 150 2175	°C °F 0 32	°C °F 80 176	600 CP_ _-ER

KZ-ER 4200

Compact Height

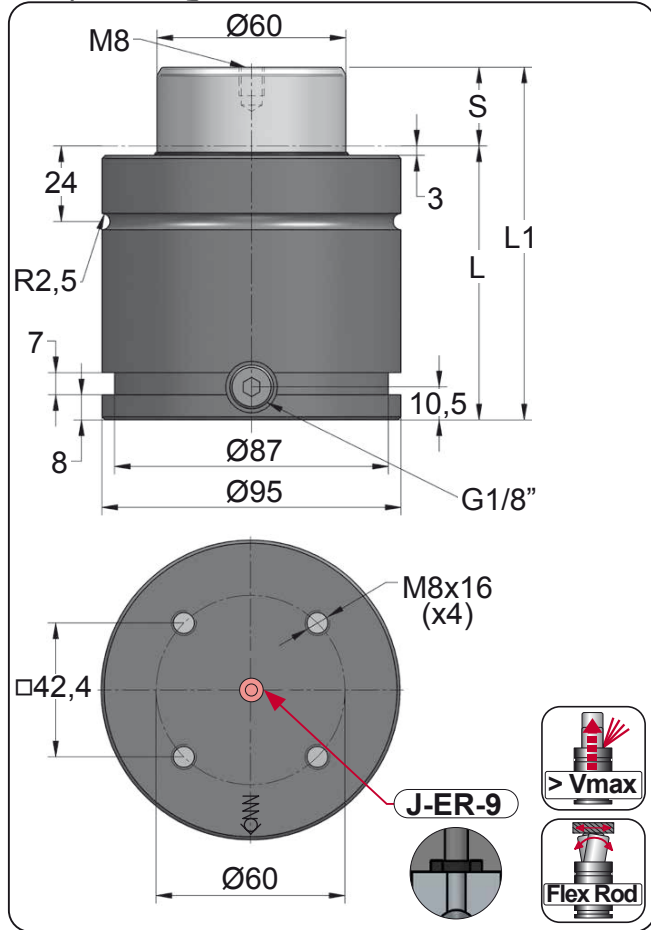

ORDER	S (mm)	L1 ±0.25 (mm)	L (mm)	Kg.
KZ-ER 4200 016	16	94	78	3.25
KZ-ER 4200 019	19	100	81	3.34
KZ-ER 4200 025	25	112	87	3.51
KZ-ER 4200 032	32	126	94	3.71
KZ-ER 4200 038	38	138	100	3.88
KZ-ER 4200 050	50	162	112	4.22
KZ-ER 4200 063	63	188	125	4.59
KZ-ER 4200 075	75	212	137	4.93
KZ-ER 4200 080	80	222	142	5.08
KZ-ER 4200 100	100	262	162	5.65
KZ-ER 4200 125	125	312	187	6.36

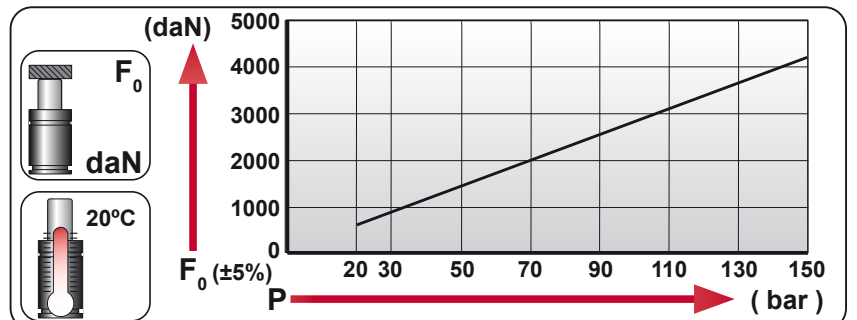

CODE	Pressure Gauge	bar	psi	F ₀ daN	F ₁ daN
KZ 4200 050		150	2175	4240	7200
KZ-ER 4200 050		0	0	---	---

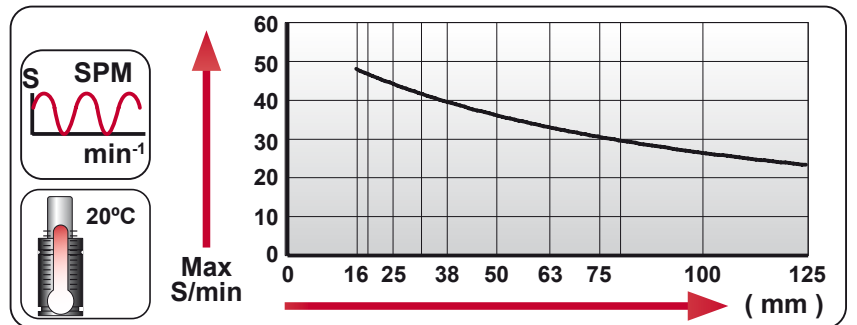
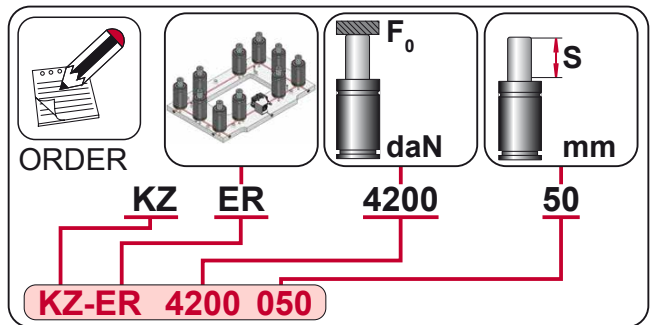
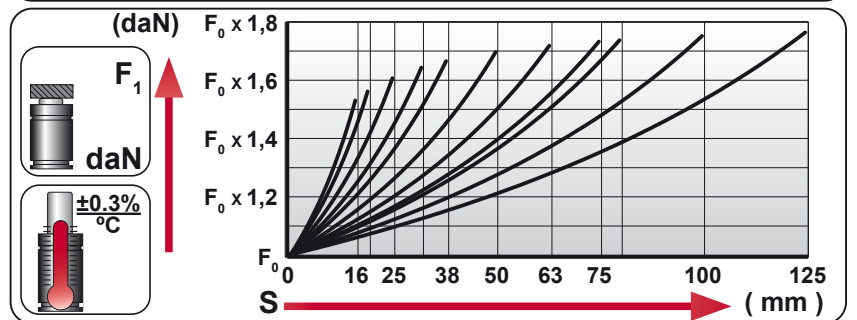

N ₂	S _{max} < 90%	V _{max} 1,6 m/s	bar psi 20 290	bar psi 150 2175	°C °F 0 32	°C °F 80 176	600 CP_ _-ER

AZOL GAS KZ-ER 6600

Compact Height

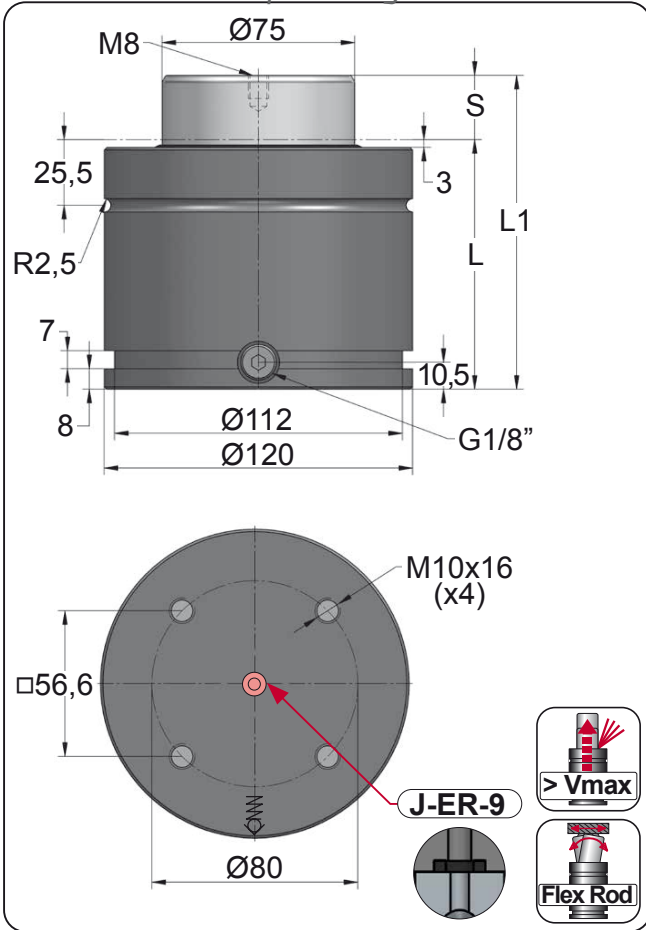

ORDER	S (mm)	L1 ±0,25 (mm)	L (mm)	Kg.	APPROVED PED 2014 / 2016
KZ-ER 6600 016	16	104	88	5.94	
KZ-ER 6600 019	19	110	91	6.08	
KZ-ER 6600 025	25	122	97	6.35	
KZ-ER 6600 032	32	136	104	6.68	
KZ-ER 6600 038	38	148	110	6.96	
KZ-ER 6600 050	50	172	122	7.51	
KZ-ER 6600 063	63	198	135	8.12	
KZ-ER 6600 075	75	222	147	8.67	
KZ-ER 6600 080	80	232	152	8.91	
KZ-ER 6600 100	100	272	172	9.83	
KZ-ER 6600 125	125	322	197	10.99	

CODE	Image	bar	psi	F ₀ daN	F ₁ daN
KZ 6600 050		150	2175	6630	10905
KZ-ER 6600 050		0	0	---	---

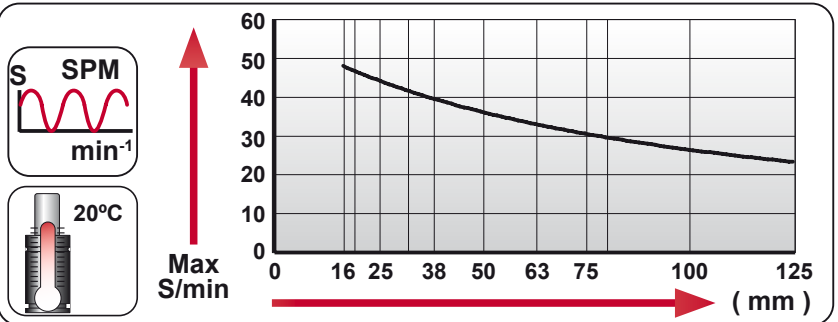
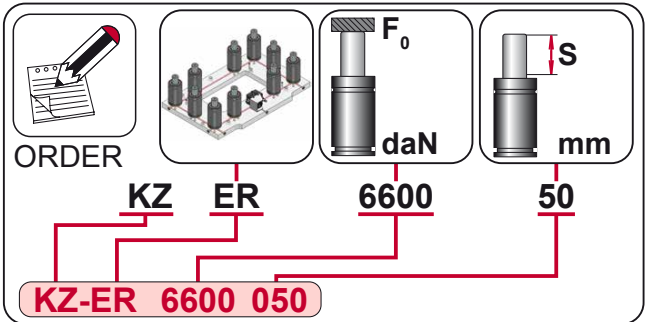
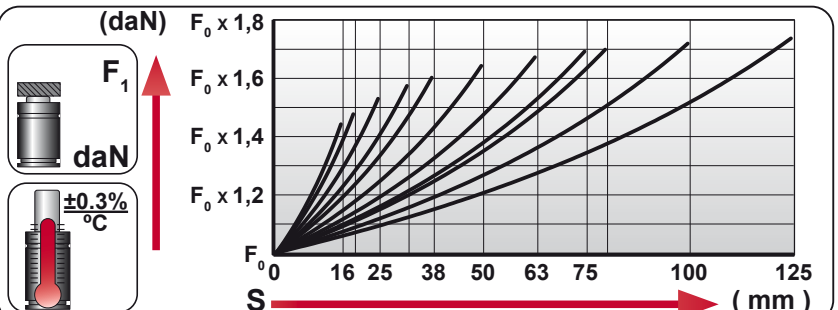
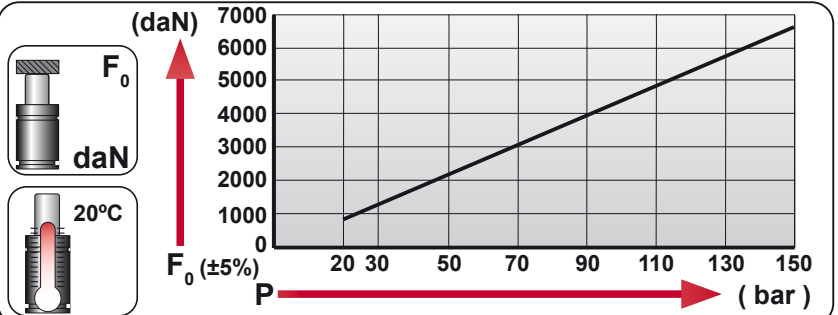

--	--	--	--	--	--	--	--

N ₂	Smax < 90%	Vmax 1,6 m/s	bar psi	bar psi	°C °F	°C °F	600 CP_ _-ER
			20 290	150 2175	0 32	80 176	

CW-ER 1500 V1

Compact Height

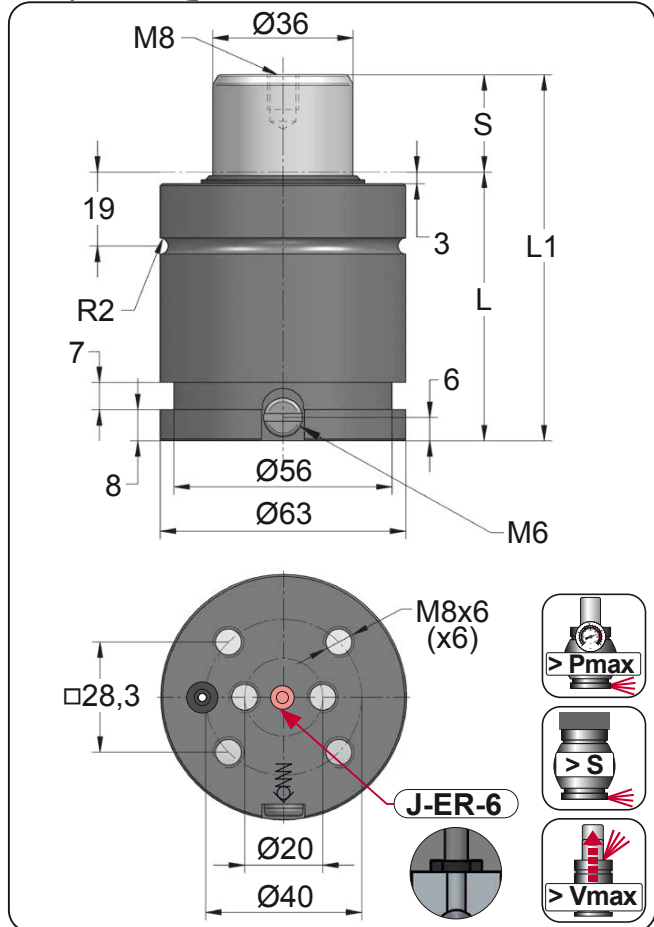

ORDER	S (mm)	L1 ±0.25 (mm)	L (mm)	Kg.
CW-ER 1500 013 V1	13	70	57	0.99
CW-ER 1500 016 V1	16	76	60	1.03
CW-ER 1500 019 V1	19	82	63	1.07
CW-ER 1500 025 V1	25	94	69	1.15
CW-ER 1500 032 V1	32	108	76	1.24
CW-ER 1500 038 V1	38	120	82	1.31
CW-ER 1500 050 V1	50	144	94	1.47
CW-ER 1500 063 V1	63	170	107	1.63
CW-ER 1500 075 V1	75	194	119	1.79
CW-ER 1500 080 V1	80	204	124	1.85
CW-ER 1500 100 V1	100	244	144	2.11
CW-ER 1500 125 V1	125	294	169	2.43



CODE	Image	Pressure		Force	
		bar	psi	daN	daN
CW 1500 050 V1		150	2175	1530	2475
CW-ER 1500 050 V1		0	0	---	---

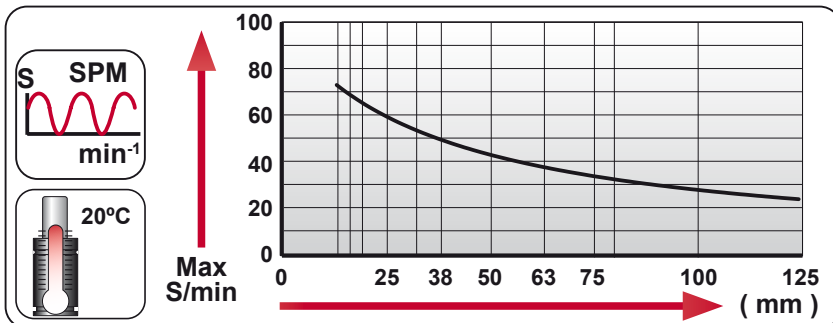
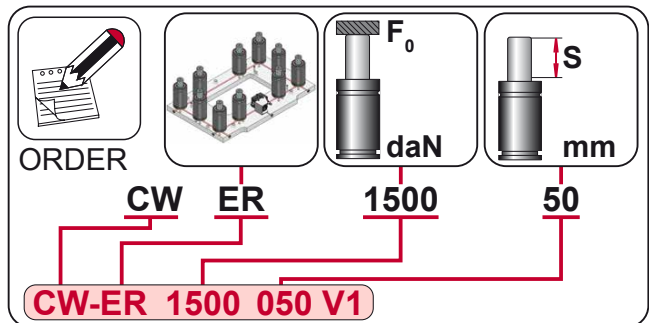
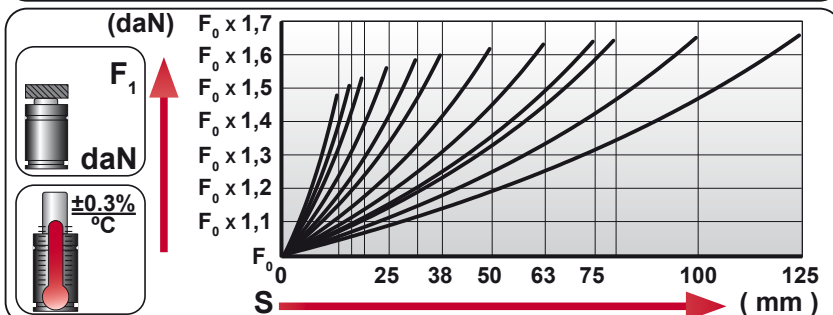
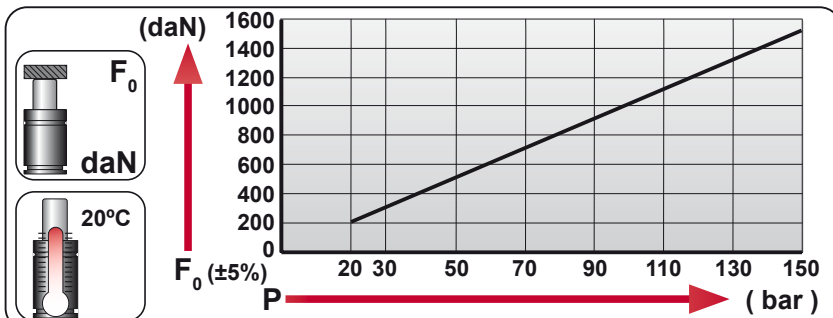

N ₂	S _{max} < 90%	V _{max} 1,6 m/s	bar psi	bar psi	°C °F	°C °F	600 CP_ _-ER
			20 290	150 2175	0 32	80 176	

AZOL GAS CW-ER 2400 V1

Compact Height

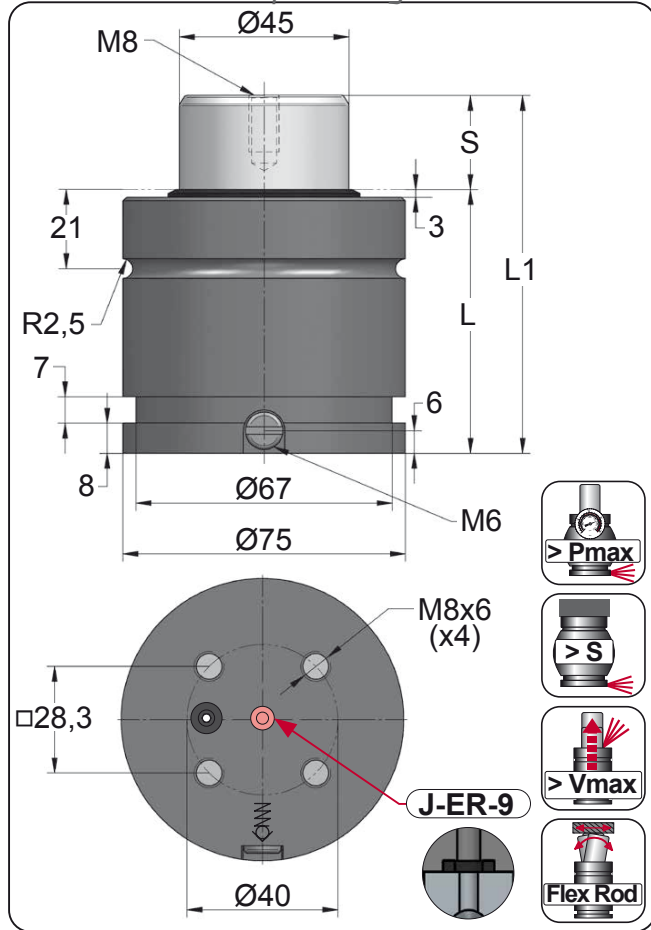

ORDER	S (mm)	L1 ±0.25 (mm)	L (mm)	Kg.
CW-ER 2400 013 V1	13	71	58	1.41
CW-ER 2400 016 V1	16	77	61	1.46
CW-ER 2400 019 V1	19	83	64	1.51
CW-ER 2400 025 V1	25	95	70	1.62
CW-ER 2400 032 V1	32	109	77	1.74
CW-ER 2400 038 V1	38	121	83	1.84
CW-ER 2400 050 V1	50	145	95	2.05
CW-ER 2400 063 V1	63	171	108	2.27
CW-ER 2400 075 V1	75	195	120	2.47
CW-ER 2400 080 V1	80	205	125	2.56
CW-ER 2400 100 V1	100	245	145	2.90
CW-ER 2400 125 V1	125	295	170	3.33

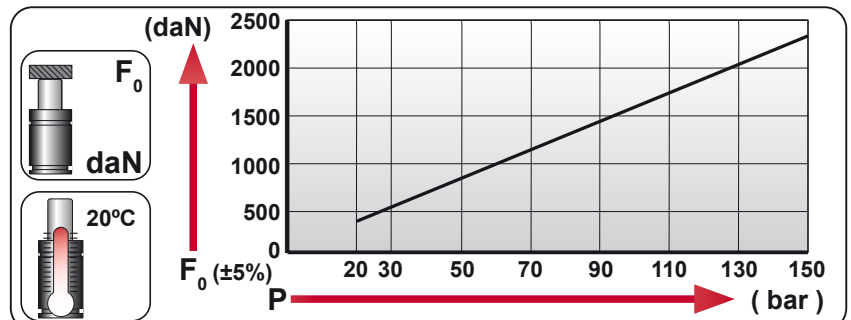

CODE	Image	Pressure		Force	
		bar	psi	daN	daN
CW 2400 050 V1		150	2175	2385	3890
CW-ER 2400 050 V1		0	0	---	---

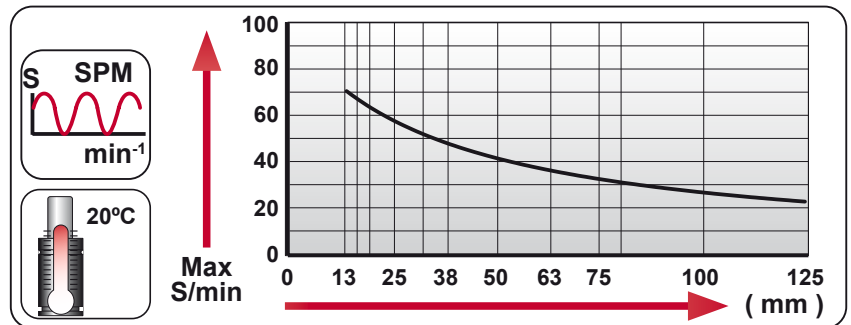
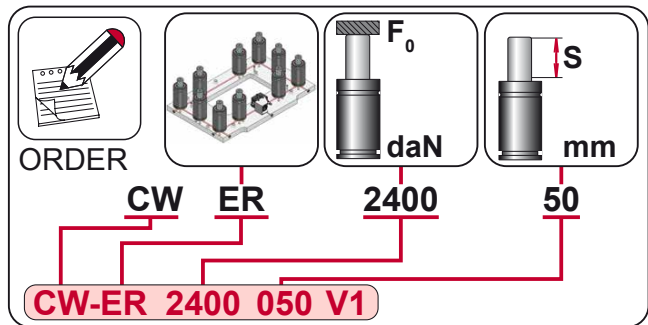
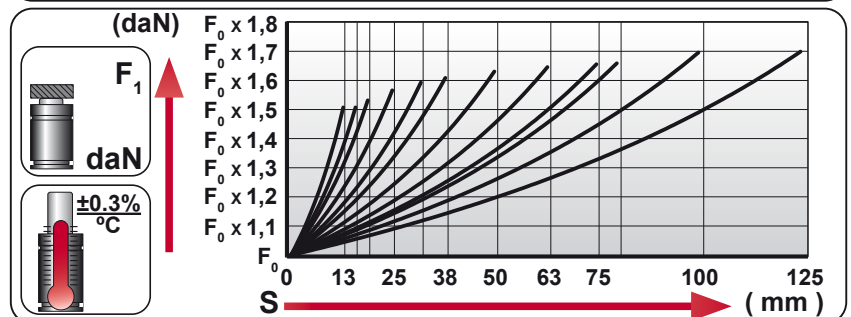

N ₂	Smax < 90%	Vmax 1,6 m/s	bar psi 20 290	bar psi 150 2175	°C °F 0 32	°C °F 80 176	600 CP_ _-ER

CW-ER 4200 V1

Compact Height

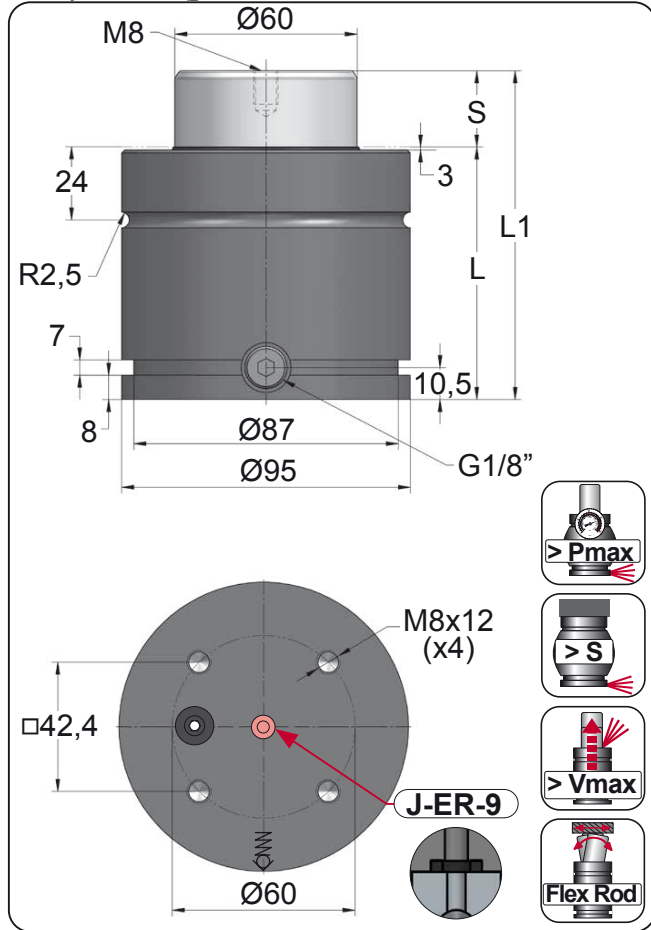

ORDER	S (mm)	L1 ±0.25 (mm)	L (mm)	Kg.
CW-ER 4200 016 V1	16	90	74	3.03
CW-ER 4200 019 V1	19	96	77	3.11
CW-ER 4200 025 V1	25	108	83	3.29
CW-ER 4200 032 V1	32	122	90	3.49
CW-ER 4200 038 V1	38	134	96	3.66
CW-ER 4200 050 V1	50	158	108	4.00
CW-ER 4200 063 V1	63	184	121	4.37
CW-ER 4200 075 V1	75	208	133	4.71
CW-ER 4200 080 V1	80	218	138	4.85
CW-ER 4200 100 V1	100	258	158	5.42
CW-ER 4200 125 V1	125	308	183	6.14

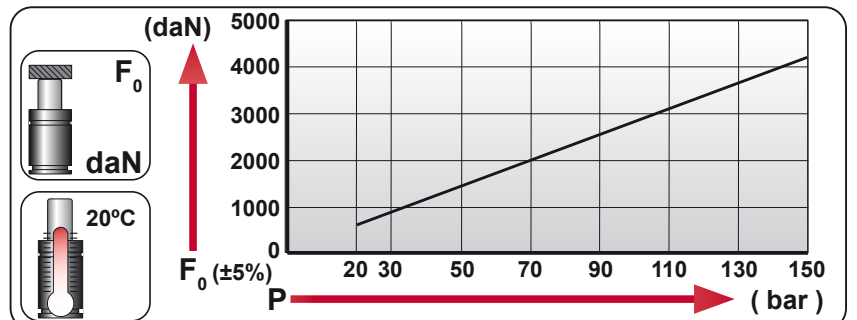

CODE	Pressure Range	Force Range	F ₀ (daN)	F ₁ (daN)
CW 4200 050 V1	0 - 150 bar / 0 - 2175 psi	500 - 4240 daN	4240	7200
CW-ER 4200 050 V1	0 - 0 bar / 0 - 0 psi	---	---	---

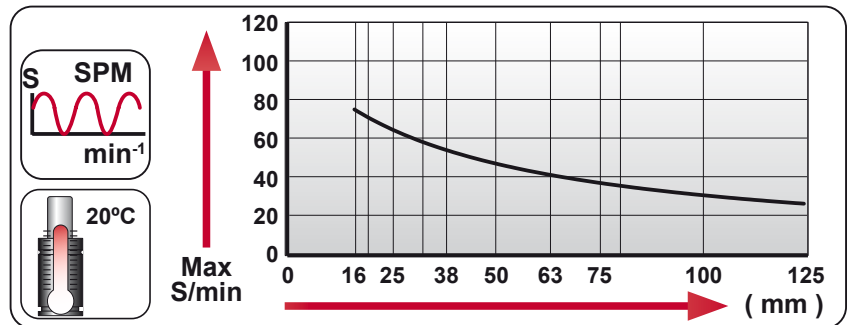
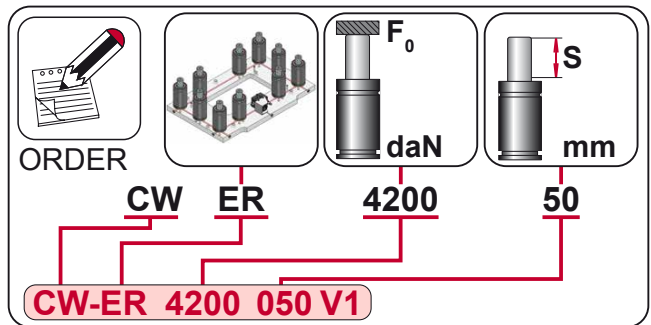
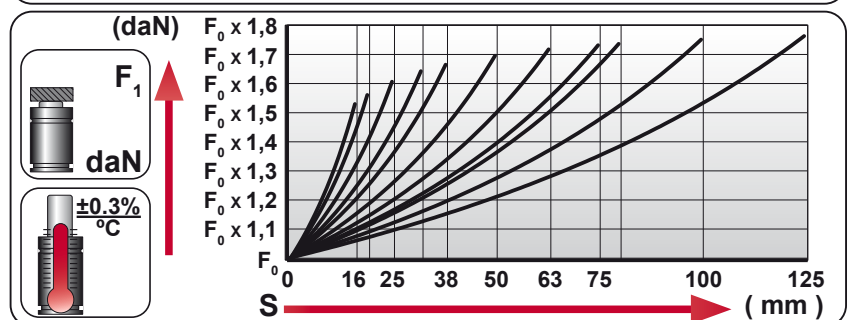

N ₂	Smax < 90%	Vmax 1,6 m/s	bar psi 20 290 150 2175	°C °F 0 32 80 176	600 CP_ _-ER

AZOL GAS CW-ER 6600

Compact Height

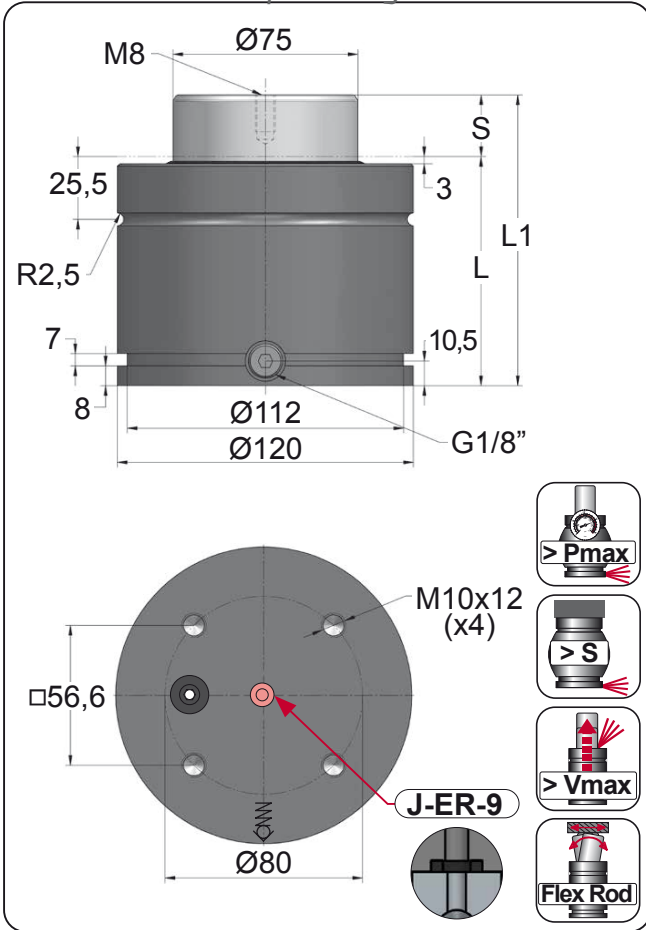

ORDER	S (mm)	L1 ±0.25 (mm)	L (mm)	Kg.
CW-ER 6600 016	16	100	84	5.51
CW-ER 6600 019	19	106	87	5.65
CW-ER 6600 025	25	118	93	5.93
CW-ER 6600 032	32	132	100	6.26
CW-ER 6600 038	38	144	106	6.53
CW-ER 6600 050	50	168	118	7.09
CW-ER 6600 063	63	194	131	7.69
CW-ER 6600 075	75	218	143	8.25
CW-ER 6600 080	80	228	148	8.48
CW-ER 6600 100	100	268	168	9.41
CW-ER 6600 125	125	318	193	10.57

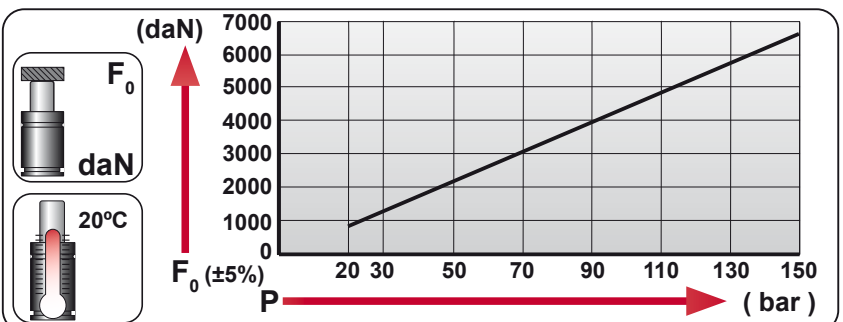

CODE	Pressure (bar)	Pressure (psi)	Force (F0) (daN)	Force (F1) (daN)
CW 6600 050	150	2175	6630	10810
CW-ER 6600 050	0	0	---	---

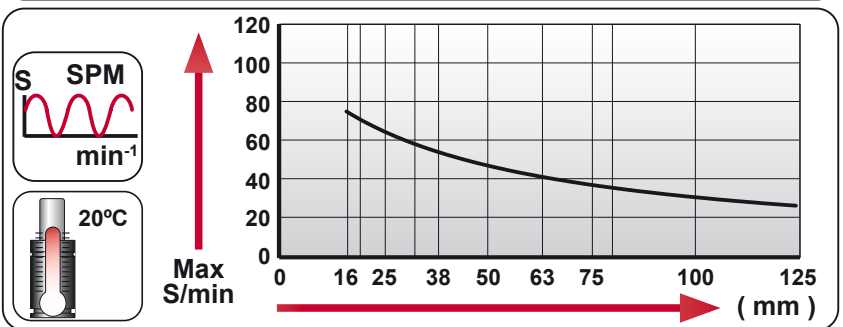
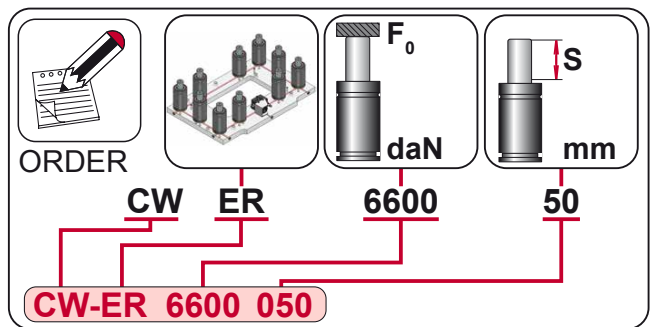
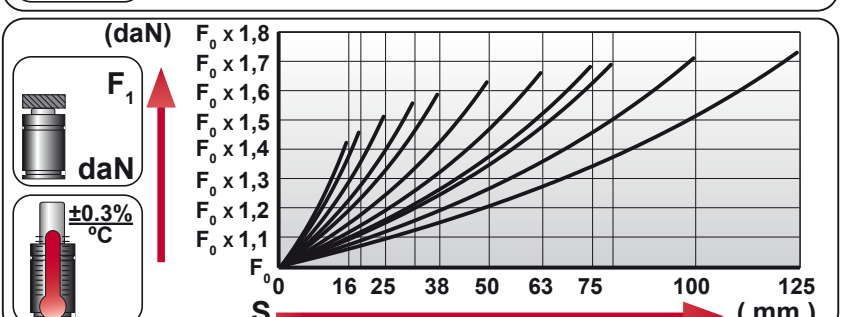

N ₂	Smax < 90%	Vmax 1,6 m/s	bar psi 20 290	bar psi 150 2175	°C °F 0 32	°C °F 80 176	600 CP_ _-ER

CW-ER 9500

Compact Height

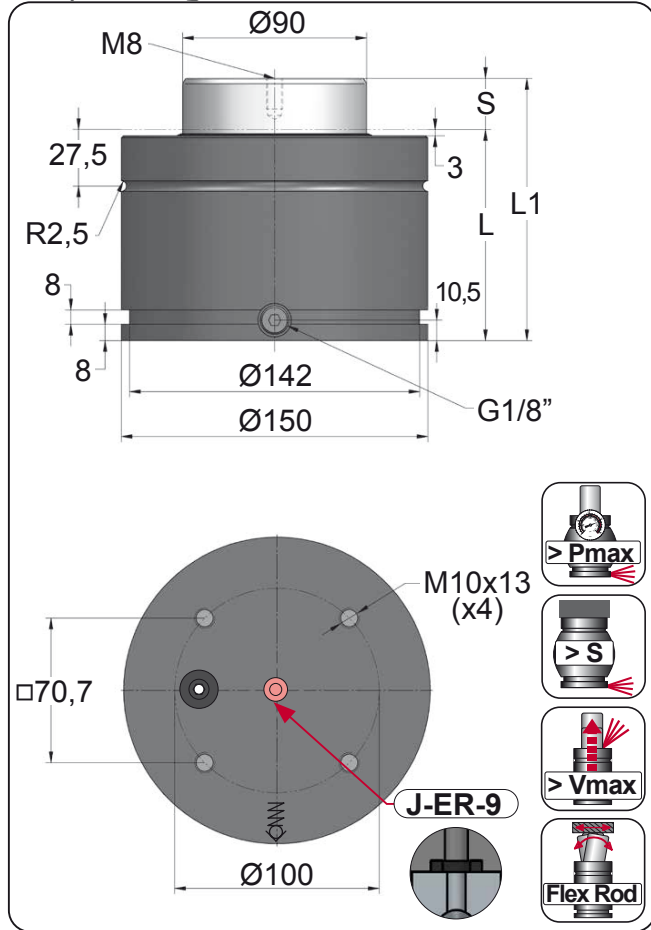

ORDER	S (mm)	L1 ±0.25 (mm)	L (mm)	Kg.
CW-ER 9500 019	19	116	97	9.96
CW-ER 9500 025	25	128	103	10.35
CW-ER 9500 032	32	142	110	10.82
CW-ER 9500 038	38	154	116	11.22
CW-ER 9500 050	50	178	128	12.01
CW-ER 9500 063	63	204	141	12.87
CW-ER 9500 075	75	228	153	13.67
CW-ER 9500 080	80	238	158	14.00
CW-ER 9500 100	100	278	178	15.32
CW-ER 9500 125	125	328	203	16.98

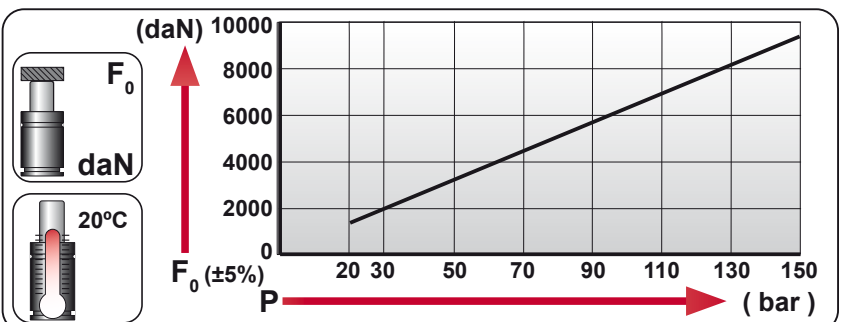

CODE	Pressure Sensor	Pressure	Force	Force
		bar	psi	daN
CW 9500 050		150	2175	9540
CW-ER 9500 050		0	0	---

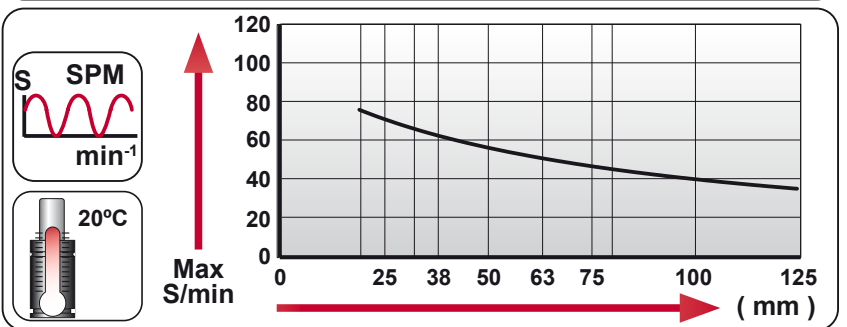
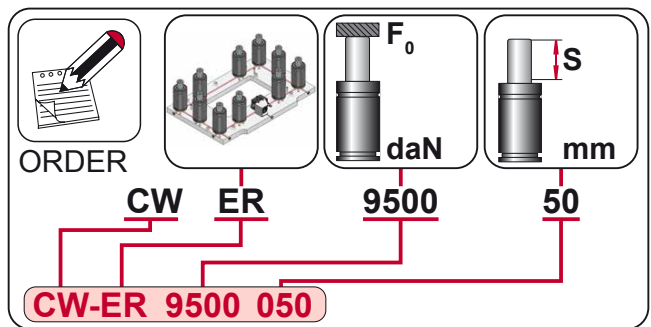
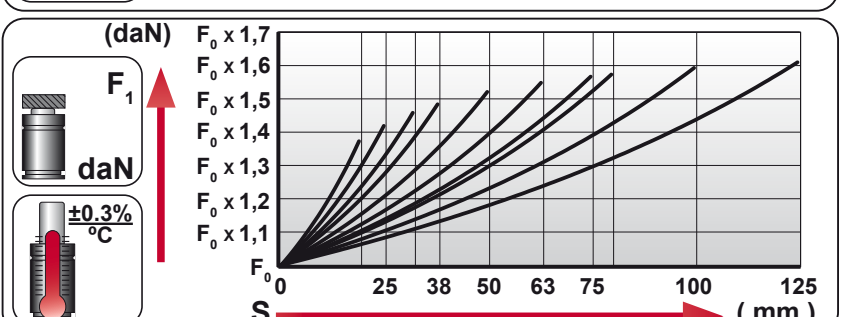

N ₂	S _{max} < 90%	V _{max} 1,6 m/s	bar psi	bar psi	°C °F	°C °F	600 CP_ _-ER
			20 290	150 2175	0 32	80 176	

AZOL GAS CW-ER 11800

Compact Height

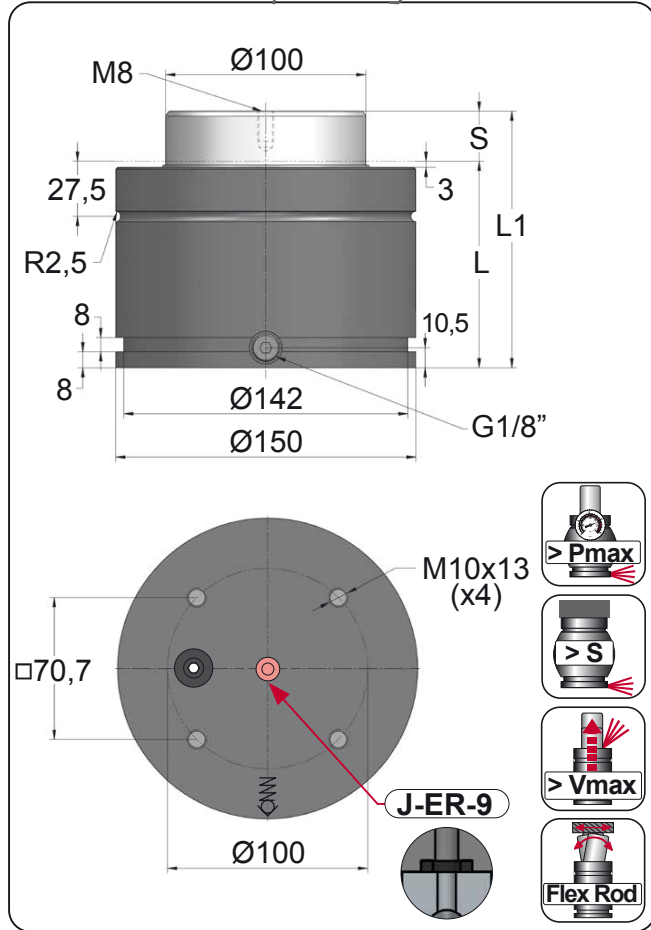

ORDER	S (mm)	L1 ±0.25 (mm)	L (mm)	Kg.
CW-ER 11800 019	19	116	97	9.89
CW-ER 11800 025	25	128	103	10.31
CW-ER 11800 032	32	142	110	10.79
CW-ER 11800 038	38	154	116	11.21
CW-ER 11800 050	50	178	128	12.04
CW-ER 11800 063	63	204	141	12.94
CW-ER 11800 075	75	228	153	13.78
CW-ER 11800 080	80	238	158	14.12
CW-ER 11800 100	100	278	178	15.51
CW-ER 11800 125	125	328	203	17.25

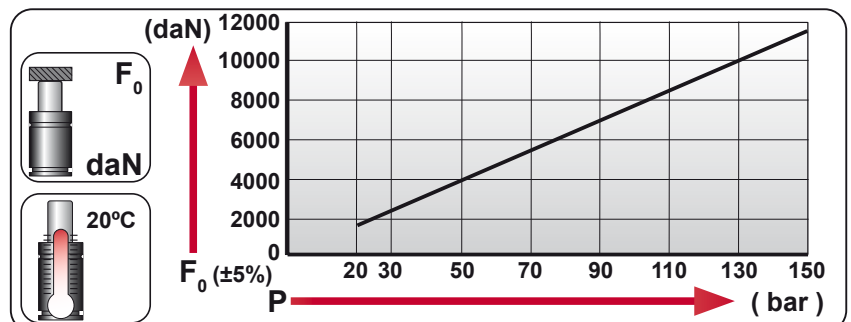

CODE	Pressure	Force	Force
	bar	psi	daN
CW 11800 050	150	2175	11780
CW-ER 11800 050	0	0	---

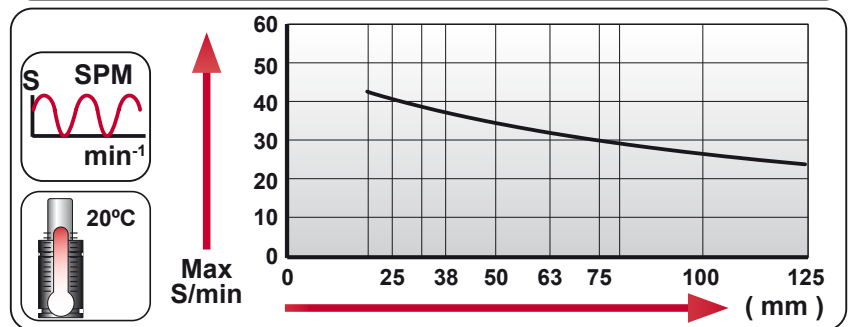
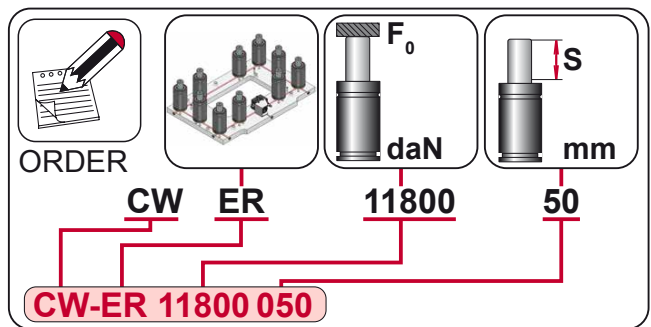
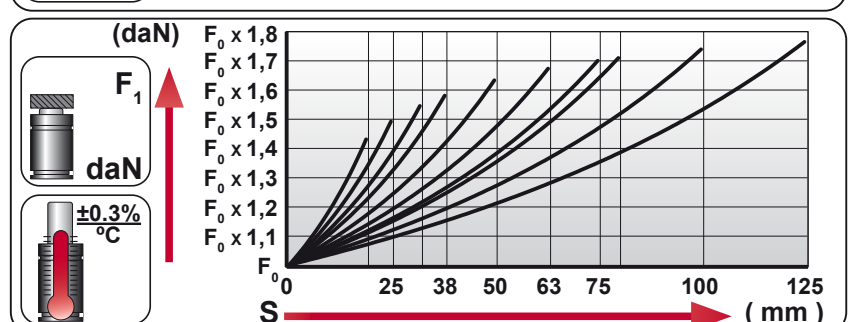

N ₂	Smax < 90%	Vmax 1,6 m/s	bar psi 20 290	bar psi 150 2175	°C °F 0 32
				°C °F 80 176	600 CP_ _-ER

CW-ER 20000

Compact Height

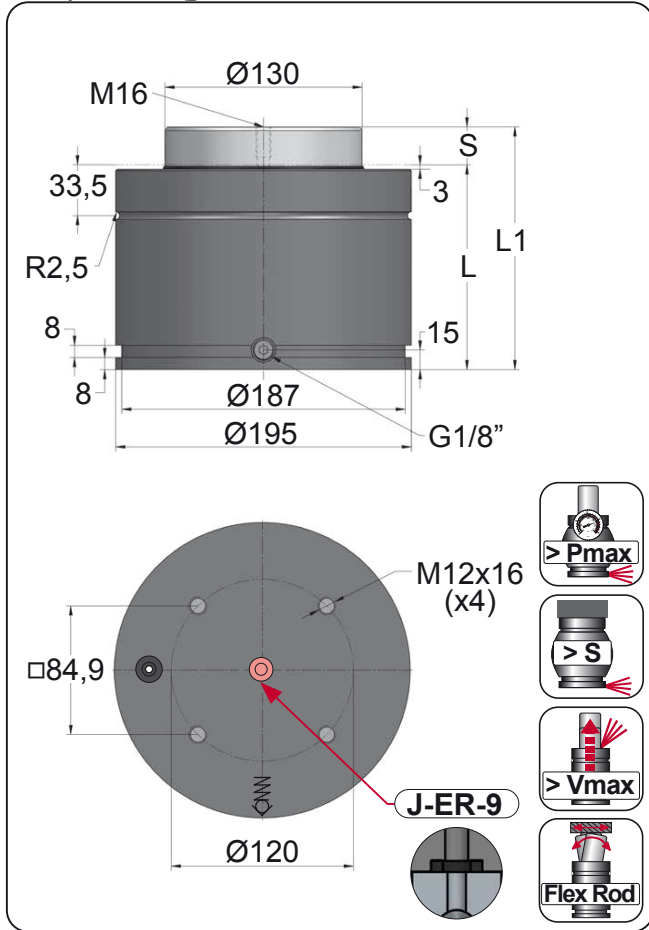

ORDER	S (mm)	L1 ±0.25 (mm)	L (mm)	Kg.
CW-ER 20000 019	19	148	129	22.69
CW-ER 20000 025	25	160	135	23.40
CW-ER 20000 032	32	174	142	24.24
CW-ER 20000 038	38	186	148	24.95
CW-ER 20000 050	50	210	160	26.38
CW-ER 20000 063	63	236	173	27.93
CW-ER 20000 075	75	260	185	29.36
CW-ER 20000 080	80	270	190	29.96
CW-ER 20000 100	100	310	210	32.34
CW-ER 20000 125	125	360	235	35.32

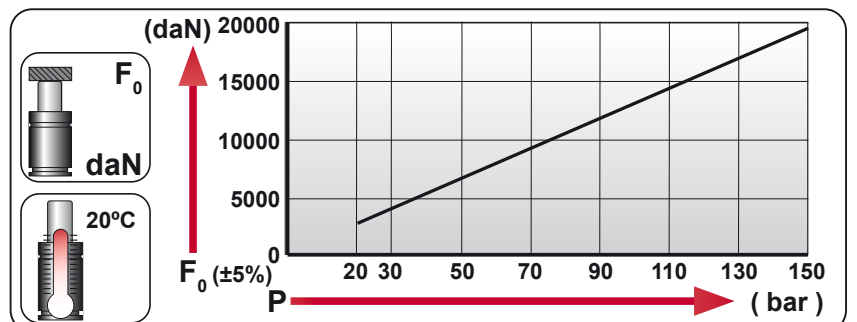

CODE	Pressure (bar)	Pressure (psi)	Force (F0) (daN)	Force (F1) (daN)
CW 20000 050	150	2175	19910	31410
CW-ER 20000 050	0	0	---	---

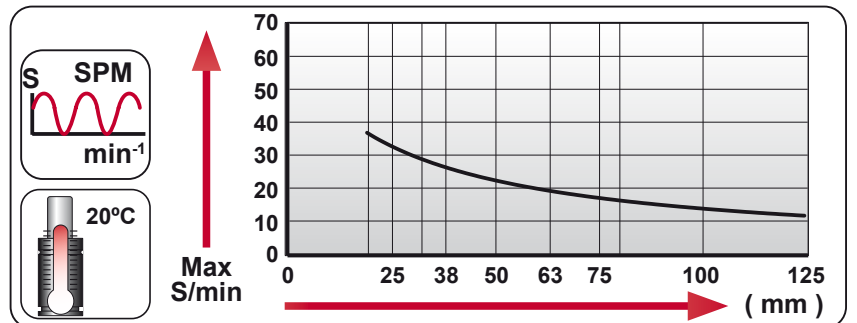
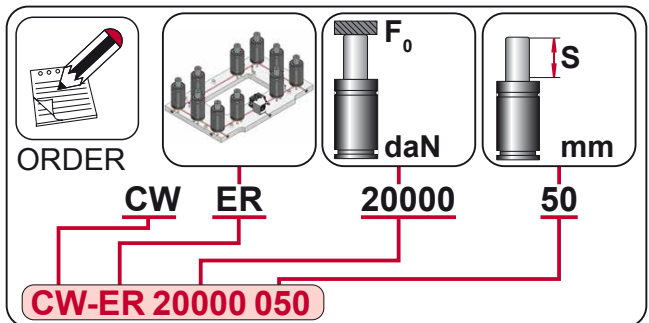
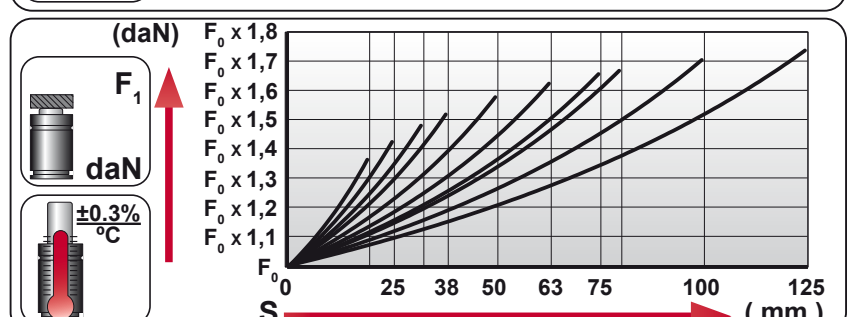

N ₂	Smax < 90%	Vmax 1,6 m/s	bar psi 20 290 150 2175	°C °F 20 32 80 176	600 CP_ _-ER



CS-ER 1800 V2

Power Compact Stroke

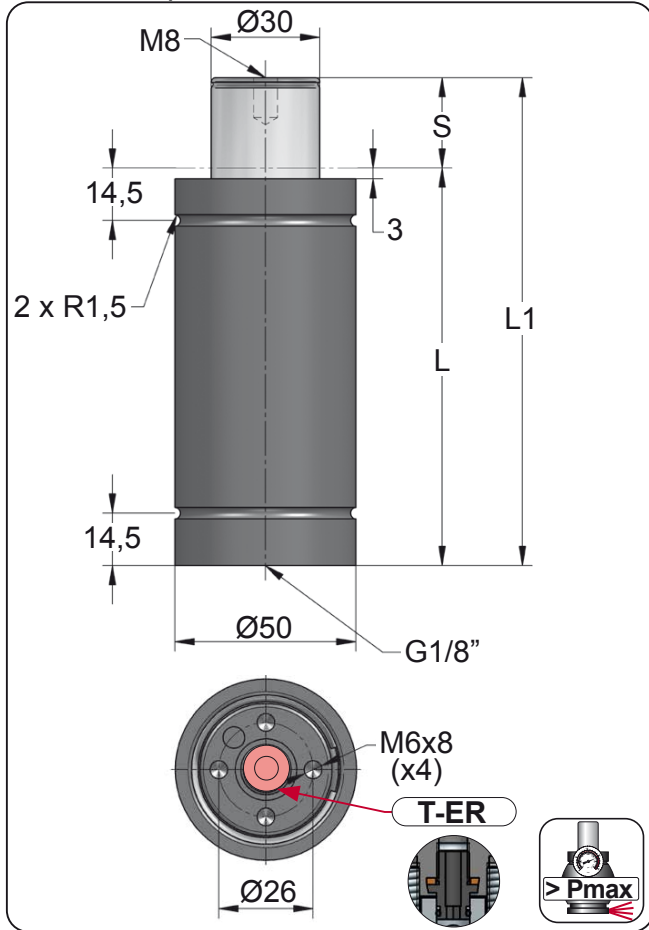

ORDER	S (mm)	L1 ±0,25 (mm)	L (mm)	Kg.
CS-ER 1800 006 V2	6	66	60	0.69
CS-ER 1800 010 V2	10	80	70	0.75
CS-ER 1800 016 V2	16	106	90	0.89
CS-ER 1800 025 V2	25	135	110	1.03
CS-ER 1800 032 V2	32	162	130	1.17
CS-ER 1800 040 V2	40	190	150	1.31
CS-ER 1800 050 V2	50	220	170	1.45
CS-ER 1800 065 V2	65	271	206	1.70

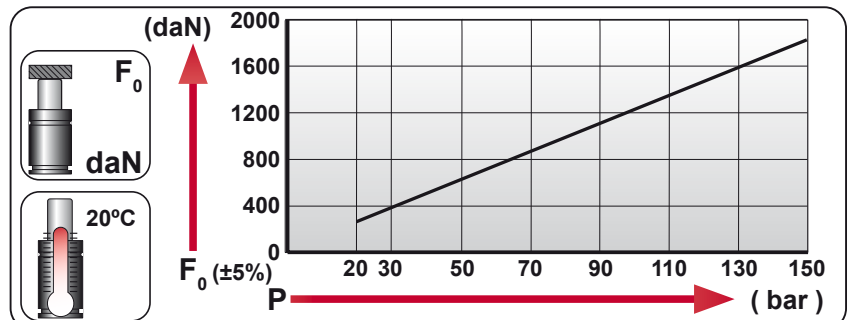

CODE	Image	Pressure		Force	
		bar	psi	daN	daN
CS 1800 050 V2		150	2175	1885	3010
CS-ER 1800 050 V2		0	0	---	---

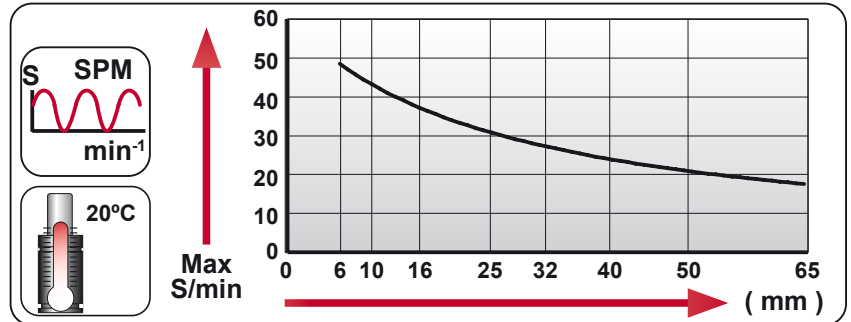
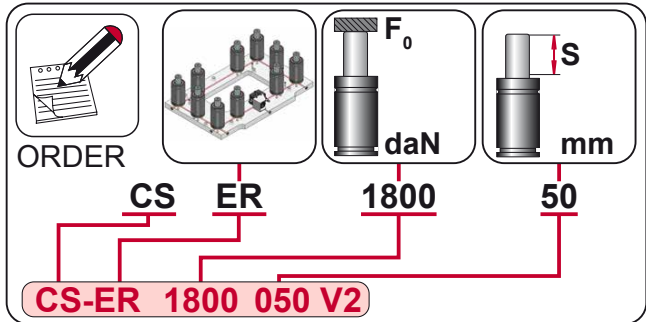
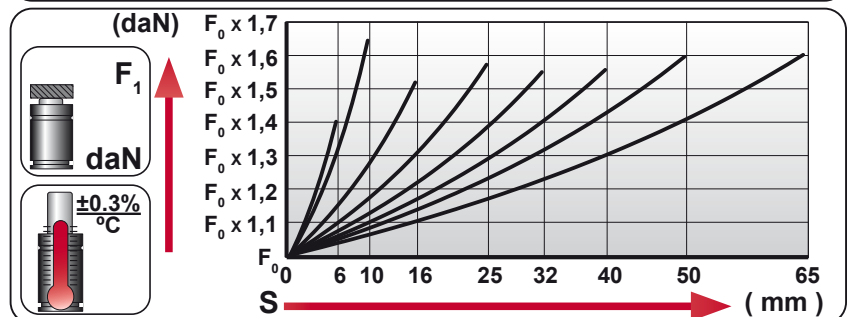

N ₂	Smax < 90%	Vmax 0,5 m/s	bar psi 20 290	bar psi 150 2175	°C °F 0 32	°C °F 80 176	600 CP_ _-ER

AZOL GAS CS-ER 3000 V3

Power Compact Stroke

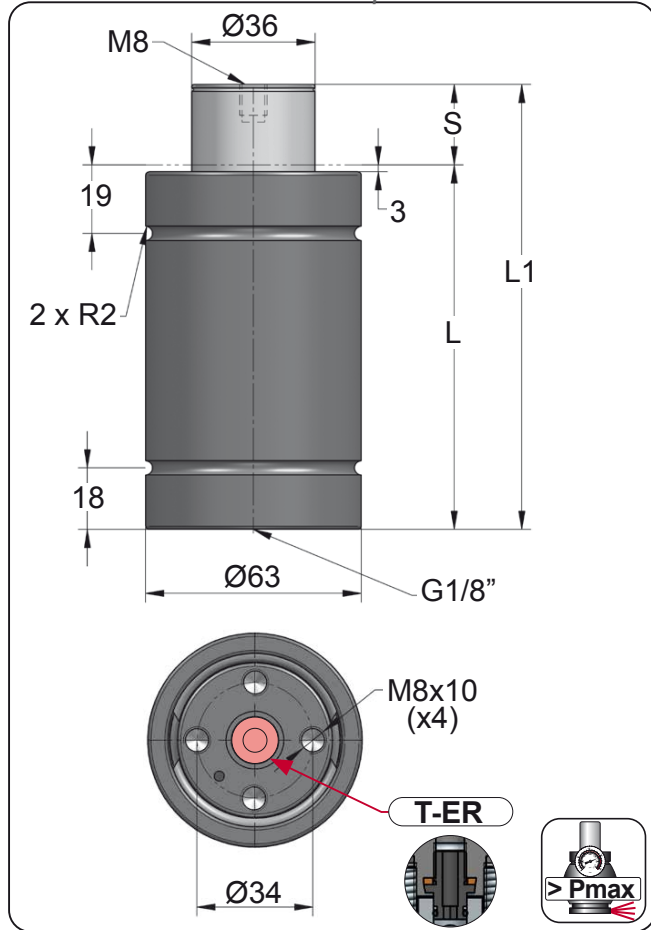

ORDER	S (mm)	L1 ±0,25 (mm)	L (mm)	Kg.
CS-ER 3000 010 V3	10	85	75	1.34
CS-ER 3000 016 V3	16	103	87	1.48
CS-ER 3000 025 V3	25	130	105	1.68
CS-ER 3000 032 V3	32	150	118	1.83
CS-ER 3000 040 V3	40	175	135	2.02
CS-ER 3000 050 V3	50	205	155	2.24
CS-ER 3000 065 V3	65	256	191	2.64

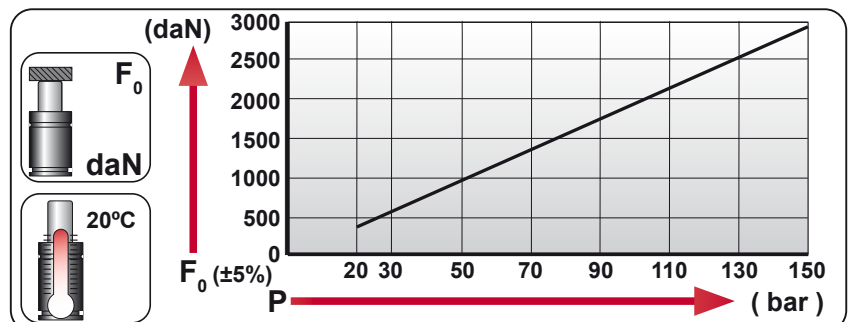

CODE	Image	Pressure		Force	
		bar	psi	daN	daN
CS 3000 050 V3		150	2175	2945	5265
CS-ER 3000 050 V3		0	0	---	---

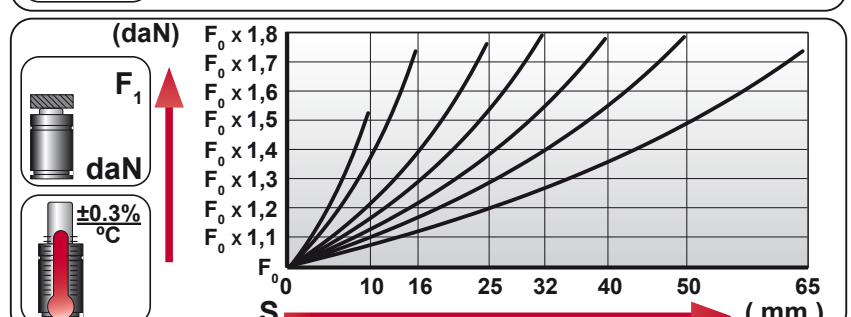

ORDER: CS ER 3000 50

CS-ER 3000 050 V3

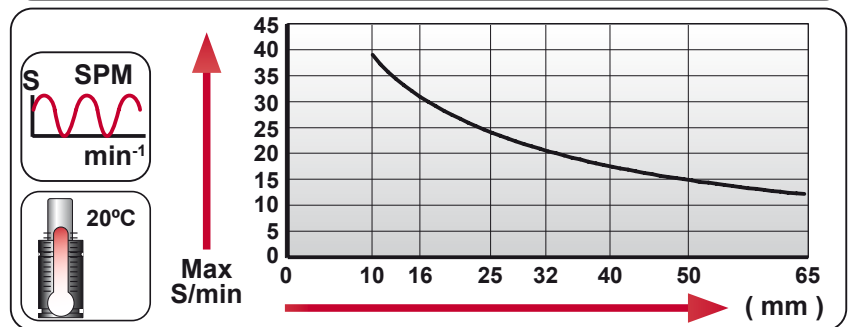

N ₂	Smax < 90%	Vmax 0,5 m/s	bar psi 20 290	bar psi 150 2175	°C °F 0 32	°C °F 80 176	600 CP_ _-ER

CS-ER 4700 V1

Power Compact Stroke

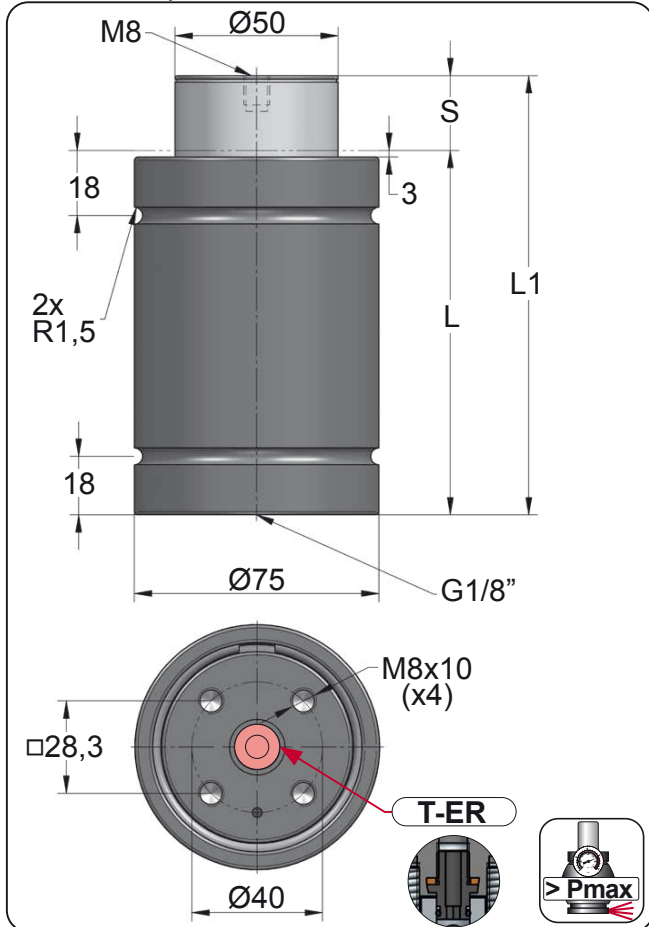

ORDER	S (mm)	L1 ±0,25 (mm)	L (mm)	Kg.
CS-ER 4700 010 V1	10	80	70	1.74
CS-ER 4700 016 V1	16	106	90	2.00
CS-ER 4700 025 V1	25	135	110	2.30
CS-ER 4700 032 V1	32	167	135	2.62
CS-ER 4700 040 V1	40	200	160	2.95
CS-ER 4700 050 V1	50	240	190	3.36
CS-ER 4700 065 V1	65	273	208	3.69



CODE	Image	Pressure		Force	
		bar	psi	daN	daN
CS 4700 050 V1		150	2175	4675	6970
CS-ER 4700 050 V1		0	0	---	---

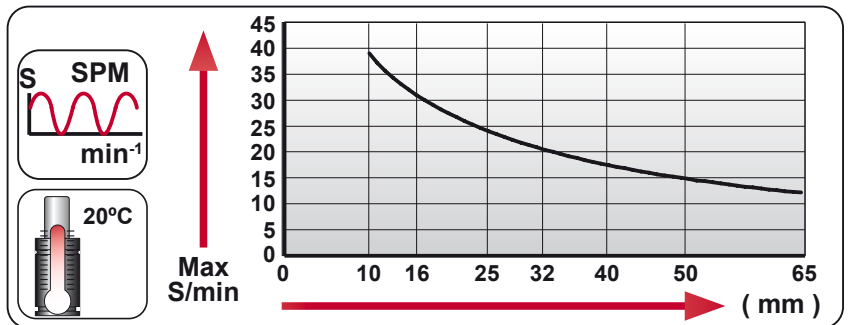
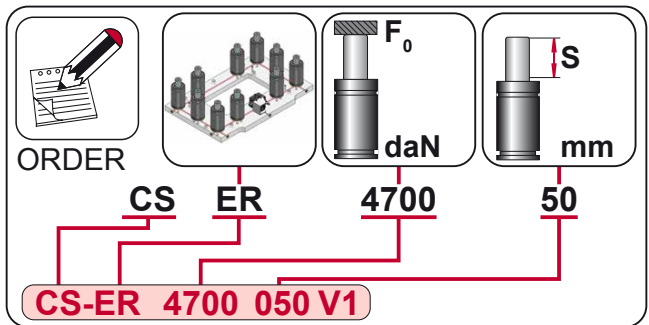
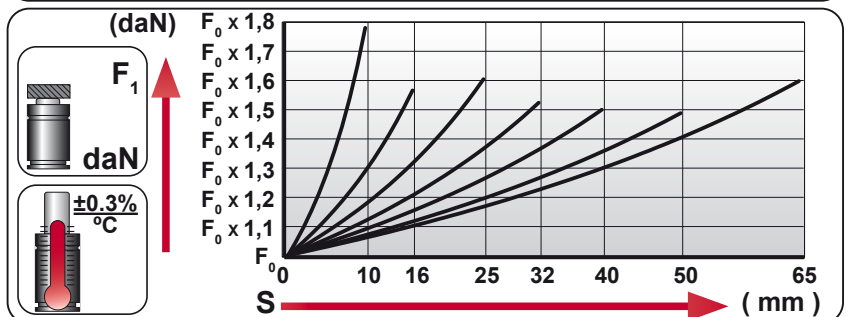
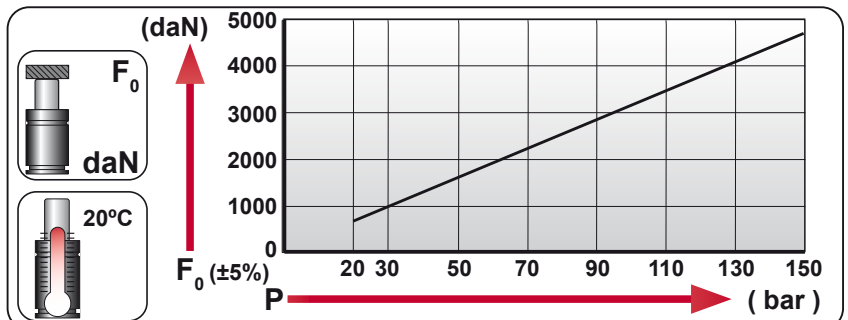

N ₂	Smax < 90%	Vmax 0,5 m/s	bar psi 20 290	bar psi 150 2175	°C °F 0 32	°C °F 80 176	600 CP_ _-ER

AZOL GAS

CS-ER 7500 V1

Compact Height

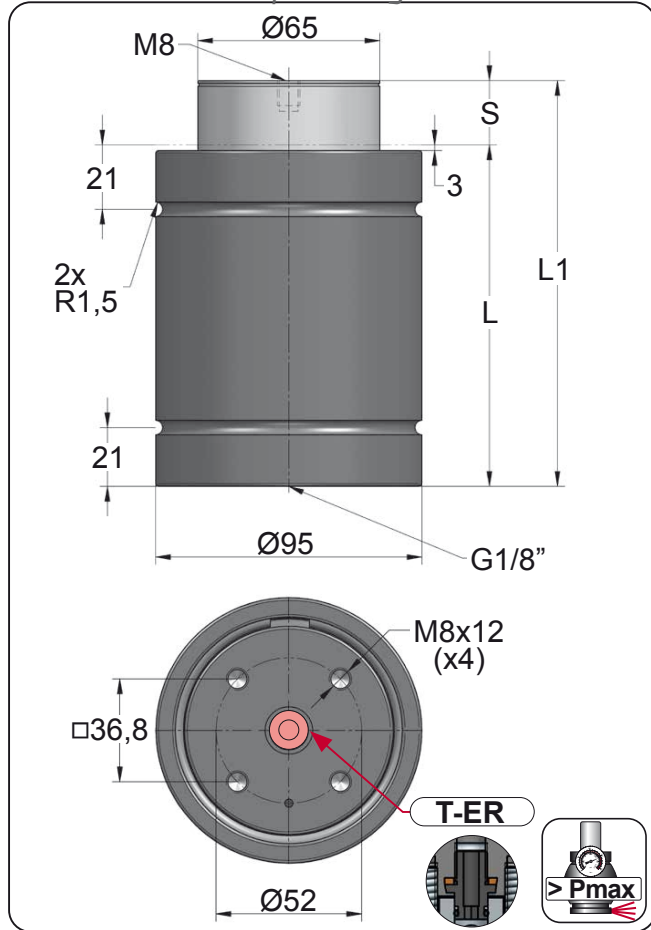

ORDER	S (mm)	L1 ±0,25 (mm)	L (mm)	Kg.
CS-ER 7500 010 V1	10	90	80	3.21
CS-ER 7500 016 V1	16	116	100	3.61
CS-ER 7500 025 V1	25	145	120	4.06
CS-ER 7500 032 V1	32	182	150	4.64
CS-ER 7500 040 V1	40	210	170	5.07
CS-ER 7500 050 V1	50	255	205	5.77
CS-ER 7500 065 V1	65	279	214	6.12

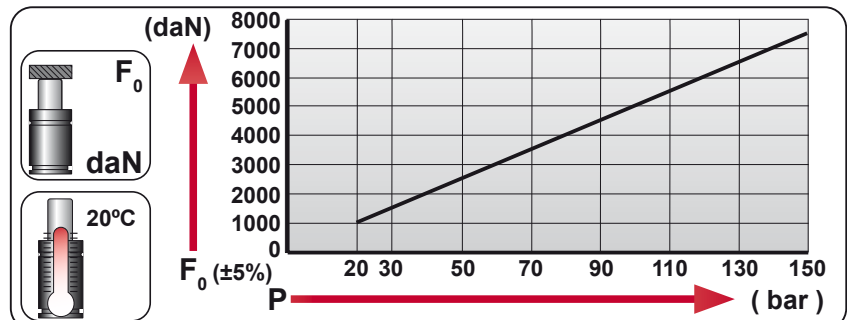

CODE	Image	Pressure		Force	
		bar	psi	daN	daN
CS 7500 050 V1		150	2175	7540	10790
CS-ER 7500 050 V1		0	0	---	---

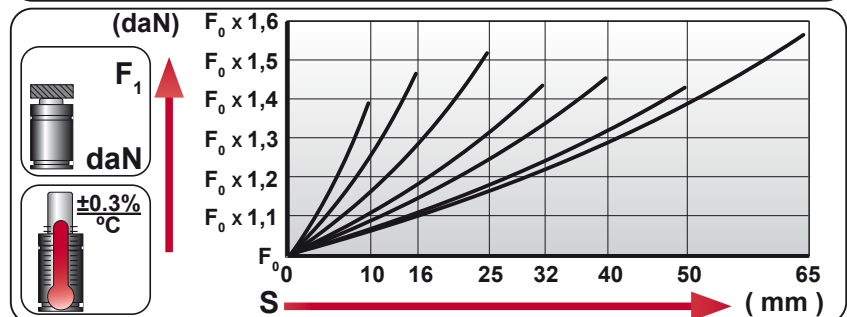

ORDER: CS ER 7500 50

CS-ER 7500 050 V1

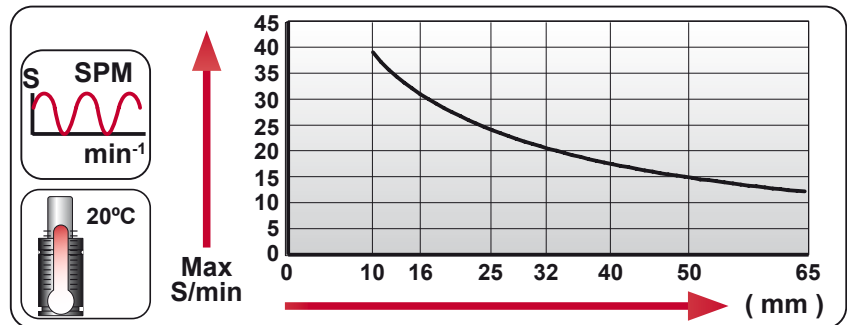

N ₂	S _{max} < 90%	V _{max} 0,5 m/s	bar psi 20 290	bar psi 150 2175	°C °F 0 32	°C °F 80 176	600 CP_ _-ER

CS-ER 11800 V1

Power Compact Stroke

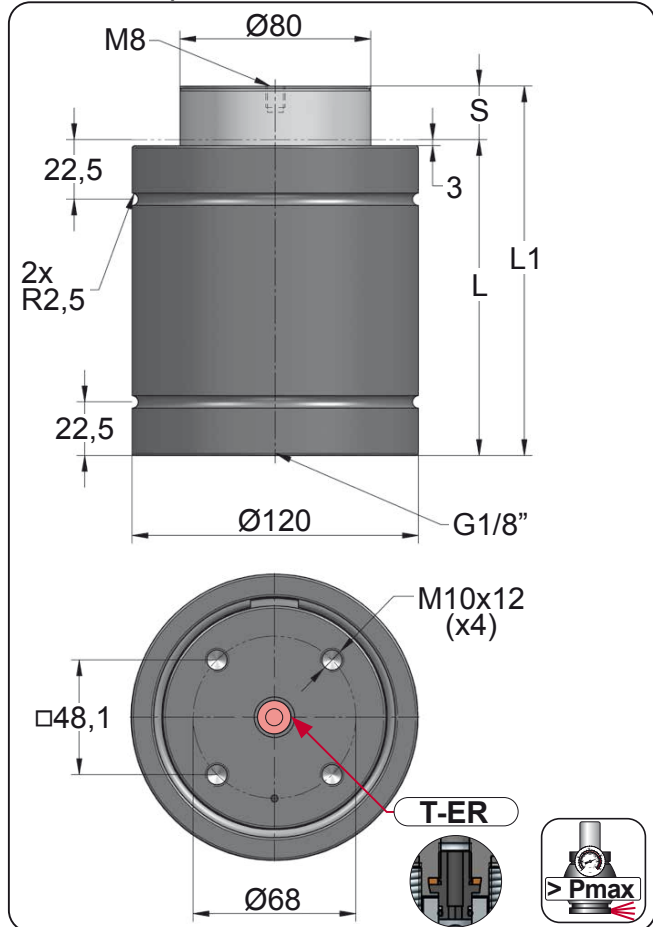

ORDER	S (mm)	L1 ±0,25 (mm)	L (mm)	Kg.
CS-ER 11800 010 V1	10	100	90	5.79
CS-ER 11800 016 V1	16	126	110	6.46
CS-ER 11800 025 V1	25	155	130	7.19
CS-ER 11800 032 V1	32	187	155	8.01
CS-ER 11800 040 V1	40	220	180	8.86
CS-ER 11800 050 V1	50	260	210	9.88
CS-ER 11800 065 V1	65	320	255	11.41



CODE	Image	Pressure		Force	
		bar	psi	daN	daN
CS 11800 050 V1		150	2175	11780	16935
CS-ER 11800 050 V1		0	0	---	---

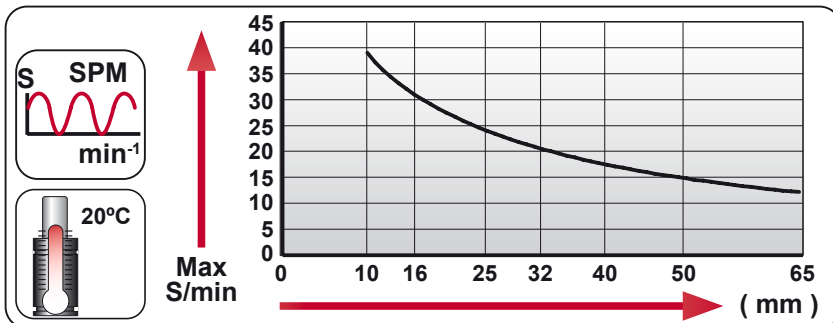
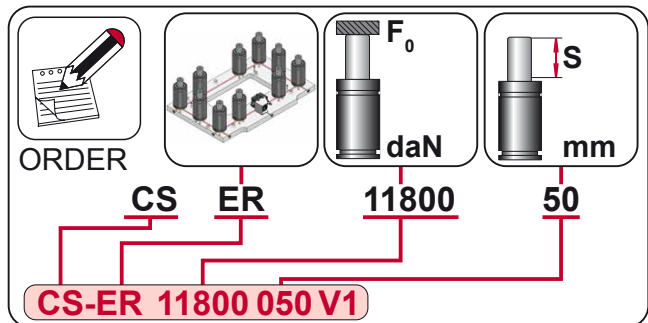
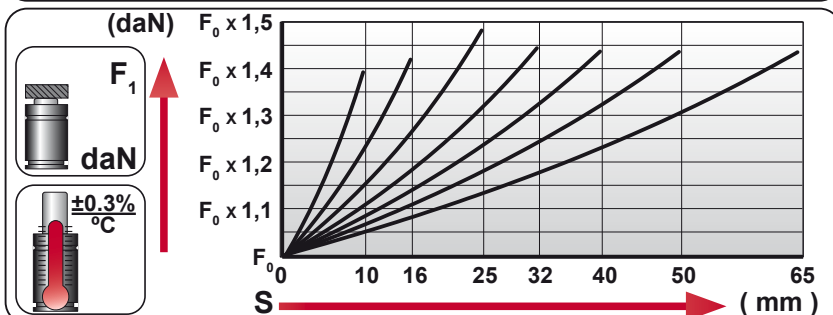
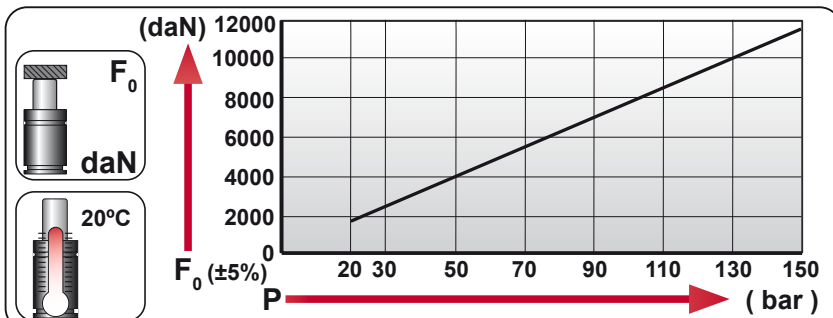

N ₂	Smax < 90%	Vmax 0,5 m/s	bar psi 20 290	bar psi 150 2175	°C °F 0 32	°C °F 80 176	600 CP_ _-ER

AZOL GAS CS-ER 18300 V1

Compact Height

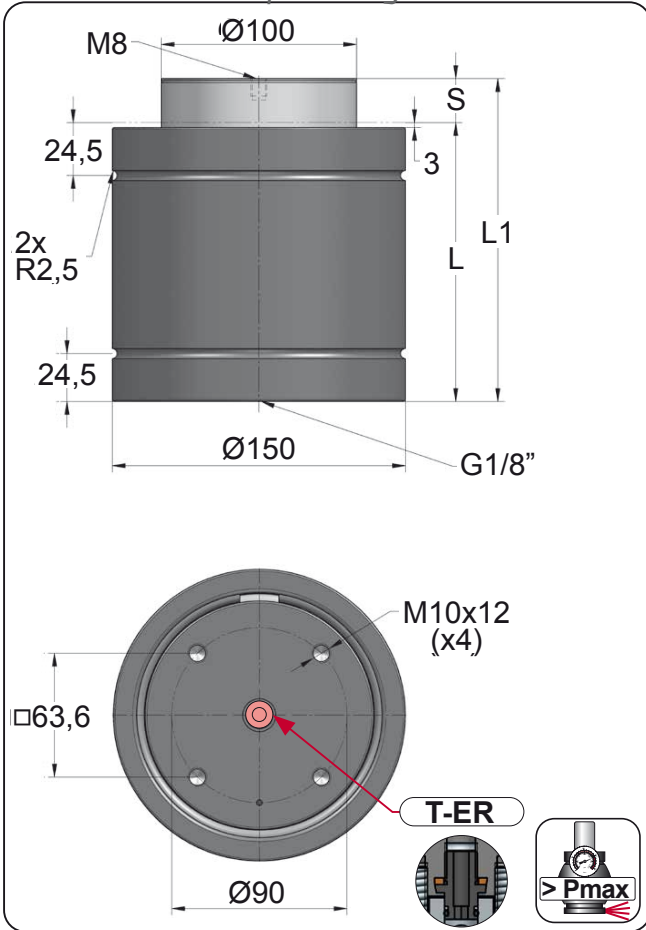

ORDER	S (mm)	L1 ±0,25 (mm)	L (mm)	Kg.
CS-ER 18300 010 V1	10	110	100	9.69
CS-ER 18300 016 V1	16	136	120	10.70
CS-ER 18300 025 V1	25	165	140	11.79
CS-ER 18300 032 V1	32	197	165	13.04
CS-ER 18300 040 V1	40	235	195	14.53
CS-ER 18300 050 V1	50	270	220	15.86
CS-ER 18300 065 V1	65	323	258	17.87



CODE	Image	bar	psi	F ₀ daN	F ₁ daN
CS 18300 050 V1		150	2175	18410	25795
CS-ER 18300 050 V1		0	0	---	---

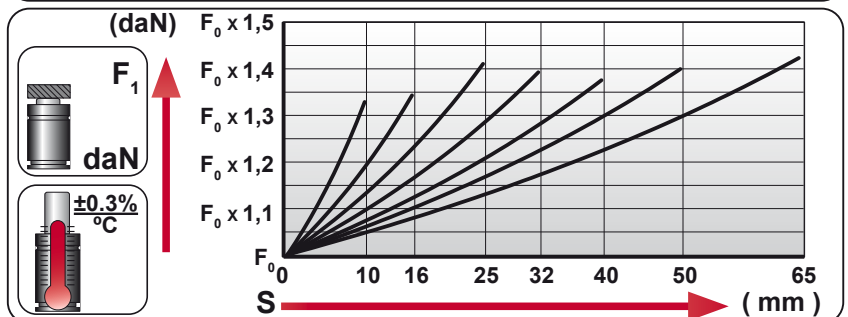
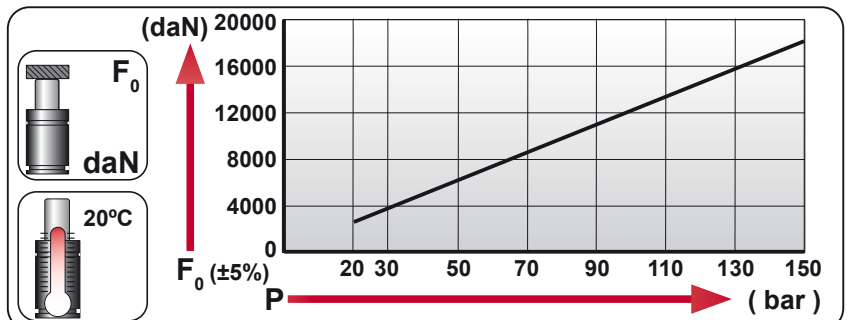

ORDER: CS ER 18300 50

CS-ER 18300 050 V1

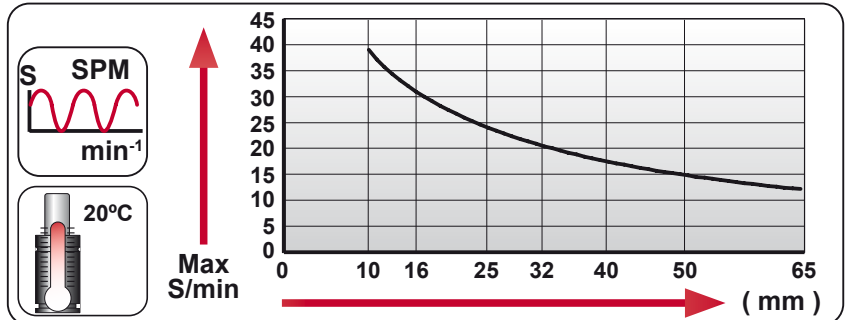

N ₂	S _{max} < 90%	V _{max} 0,5 m/s	bar psi 20 290	bar psi 150 2175	°C °F 0 32	°C °F 80 176	600 CP_ _-ER

EASY & READY MANIFOLD



CONTROL PANELS STANDARD MOUNT

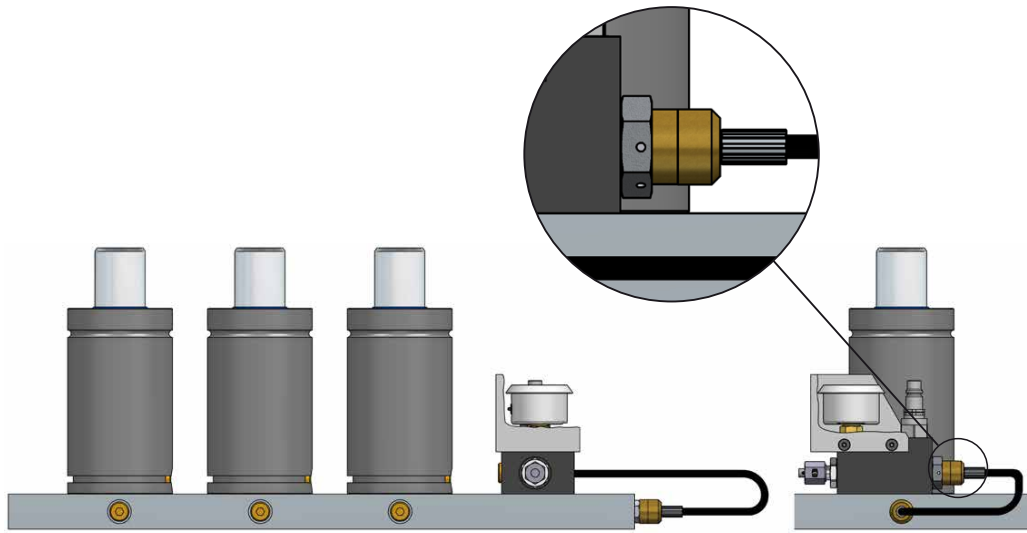

ORDER
600-CPGM 05 V1

CONTROL PANELS SIDE MOUNT

SQUARE SEAL J-ER-6

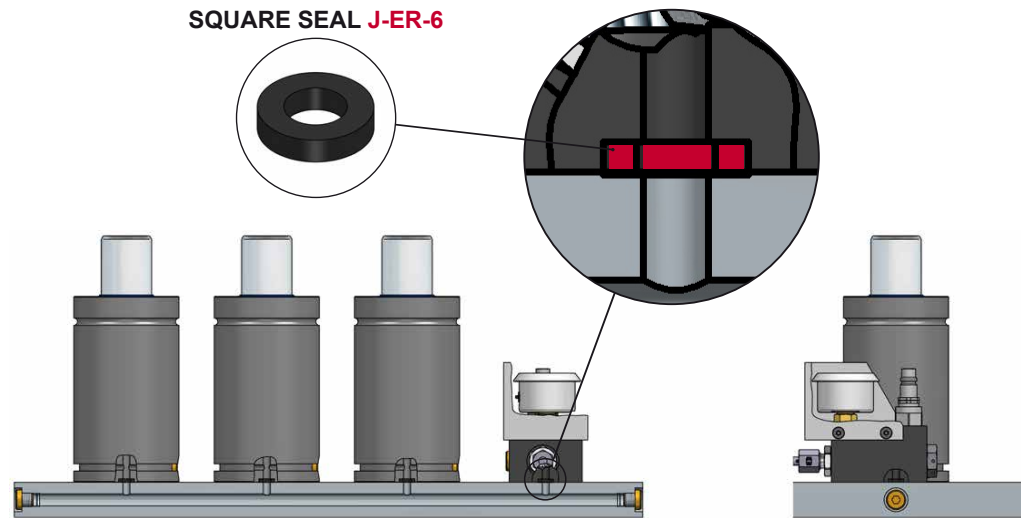
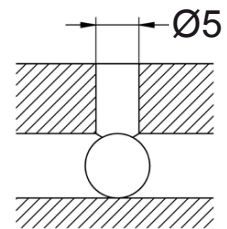

PLATE HOLE PATTERN



ORDER
600-CPGM-ER-S 05 V1

-ER control panels are supplied with the corresponding seal J-ER-6

CONTROL PANELS FRONT MOUNT

SQUARE SEAL J-ER-6

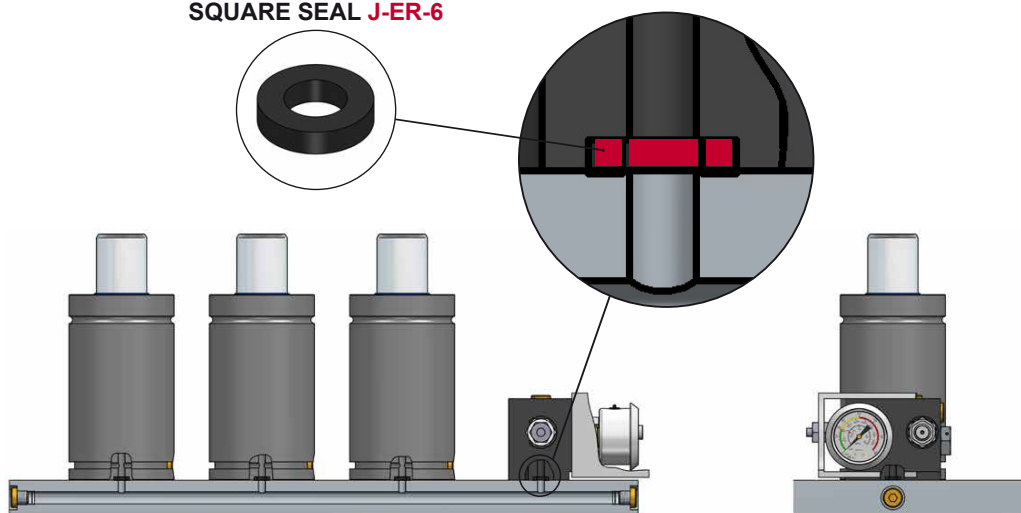
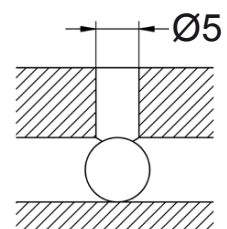

PLATE HOLE PATTERN



ORDER
600-CPGM-ER-F 05 V1

-ER control panels are supplied with the corresponding seal J-ER-6



EASY & READY MANIFOLD

600-CPGM-ER 05 V1

ER-S

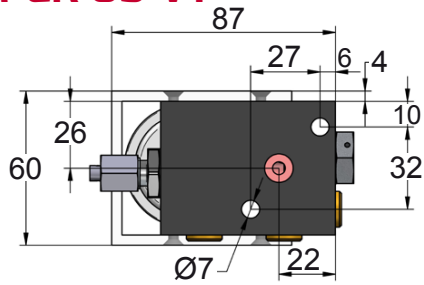

ER-F

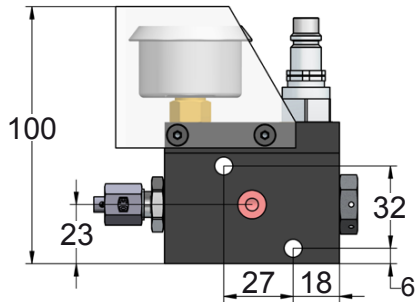

600-CPGM-ER-S 05 V1

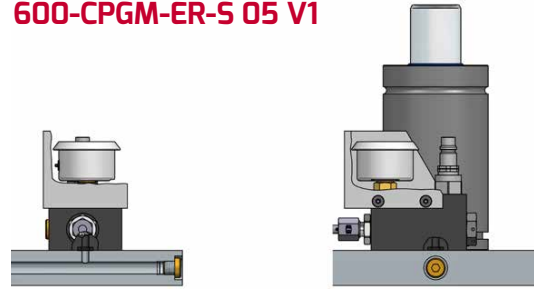

600-CPGM-ER-F 05 V1

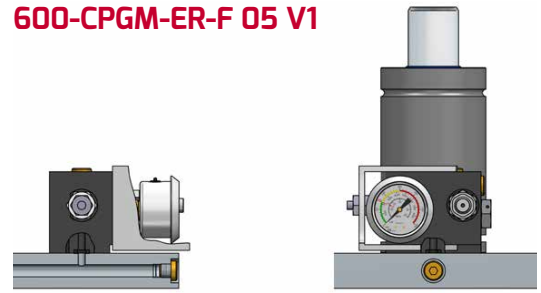

G1/8" MINIMESS (Ø5)

Hosed Systems



SGS

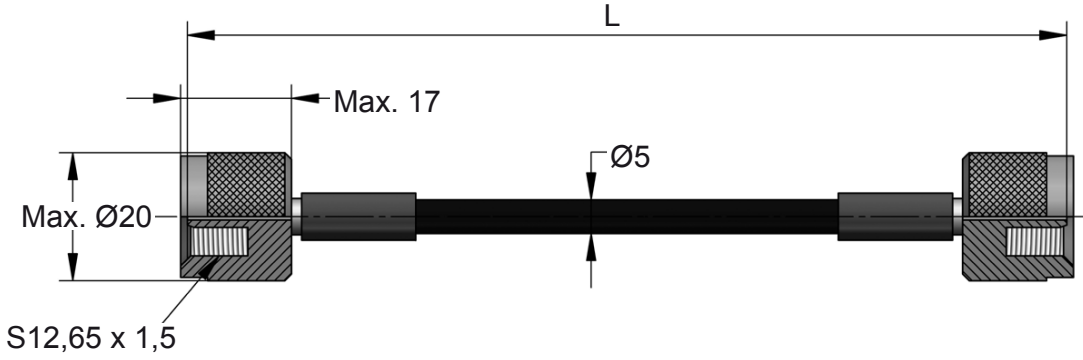

ORDER	L ⁺⁵ ₋₀ (mm)
SGS 200	200
SGS 300	300
SGS 400	400
SGS 500	500
SGS 630	630
SGS 800	800
SGS 1000	1000
SGS 1200	1200
SGS 1250	1250
SGS 1500	1500
SGS 2000	2000
SGS 2500	2500
SGS 3000	3000



ENG	ORDER
DEU	BESTELL
FRA	COMMANDE
ITA	ORDINE
ESP	PEDIDO
POR	PEDIDO



EM.24.54.700
90.25
W-DX35-72
SMS DNH 3217n

RGS

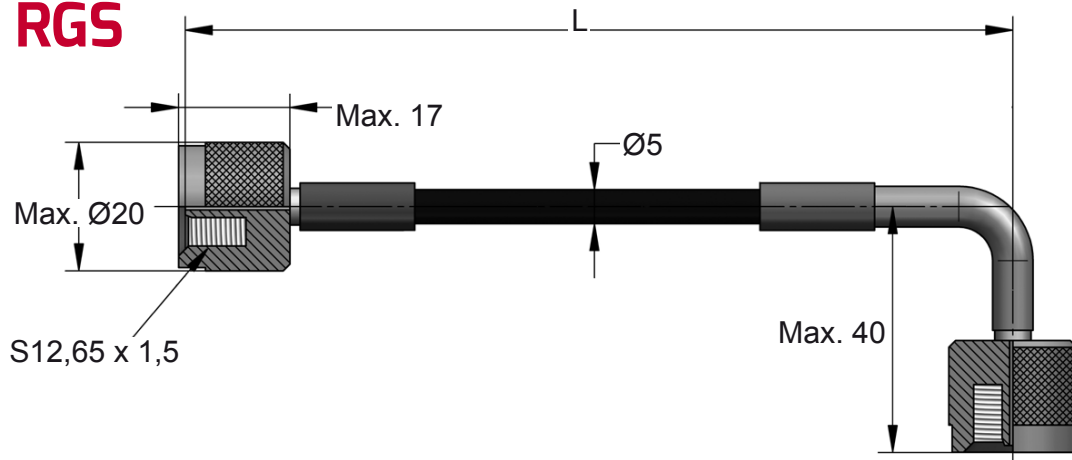

ORDER	L ⁺⁵ ₋₀ (mm)
RGS 200	200
RGS 300	300
RGS 400	400
RGS 500	500
RGS 630	630
RGS 800	800
RGS 1000	1000
RGS 1200	1200
RGS 1250	1250
RGS 1500	1500
RGS 2000	2000
RGS 2500	2500
RGS 3000	3000



ENG	ORDER
DEU	BESTELL
FRA	COMMANDE
ITA	ORDINE
ESP	PEDIDO
POR	PEDIDO

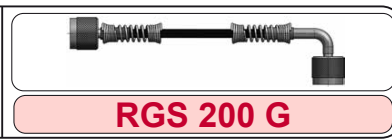
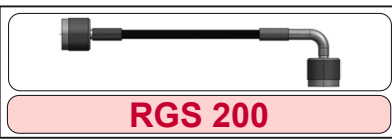

PGS

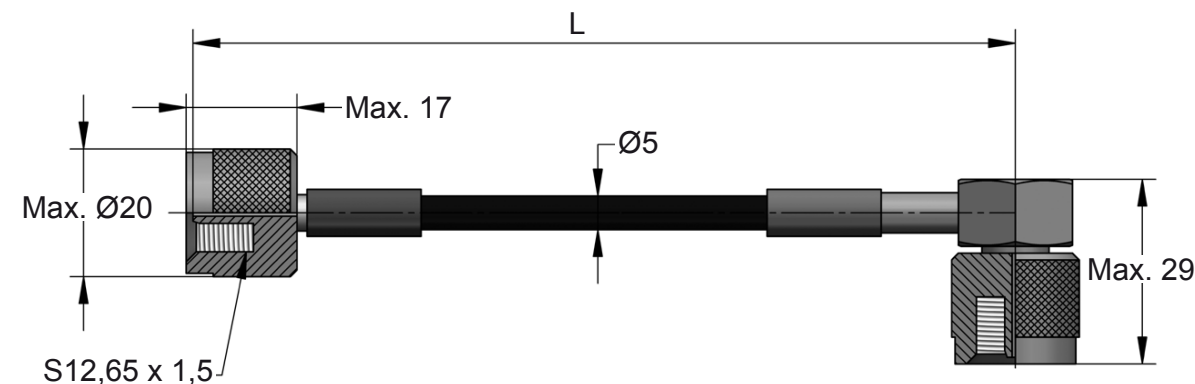

ORDER	L ⁺⁵ ₋₀ (mm)
PGS 200	200
PGS 300	300
PGS 400	400
PGS 500	500
PGS 630	630
PGS 800	800
PGS 1000	1000
PGS 1200	1200
PGS 1250	1250
PGS 1500	1500
PGS 2000	2000
PGS 2500	2500
PGS 3000	3000



ENG	ORDER
DEU	BESTELL
FRA	COMMANDE
ITA	ORDINE
ESP	PEDIDO
POR	PEDIDO

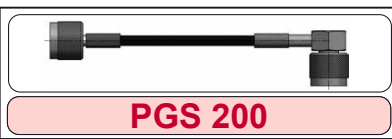

EM.24.54.700
90.25
W-DX35-72
SMS DNH 3217n



G1/8" MINIMESS (Ø5)

Hosed Systems

RGR

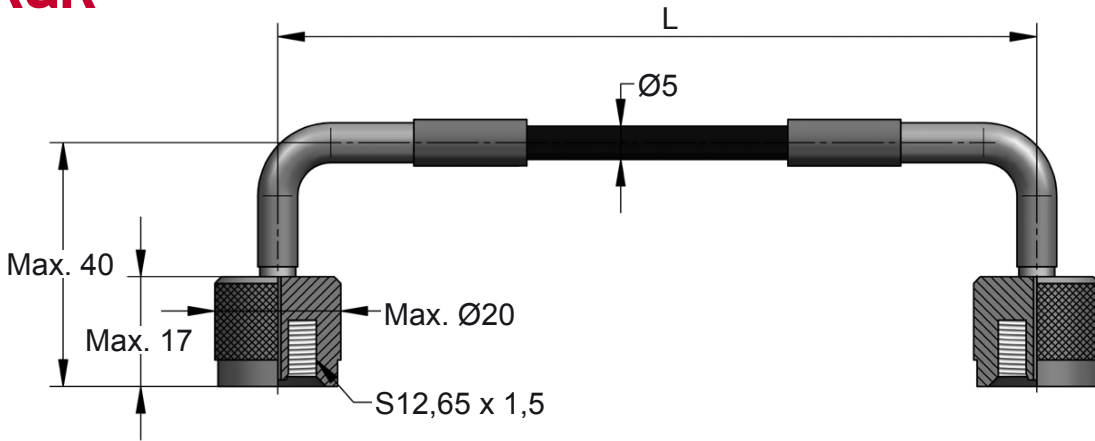

ORDER	L ⁺⁵ ₋₀ (mm)
RGR 200	200
RGR 300	300
RGR 400	400
RGR 500	500
RGR 630	630
RGR 800	800
RGR 1000	1000
RGR 1200	1200
RGR 1250	1250
RGR 1500	1500
RGR 2000	2000
RGR 2500	2500
RGR 3000	3000



ENG	ORDER
DEU	BESTELL
FRA	COMMANDE
ITA	ORDINE
ESP	PEDIDO
POR	PEDIDO

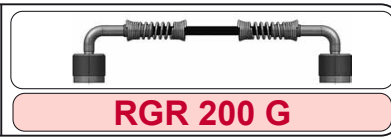

PGP

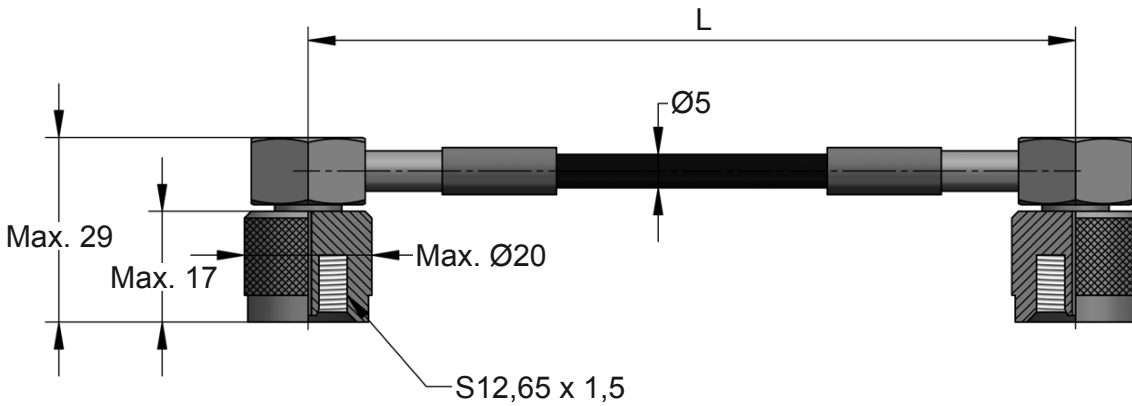

ORDER	L ⁺⁵ ₋₀ (mm)
PGP 200	200
PGP 300	300
PGP 400	400
PGP 500	500
PGP 630	630
PGP 800	800
PGP 1000	1000
PGP 1200	1200
PGP 1250	1250
PGP 1500	1500
PGP 2000	2000
PGP 2500	2500
PGP 3000	3000



ENG	ORDER
DEU	BESTELL
FRA	COMMANDE
ITA	ORDINE
ESP	PEDIDO
POR	PEDIDO

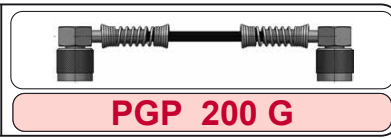
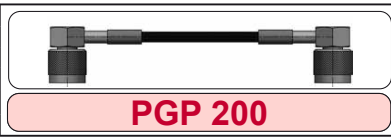

EM.24.54.700
90.25
W-DX35-72
SMS DNH 3217n

GST

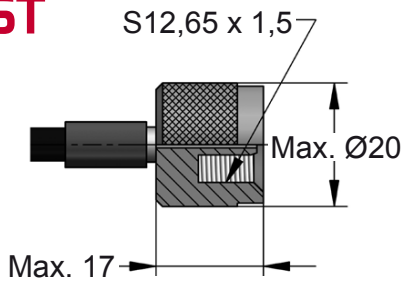

GPT

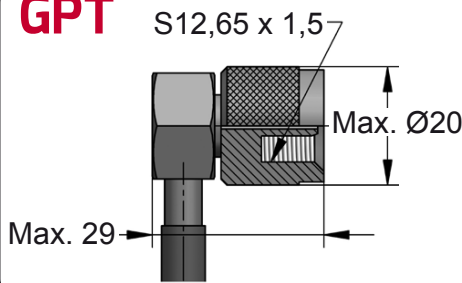

GRT

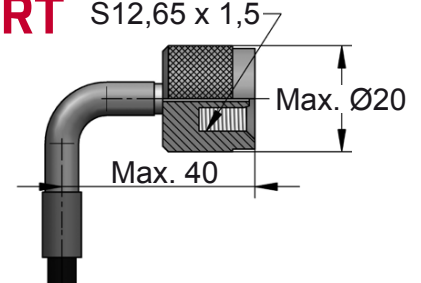

GF 02



SKK 12R 1/8

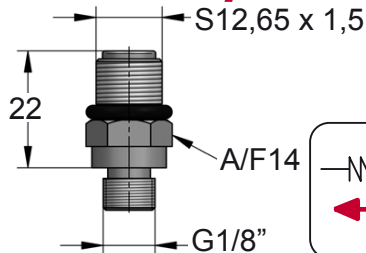

SKK 12R 1/4

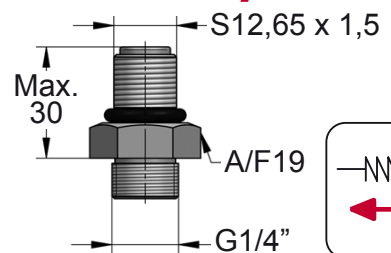

Pmax
630 bar

Tmax
100 °C

Rmin
20 mm

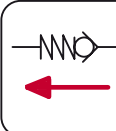
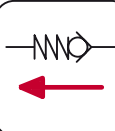

EASY & READY MANIFOLD



Gas springs maintenance must be carried out only by skilled personnel, with the appropriate training, and always following the operating and service instructions from Azolgas.

Never handle a gas spring without being sure that it is completely discharged and you know how to proceed to drain it. When discharging a gas spring point the gas flow away from operator or anybody else. Use the appropriate tools and equipment when handling gas springs.

Charge only with NITROGEN (N₂). Never fill a gas spring when the piston rod is not fully extended.

Charge the gas spring between the minimum and the maximum allowable pressure, at a 20°C temperature. Respect the limits of the operating temperature.

Do not exceed the maximum allowed stroke speed. Maximum allowed cycles per minute should never be exceeded.

Avoid freely release of the piston rod, this would cause damages to the gas spring. Do not check the force of gas springs by using whatever impact on piston rod.

Maximum recommended stroke 90%. Minimum stroke reserve: up to stroke 50mm (10%), over stroke 50 mm (5 mm). Overstroke >100% would cause damages to the cylinder and serious risks.

Gas springs must always work completely perpendicular to the contact surface. Side loads increase wearing and reduce life expectancy.



EASY & READY MANIFOLD

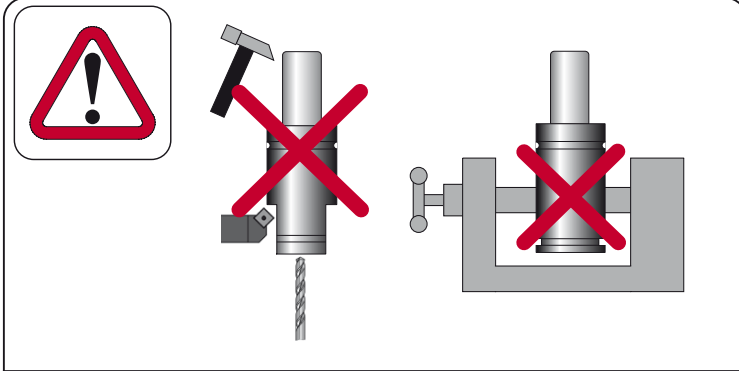

Avoid whatever impact and do not make any mechanical work on the gas spring body or piston rod.

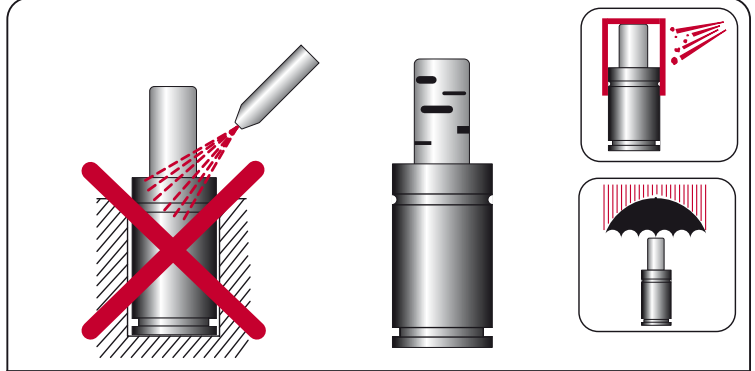

Protect the gas springs from solid or liquid contaminants.

Gas springs with scratches on the piston rod surface should be replaced.

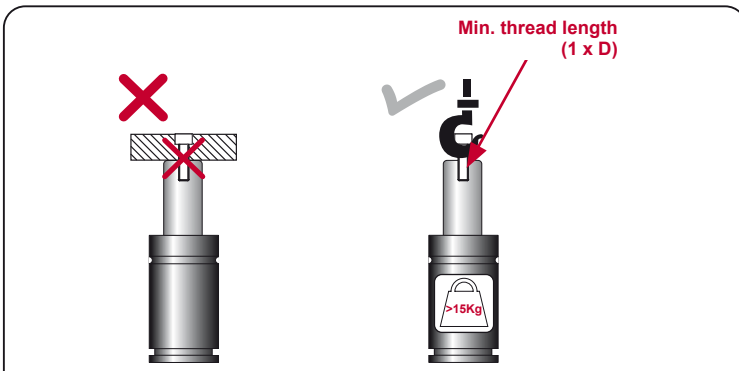

The base should be supported at all the times. A flat surface against the base is always required. Do not use the rod threaded hole for fixing the gas spring into the tool. This hole is only to be used for maintenance operations or transport. (Gas springs heavier than 15 kgs are marked according to VDI).



Designed and manufactured according PED 2014/68/EU. The user of gas springs is responsible for installation and future inspections to be made to the springs in accordance with the regulations of the country where they will be used. Azolgas recommend to replace gas springs after 2 million strokes/10 years.

WARNING: -ER GAS SPRINGS MANIPULATION

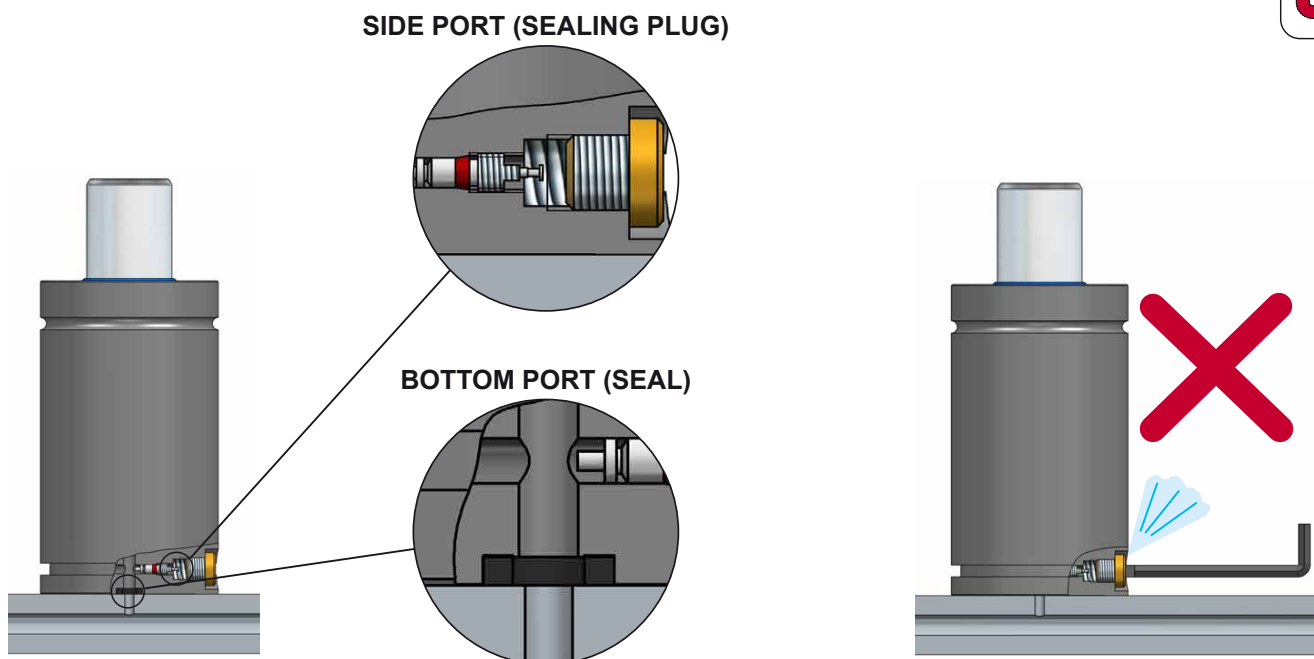

-ER gas springs are supplied with 2 N₂ gas ports (side port / bottom port), NEVER disassemble the sealing plug from the side port.

-ER gas springs charging and discharging operations must be done through the control panel.



Landalucía 7, P.I. Júndiz
01015 Vitoria-Gasteiz
Tel.: +34 945 290 010
Fax: +34 945 290 381

azolgas@azolgas.com
www.azolgas.com